

06

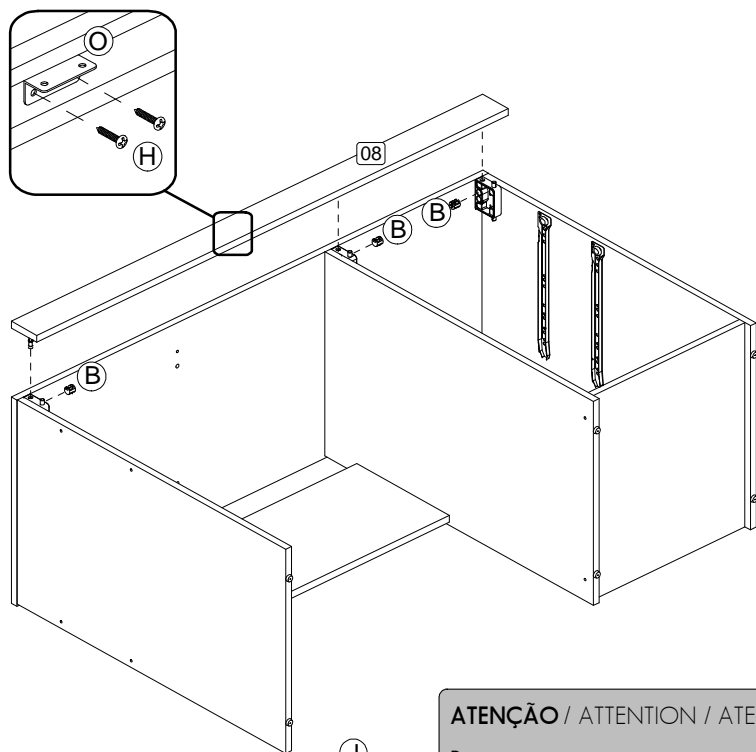

07 (2x)

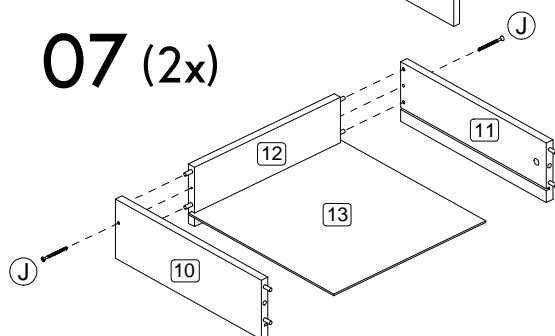

08 (2x)

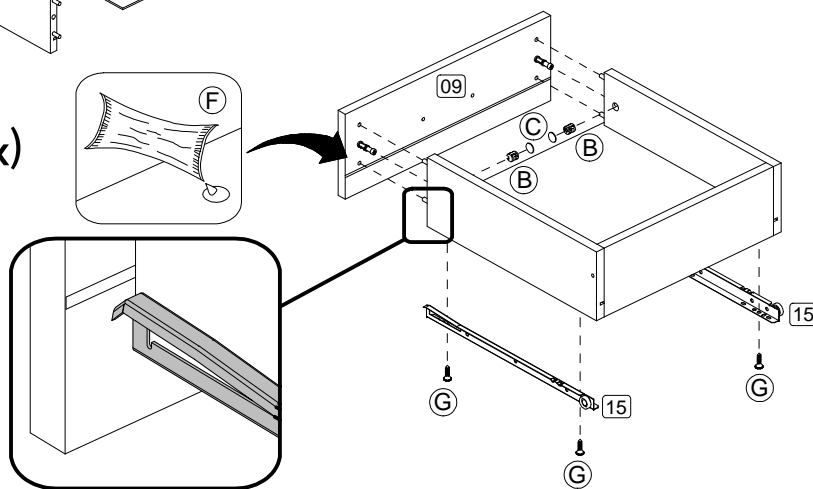
**ATENÇÃO / ATTENTION / ATENCIÓN**

Para remover os números impressos nas peças, utilize um pano umedecido em álcool.

To remove the printed numbers on the pieces, use a cloth moistened with alcohol.

Para remover los números impresos en las piezas, utilice un paño humedecido con alcohol.

MESA MALTA - 2 GAVETAS

Office table **Malta** - 2 drawers
Escritório **Malta** - 2 cajones

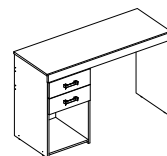

Gavetas na esquerda
Drawers on the left
Cajones a la izquierda

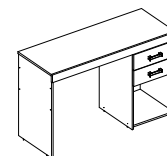

Gavetas na direita
Drawers on the right
Cajones a la derecha

Código **1171** | Revisão **09****Você vai precisar de:**

You will need / Usted necesitará

**Ferramentas não incluídas**

Tools not included / Herramientas no incluidas

A		13
B		13
C		05
D		16
E		14
F		01
G		16
H		10
I		04
J		04
K		08
L		01
M		06
N		06
O		01
P		02
Q		02

R		06
S		04
T		06

Este produto possui instruções em vídeo para lhe auxiliar na montagem dos acessórios. Acesse o nosso site ou utilize o QR code ao lado para obter mais informações.



This product has video instructions to help you in the assembly of accessories. Visit our website or use the QR code to get more information.

Este producto tiene instrucciones en vídeo para ayudarle en el armado de accesorios. Visite nuestro sitio web o utilice el código QR para obtener más informaciones.

Caso você ainda considere necessária a contratação de um montador, consulte o nosso site. Temos profissionais capacitados para lhe indicar nas principais cidades do Brasil.
Service only available in Brazil. / Servicio disponible sólo en Brasil.

+55 (54) 3458-1300 / sac@politorno.com.br
www.politorno.com.br

MANUAL DE MONTAGEM
Assembly instructions / Instrucciones de armado

Politorno
Móveis

MONTAGEM DAS GAVETAS PARA A ESQUERDA
MONTAJE DE LOS CAJONES A LA IZQUIERDA
ASSEMBLY OF THE DRAWERS ON THE LEFT

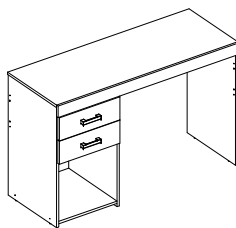

ANTES DE INICIAR A MONTAGEM, IDENTIFIQUE TODAS AS PEÇAS E ACESSÓRIOS.
ANTES DE EMPEZAR EL ARMADO, IDENTIFIQUE TODAS LAS PIEZAS Y ACCESORIOS.
BEFORE STARTING THE ASSEMBLY, IDENTIFY ALL PARTS AND ACCESSORIES.

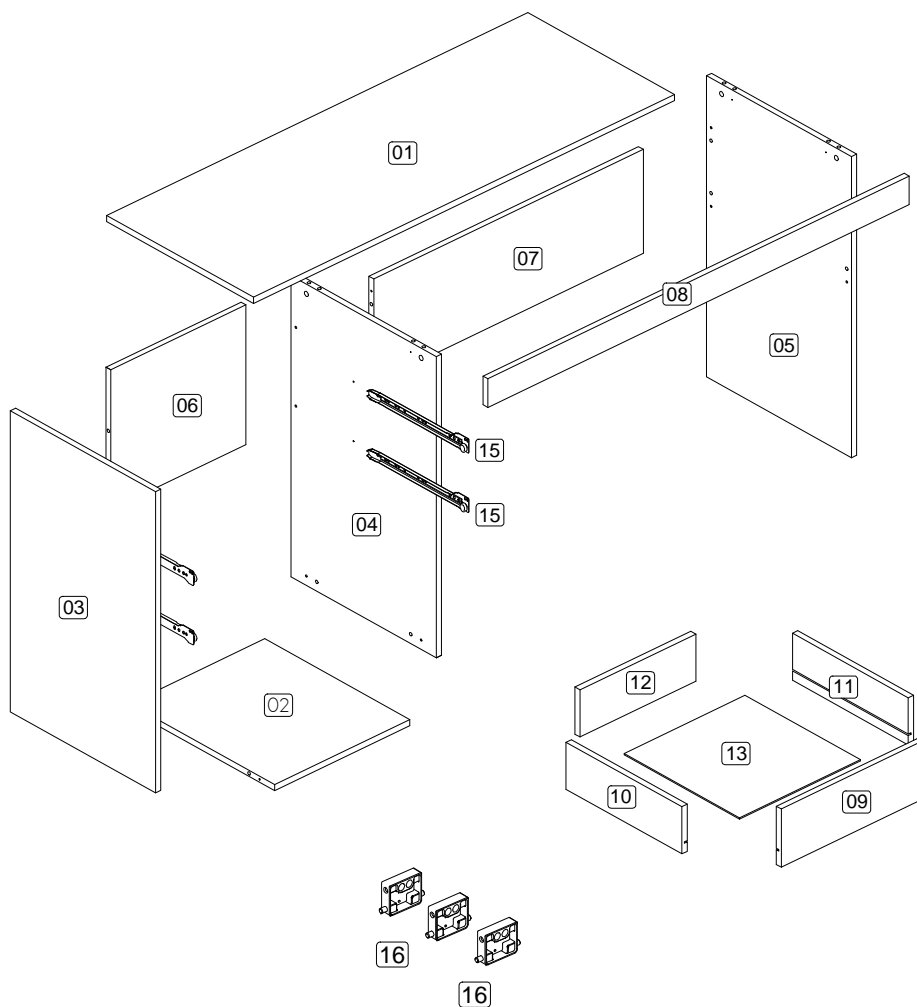

04

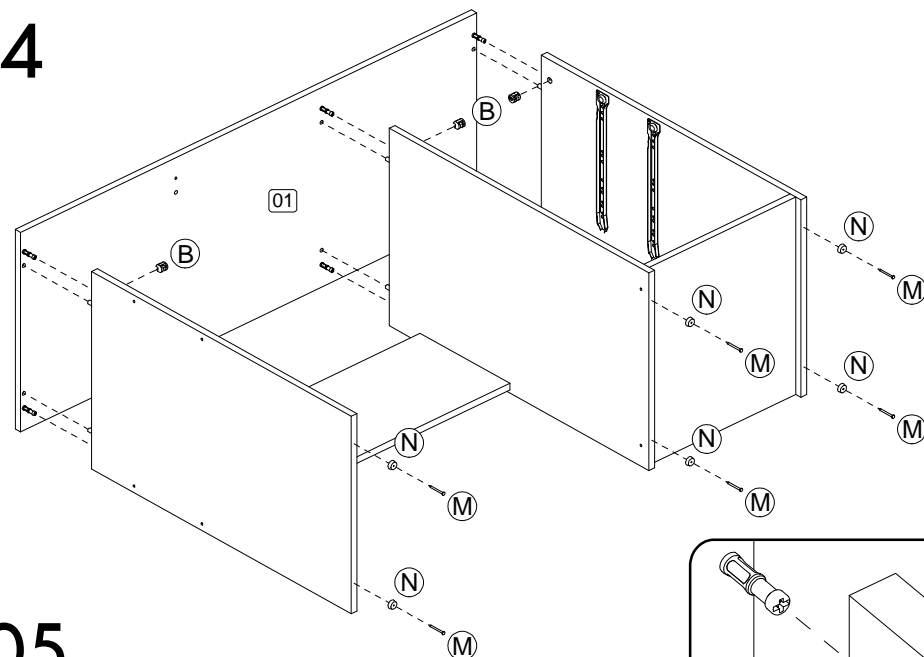

05

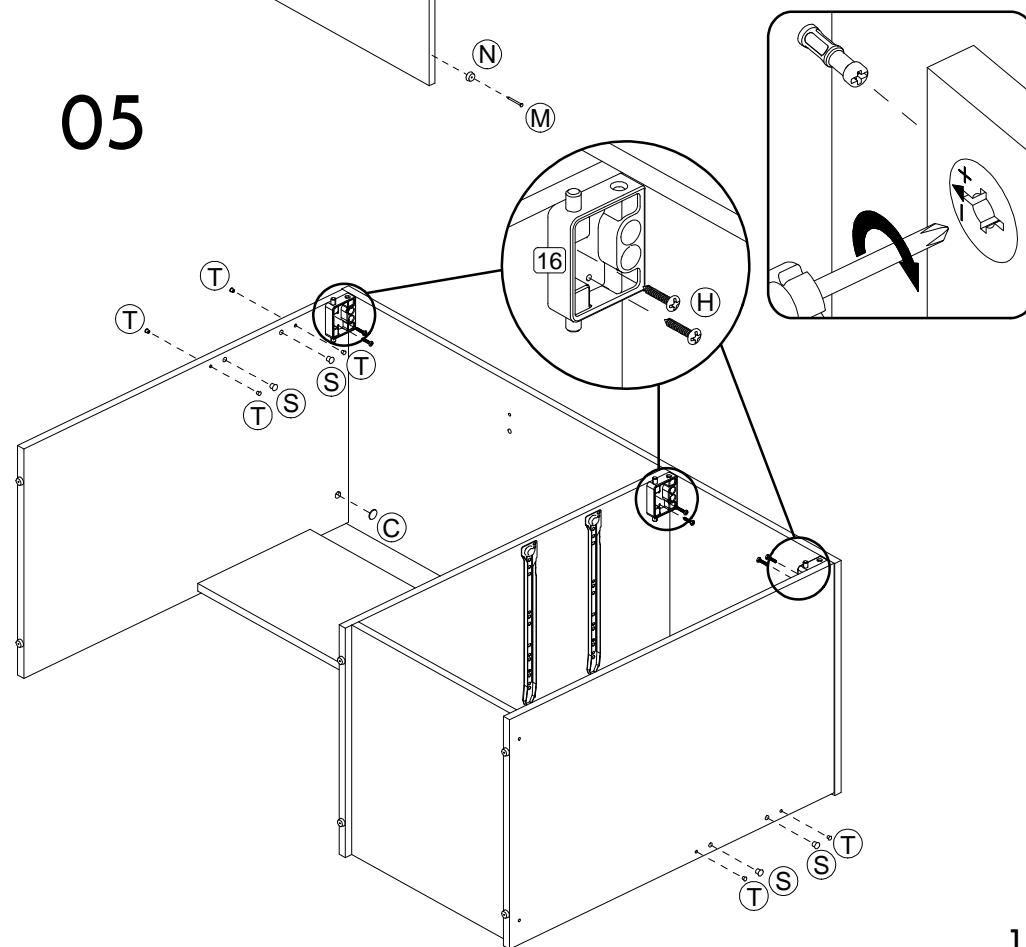

01

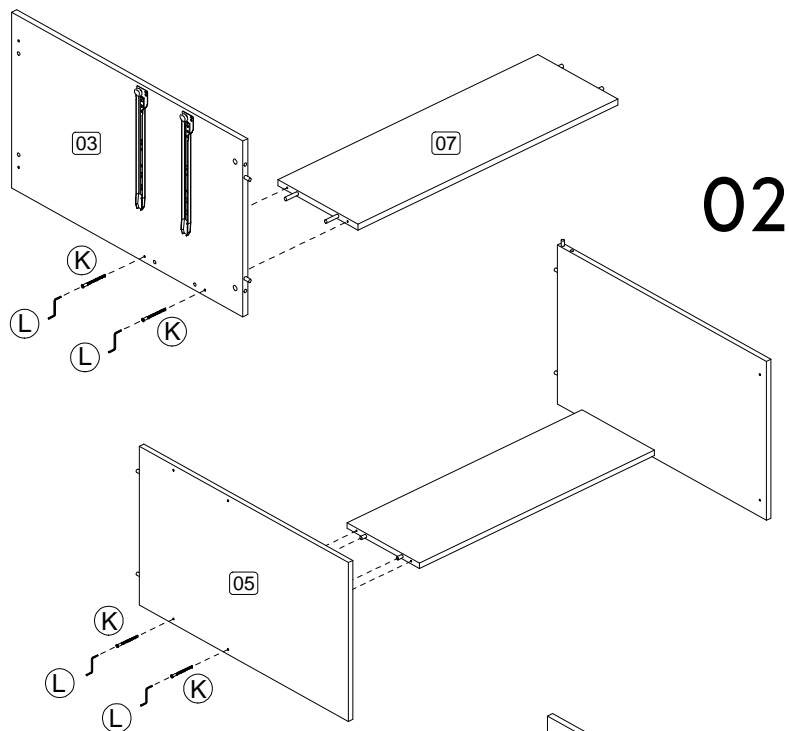

02

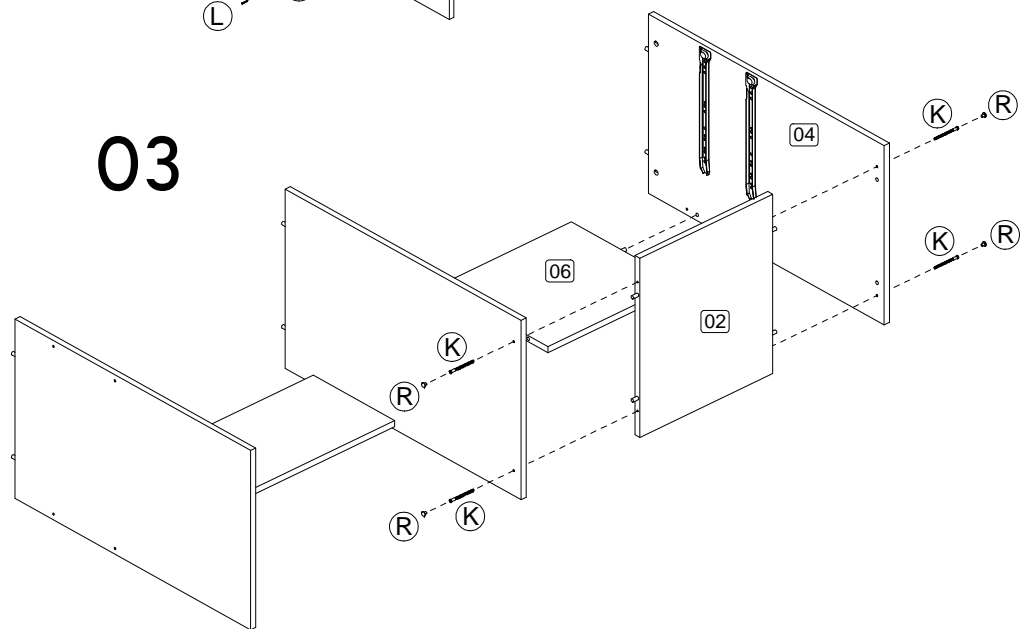

03

ETAPA DE PREPARAÇÃO DAS PEÇAS.
FASE DE PREPARACIÓN DE LAS PIEZAS.
STAGE OF PREPARATION OF THE PIECES.

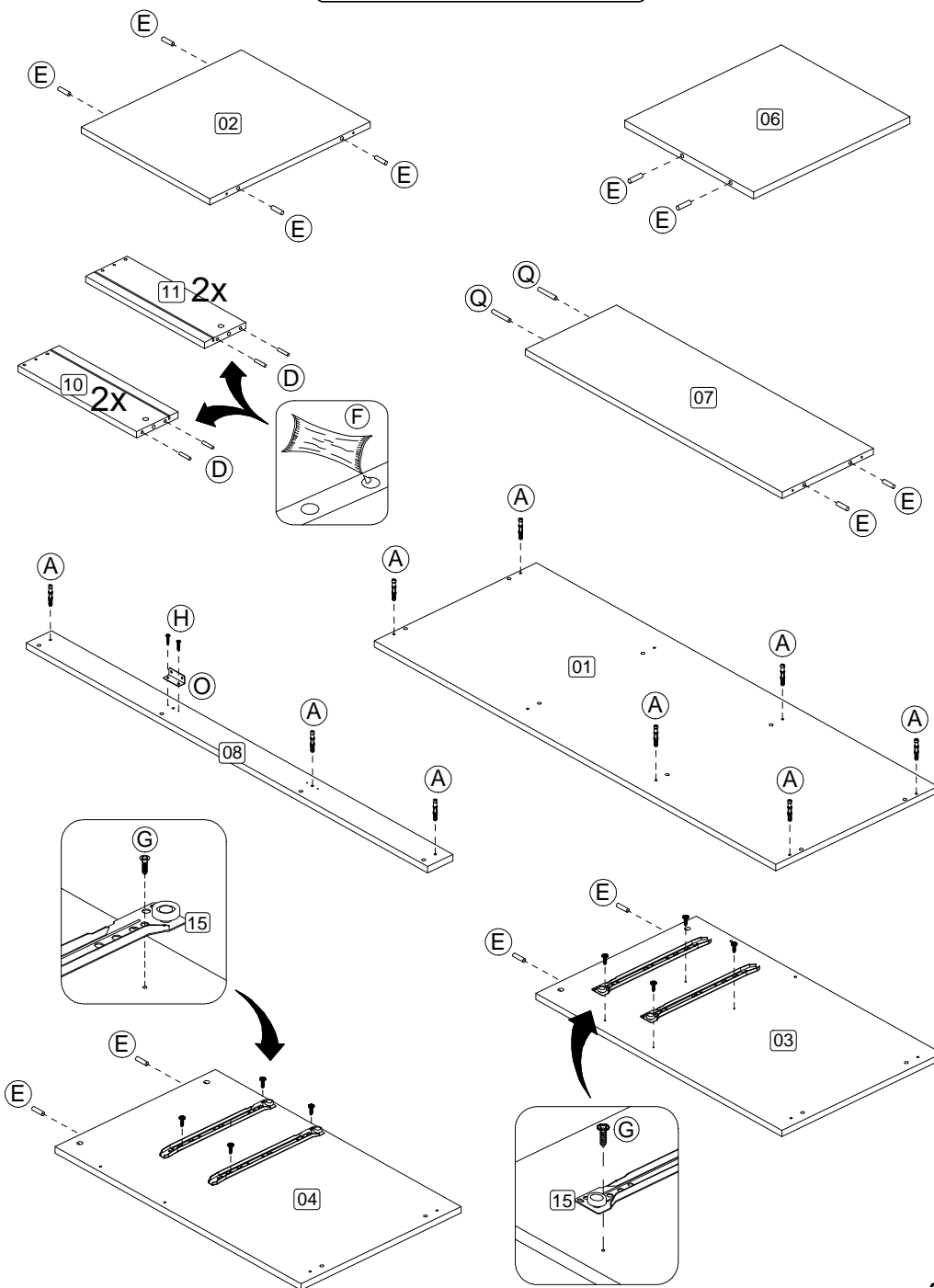

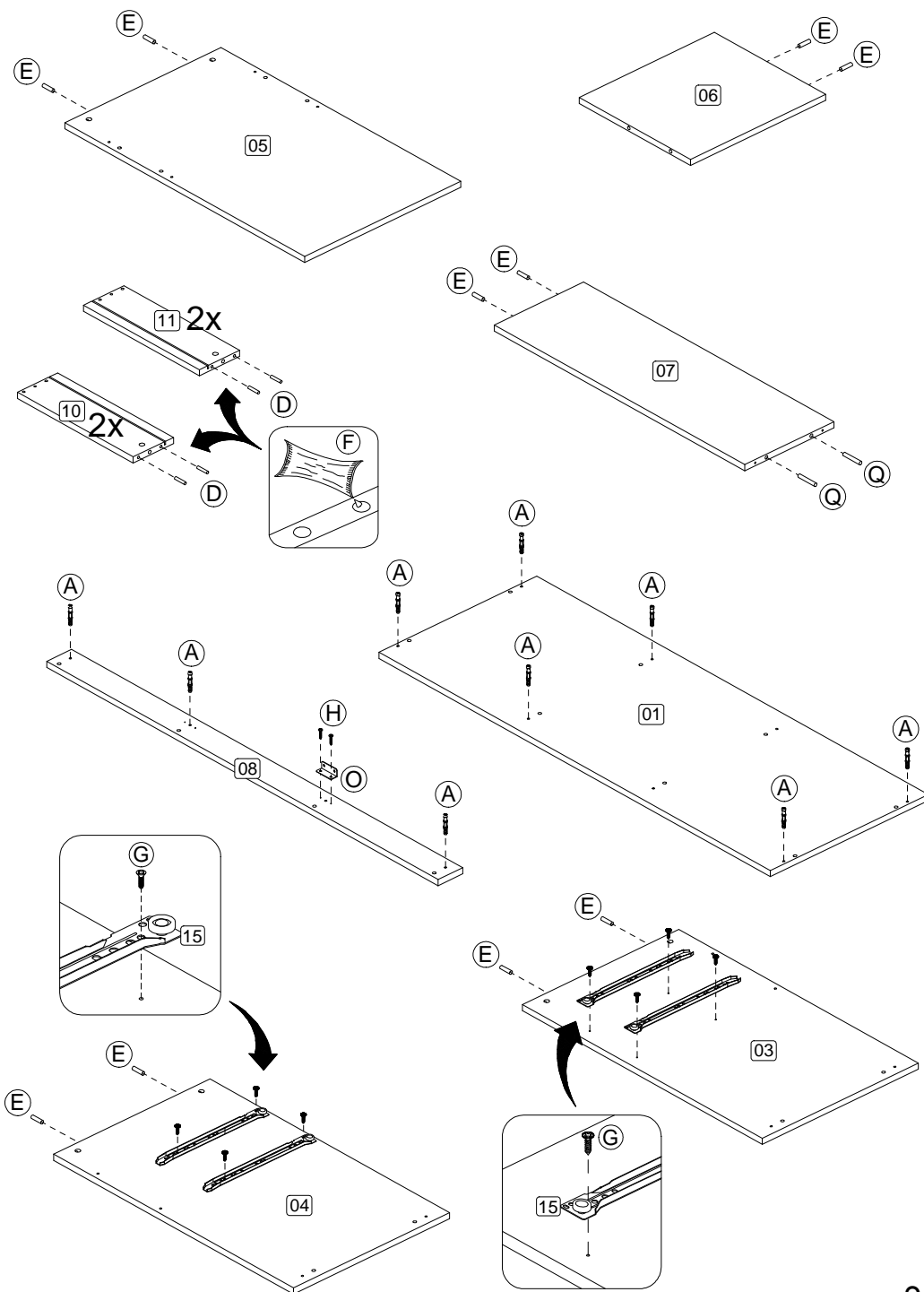
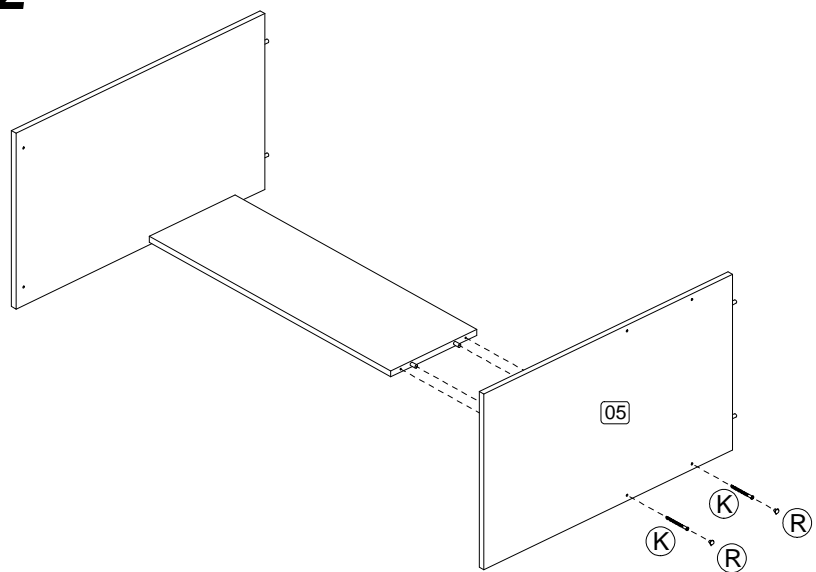
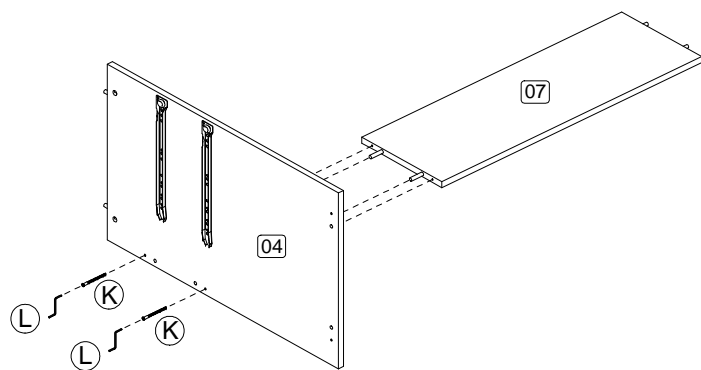
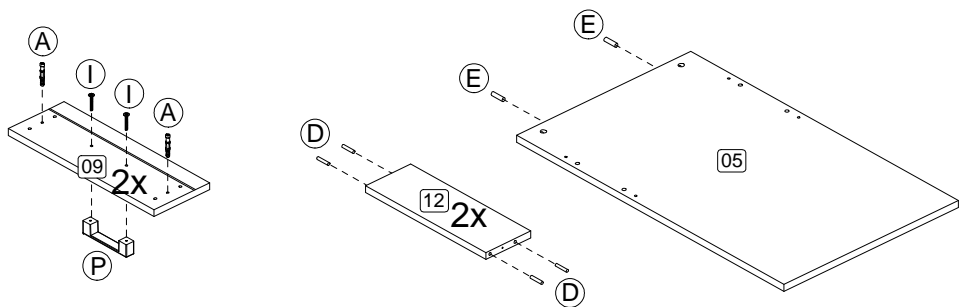

MONTAGEM DAS GAVETAS PARA A DIREITA
MONTAJE DE LOS CAJONES A LA DERECHA
ASSEMBLY OF THE DRAWERS ON THE RIGHT

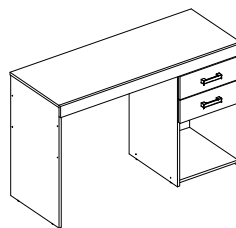

ANTES DE INICIAR A MONTAGEM, IDENTIFIQUE TODAS AS PEÇAS E ACESSÓRIOS.
ANTES DE EMPEZAR EL ARMADO, IDENTIFIQUE TODAS LAS PIEZAS Y ACCESORIOS.
BEFORE STARTING THE ASSEMBLY, IDENTIFY ALL PARTS AND ACCESSORIES.

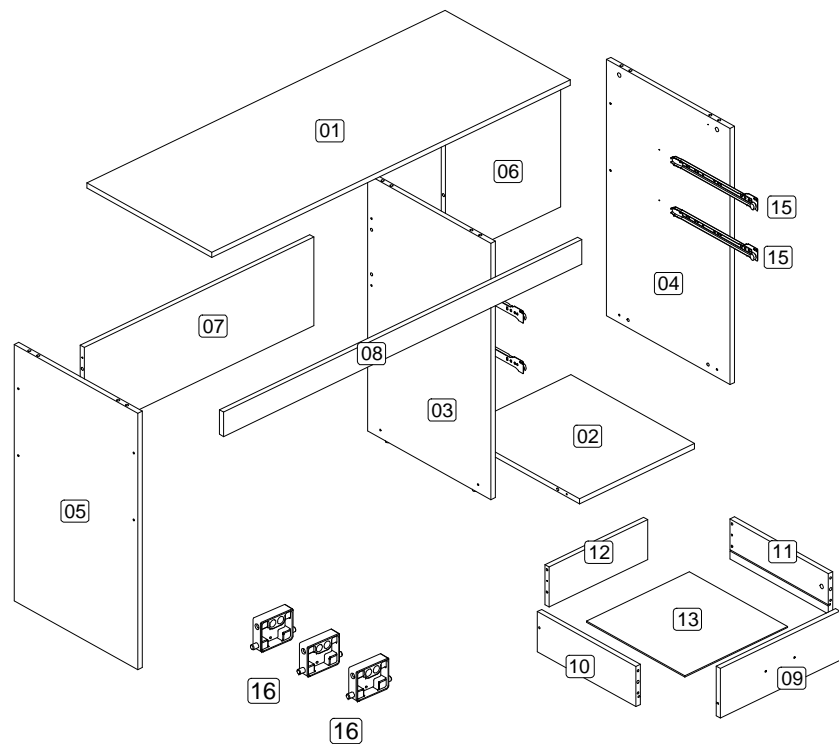

ETAPA DE PREPARAÇÃO DAS PEÇAS.
FASE DE PREPARACIÓN DE LAS PIEZAS.
STAGE OF PREPARATION OF THE PIECES.

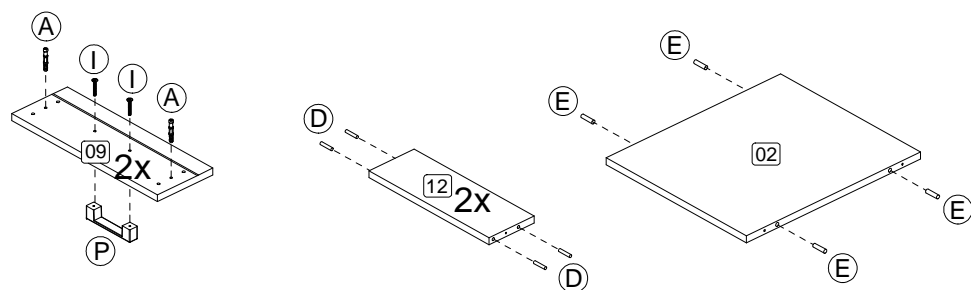

03

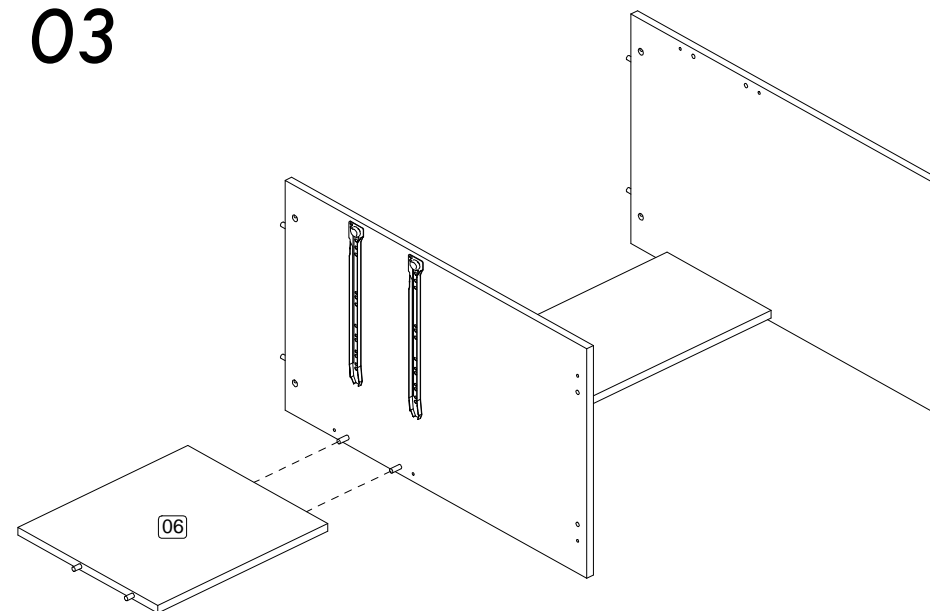

04

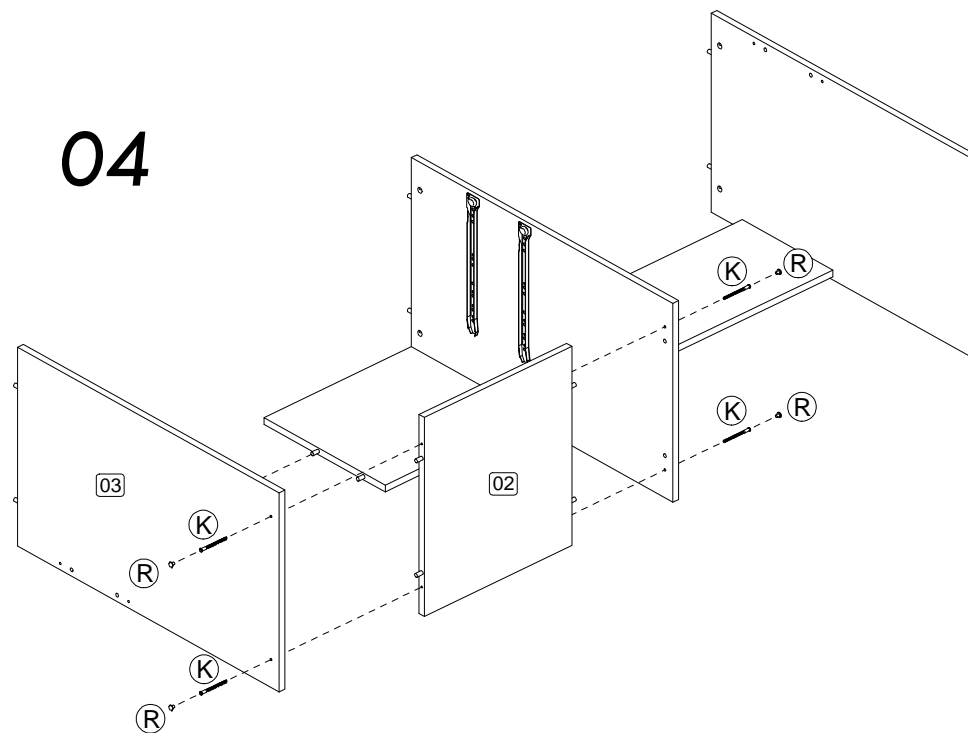

05

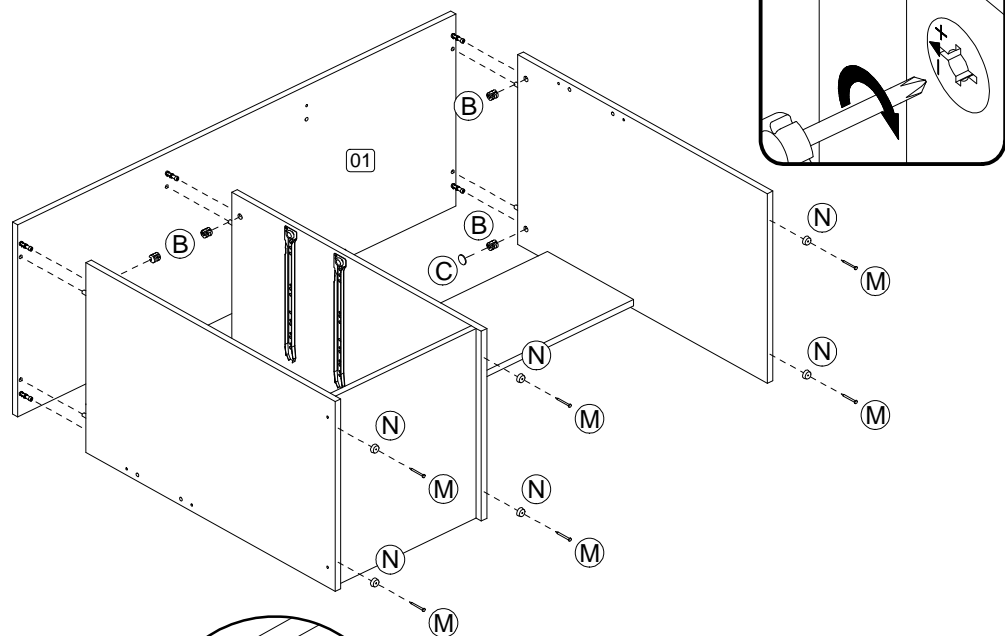

06

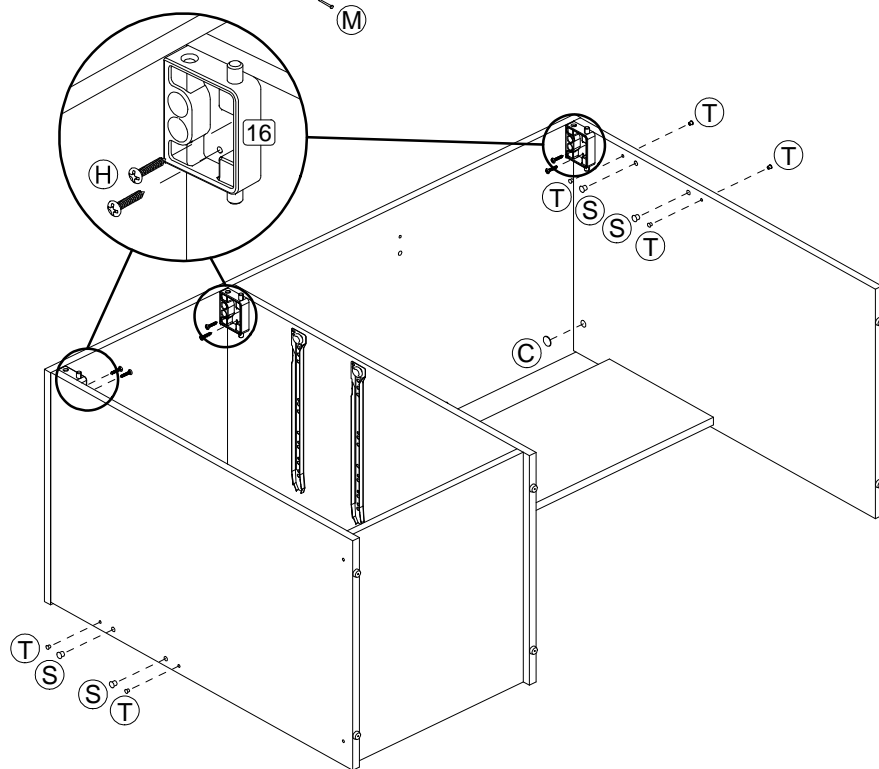

07

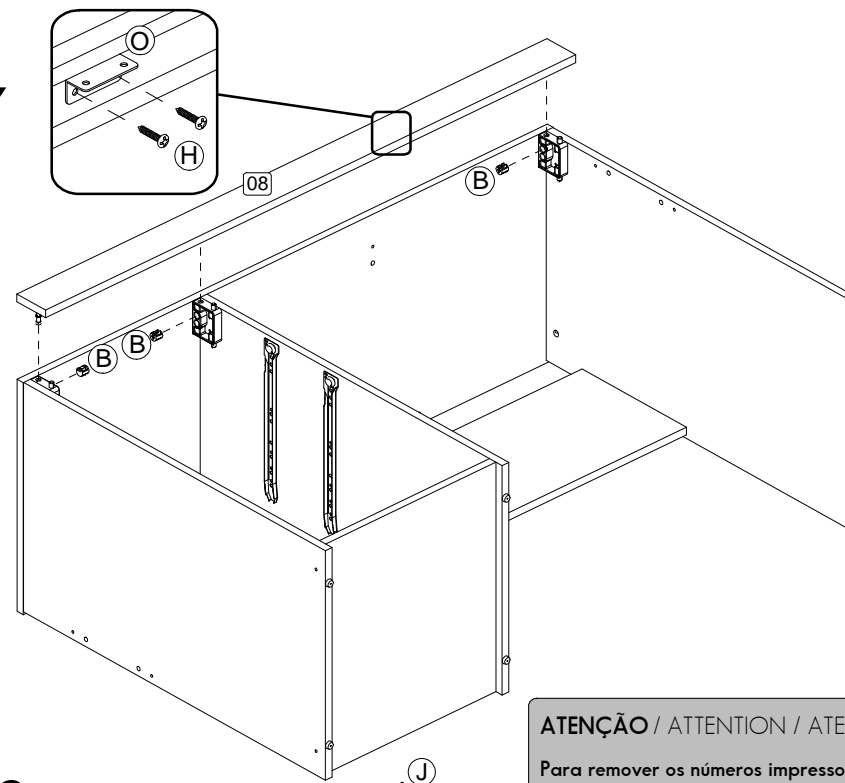

08 (2x)

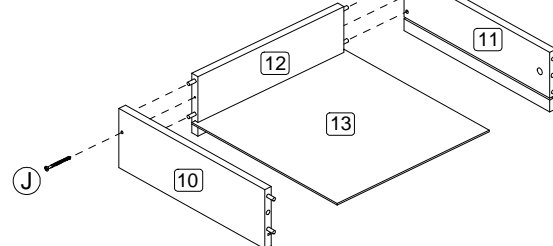

09 (2x)

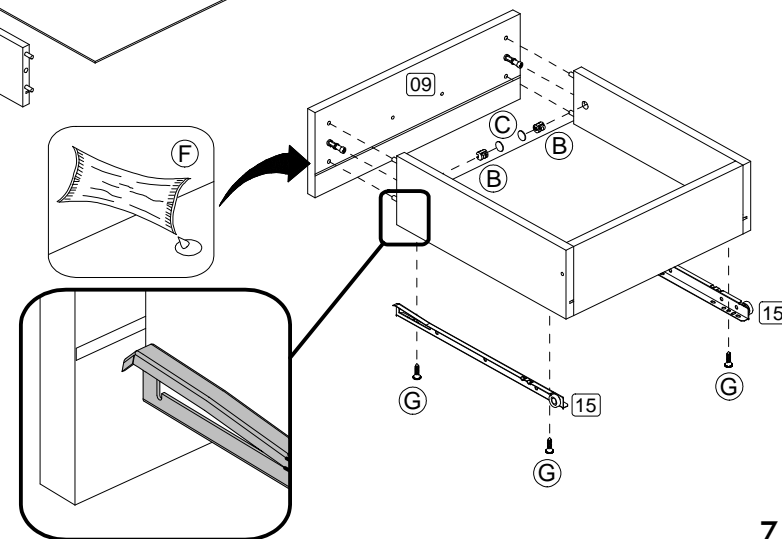

ATENÇÃO / ATTENTION / ATENCIÓN
 Para remover os números impressos nas peças, utilize um pano umedecido em álcool.
 To remove the printed numbers on the pieces, use a cloth moistened with alcohol.
 Para remover los números impresos en las piezas, utilice un paño humedecido con alcohol.