

232 - GR/COMODA NEW CAPRI

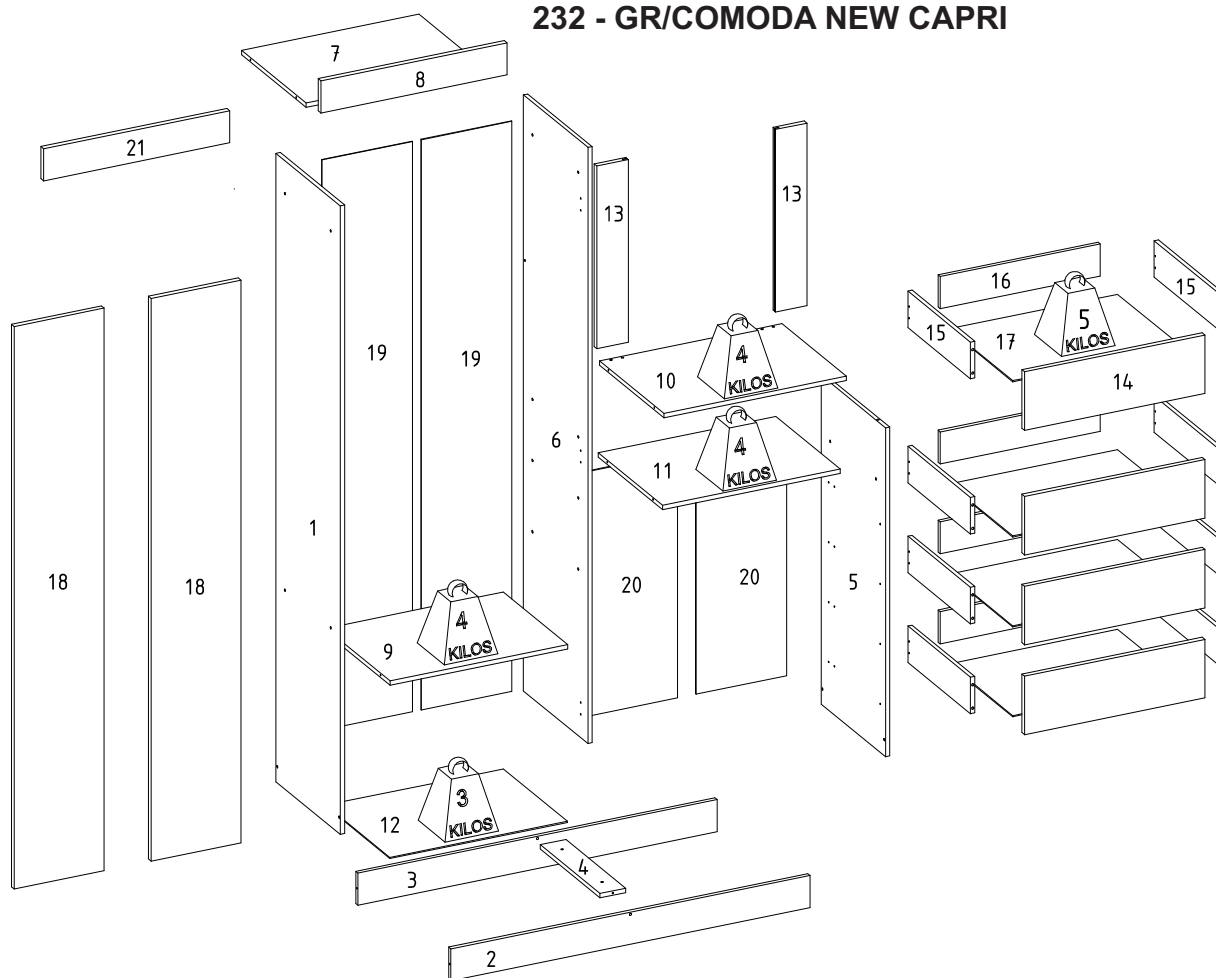

LISTA DE PEÇAS / Pieces List / Lista de Piezas

SEQ.	REF.	DESCRIÇÃO	DESCRIPTION	DESCRIPCIÓN	MAT.PRIMA	COMP.	LARG.	ESP.	QTD.
1	332157	LATERAL ESQUERDA	LEFT SIDE	LADO IZQUIERDO	MDP	1720	360	12	1
2	332158	RODAPE FRONTAL	FRONT SKIRT	FALDÓN DELANTERO	MDP	1004	88	12	1
3	332159	RODAPE TRASEIRO	REAR SKIRTING	PLINTO TRASERO	MDP	1004	88	12	1
4	332160	TRAVA RODAPE	RODAPE LOCK	CIERRE DE VARILLA	MDP	334	88	12	1
5	332161	LATERAL DIREITA	RIGHT SIDE	LADO DERECHO	MDP	900	360	12	1
6	332162	DIVISORIA	DIVIDER	DIVISOR	MDP	1632	360	12	1
7	332163	CHAPEU	HAT	SOMBRERO	MDP	496	360	12	1
8	332164	VISTA SUPERIOR	TOP VIEW	VISTA SUPERIOR	MDP	520	88	15	1
9	332165	PRATELEIRA	SILVER	PLATA	MDP	496	360	12	1
10	332166	TAMPO	TOP	TOP	MDP	510	360	12	1
11	332167	BASE DVD	DVD BASE	BASE DVD	MDP	496	360	12	1
12	332168	BASE	BASE	BASE	HDF	496	358	3	1
13	332169	TRAVESSA ESPELHO	MIRROR RAIL	PLACA ESPEJO	MDP	500	88	15	2
14	332170	FRENTE DE GAVETA	DRAWER FRONT	CAJÓN FRONTAL	MDP	504	160	15	4
15	332171	LATERAL DE GAVETA	DRAWER SIDE	CAJÓN LATERAL	MDP	350	100	12	8
16	332172	CONTRA FUNDO	BACK	TRASERO	MDP	447	88	12	4
17	332173	FUNDO DA GAVETA	DRAWER BOTTOM	CAJÓN FONDO	HDF	471	355	3	4
18	332174	PORTA	DOOR	PUERTA	MDP	1540	251	15	2
19	332175	FUNDO ESQUERDO	LEFT BOTTOM	FONDO IZQUIERDO	HDF	1561	253	3	2
20	332176	FUNDO DIREITO	RIGHT BOTTOM	FONDO DERECHO	HDF	670	253	3	2
21	332177	VISTA SUPERIOR QUADRIFLEX	QUADRIFLEX TOP VIEW	QUADRIFLEX VISTA SUPERIOR	MDP	520	88	15	1

INSTRUÇÃO MONTAGEM PRODUTO

Intructions to Assembly / Instrucciones de montaje

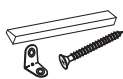

Seperare as peças e acessórios de maneira organizada
Separate parts and accessories in way organized
Separe las piezas y accesorios de manera organizada



Forrar o chão com o papelão das embalagens.
Cover the floor with the cardboard
Cubra el suelo con la embalaje de cartón



É necessário 01 pessoa para montar o produto
01 people are required to assemble the product
Se requieren 01 persona para ensamblar el producto

O produto deve ser a montado por um profissional qualificado
The product must be assembly by a professional
El producto debe ser ensamblado por un profesional calificado

Ferramentas necessárias
(não fornecidas)

Not include tools / No herramientas



CUIDADO PARA CONSERVAÇÃO E LIMPEZA DO MÓVEL

Care to conservation and clean / Cuidados de limpieza

Peso máximo de carga informado refere-se a objetos distribuído de maneira uniforme sobre toda área de contato da peça



The maximum load weight informed refers to objects distributed evenly over the entire contact area of the part
Conjunto de carga máxima de peso se refere a objetos distribuídos uniformemente sobre toda el área de contacto de la pieza de trabajo.



Não molhar o móvel e não expor em lugar úmido
Do not wet the mobile and do not expose in a wet place
No moje el producto y no exponer en un lugar húmedo



Não expor o móvel próximo de fontes de calor.
Do not expose the mobile near heat sources
no exponga cercano de fuentes de calor



Não usar produtos abrasivos.
Do not use abrasive products.
No utilice productos abrasivos.



Limpe com flanela limpa e seca.
Clean with dry cloth
Limpieza con un paño limpio y seco



Para limpar os carimbos das peças utilize uma borracha escolar (item não fornecido)
Para clean the stamps on the pieces use a school eraser (item not provided)
Para limpiar los sellos de las piezas utilice un borrador escolar (artículo no incluido)

LISTA DE ACESSÓRIOS E FERRAGENS / ACCESSORIES AND HARDWARE / ACCESORIOS Y HARDWARE



A- 700137-Parafuso 4,5x45 (26x)
screw / tornillo



B- 700121-Parafuso 3,5x12 (104x)
screw / tornillo



C - 700113-Corrediça (04x)
runners / corredera



D- 700538-Cantoneira (05x)
corner / esquina



E- 700124-Parafuso 3,5x25 (29x)
screw / tornillo



F- 700146-Parafuso minifix (08x)
Minifix screw / Tornillo minifix



G- 700148-Tambor Minifix (08x)
Minifix Drum / Tambor minifix



H- 700547-Junção (06x)
junction / juncion



I- 700542-Cavilha 6x30 (18x)
peg / cerrojo



J- 700300-Bastão madeira (01x)
wooden rail / barra maderera



K- 700297-Perfil H (01x)
handle / manija



L- 700171-Puxador 250 mm (06x)
Handle / Manija



M- 700395-Dobradiça (06x)
700390 - Calço (06x)
hinge / bisagra



N- 700157-Prego (87x)
nail / clavo



O- 700230-Pé PVC (04x)
PVC foot / Pie de PVC



P - 700516-Sache cola 20g (1x)
Glue / Goma



Q - 700294-Espelho (1x)
mirror / espejo



R- 700131-Parafuso 4,0x20 (04x)
screw / tornillo



S- 700298-Perfil H (01x)
handle / manija



T- 700130-Parafuso 4,0x16 (1x)
screw / tornillo



U - 700441-Suporte prateleira(1x)
Support/apoyo



V - 700419-Tapa furo(12x)
cover hole/ agujero de la cubierta

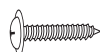

W- 700127-Parafuso 4,0x12 (24x)
screw / tornillo



X- 700435-Suporte 'U' fechado (02x)
closed U support / soporte U cerrado

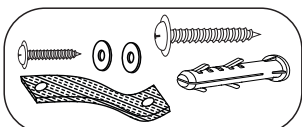

Y- 703012 - Kit anti tonbamento (01x)
Anti-tip kit / Kit antivuelco



Z - 700419-Tapa furo(16x)
cover hole/ agujero de la cubierta

01° PASSO - Fixar o acessório B + C nas peças 5 e 6 e o acessório I na peça 5.

01° STEP - Fix accessory B + C to parts 5 and 6 and accessory I to part 5.

01° PASO - Fijar el accesorio B + C a las partes 5 y 6 y el accesorio I a la parte 5.

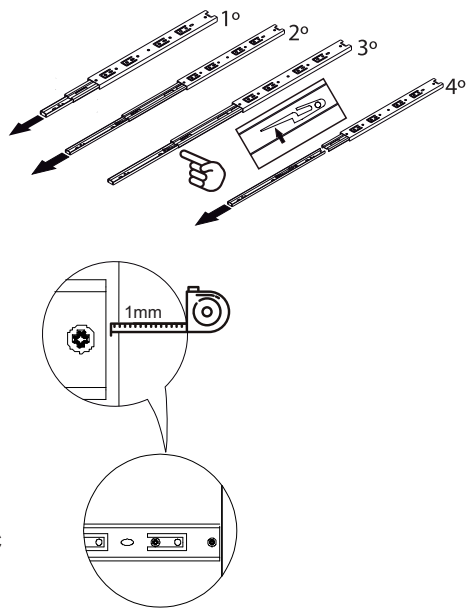
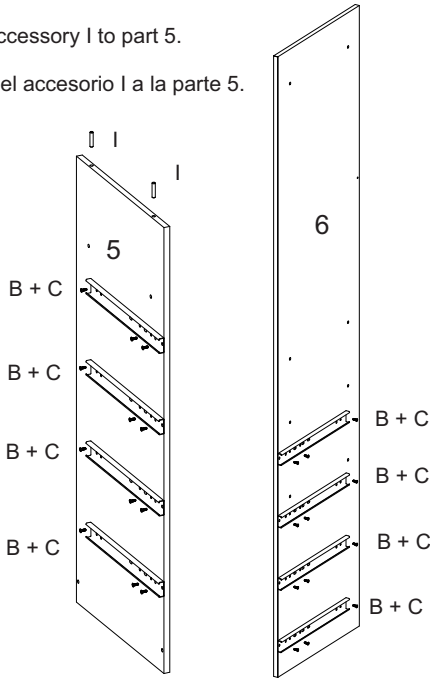
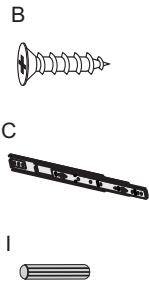

02° PASSO - Fixar o acessório M + R na peça 18.

02° STEP - Fix accessory M + R to part 18.

02° PASO - Fijar el accesorio M + R a la pieza 18.

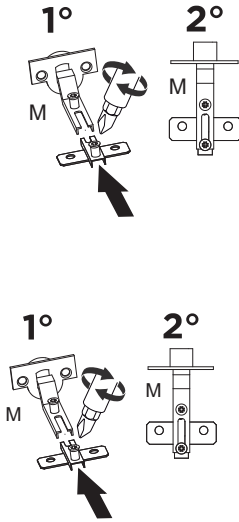
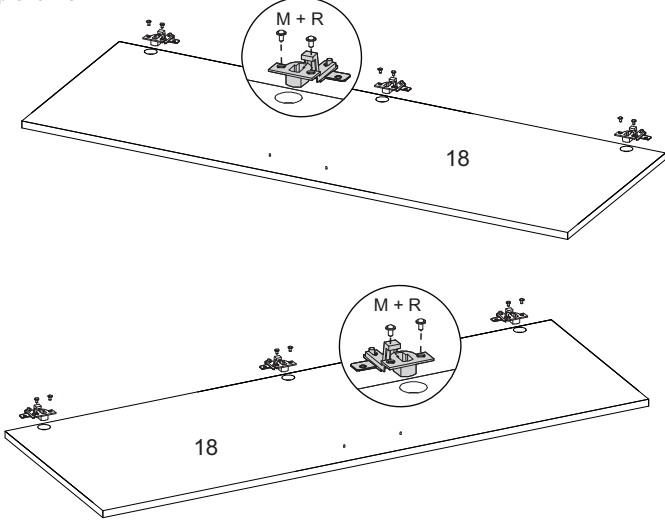

03° PASSO - Fixar a peça 4 nas peças 2 e 3.

03° STEP - Fix part 4 to parts 2 and 3.

03° PASO - Fijar la parte 4 a las partes 2 y 3.

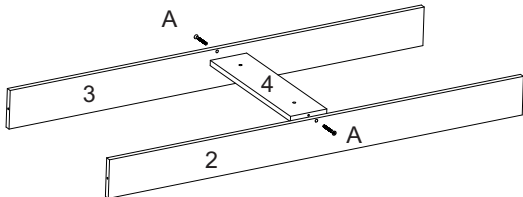
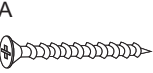

04° PASSO - Fixar peça 1 nas peças 2,3,7 e 9.

04° STEP - Fix part 1 to parts 2, 3, 7 and 9.

04° PASO - Fijar la parte 1 a las partes 2, 3, 7 y 9.

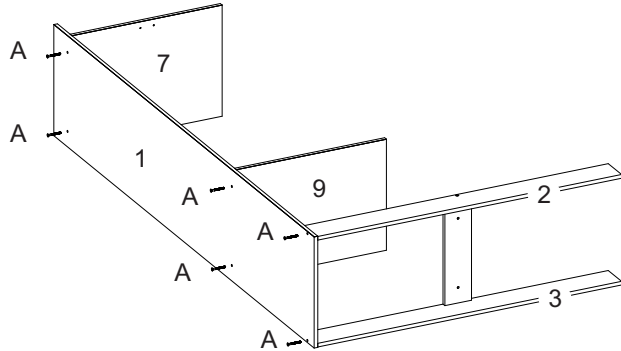
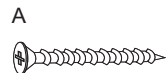

05° PASSO - Fixar a peça 4 na peça 6 e peça 6 na peça 7 e 9.

05° STEP - Fix part 4 to part 6 and part 6 to parts 7 and 9.

05° PASO - Una la parte 4 a la parte 6 y la parte 6 a las partes 7 y 9.

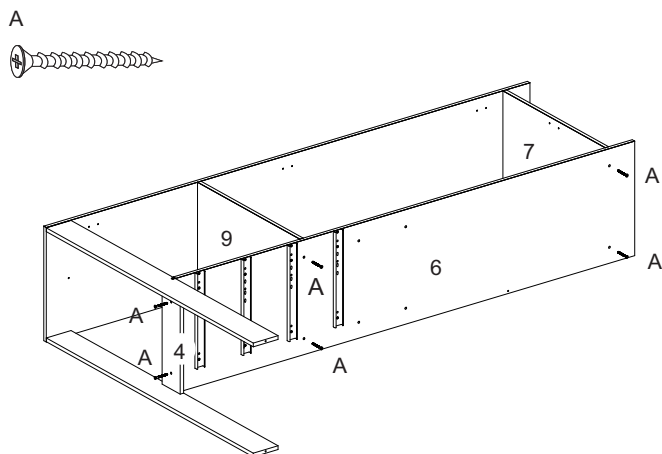

06° PASSO - Fixar a peça 5 na peça 2 e 3.

06° STEP - Attach part 5 to parts 2 and 3.

06° PASO - Fijar la parte 5 a las partes 2 y 3.

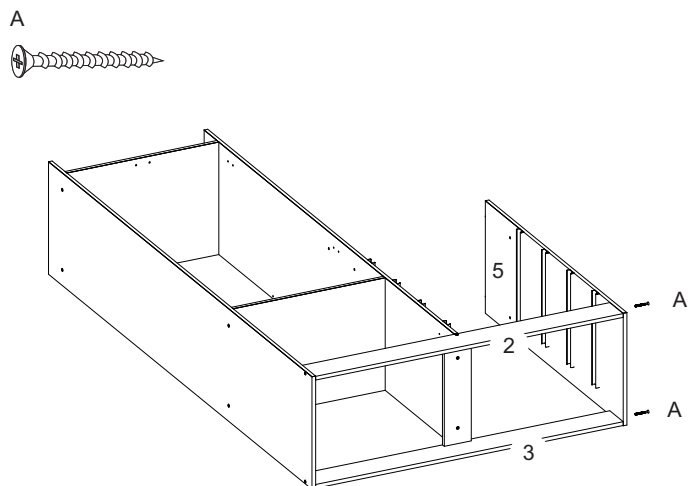

07° PASSO - Fixar o acessório B + O.

07° STEP - Fix accessory B + O.

07° PASO - Fijar el accesorio B + O.

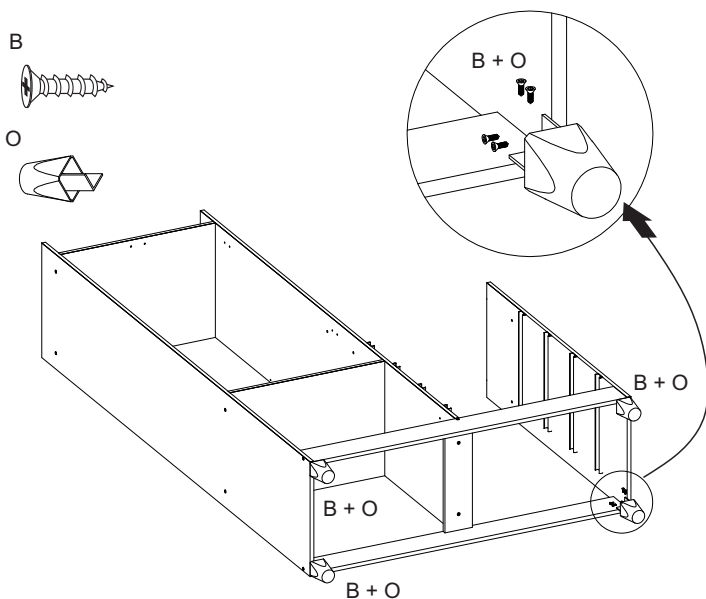

08° PASSO - Fixar a peça 10 na peça 5 e 6.

08° STEP - Fix part 10 to parts 5 and 6.

08° PASO - Fijar la parte 10 a las partes 5 y 6.

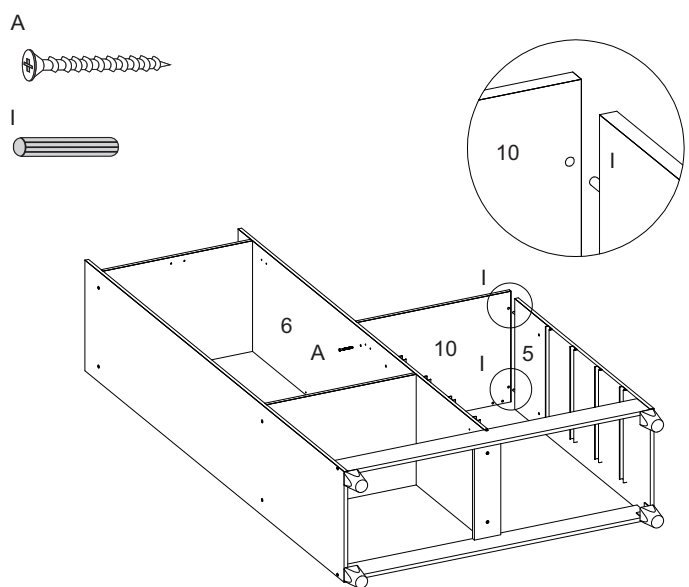

09° PASSO - Fixar o acessório B + D na peça 10.

09° STEP - Fix accessory B + D to part 10.

09° PASO - Fijar el accesorio B + D a la pieza 10.

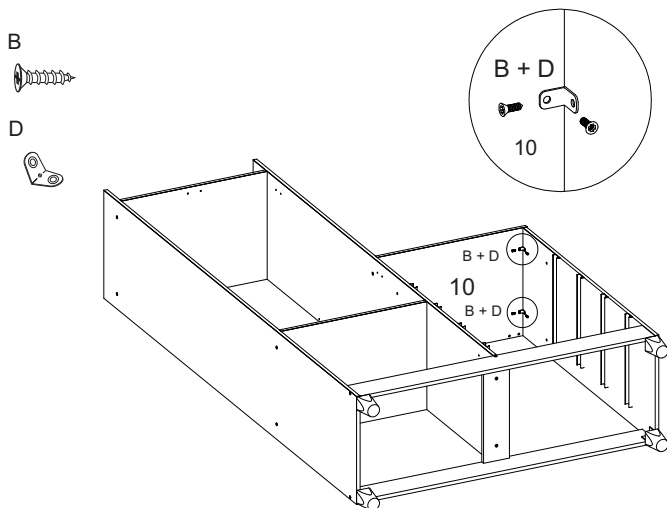

10° PASSO - Fixar o acessório B + D na peça 8.

10° STEP - Fix accessory B + D to part 8.

10° PASO - Fijar el accesorio B + D a la pieza 8.

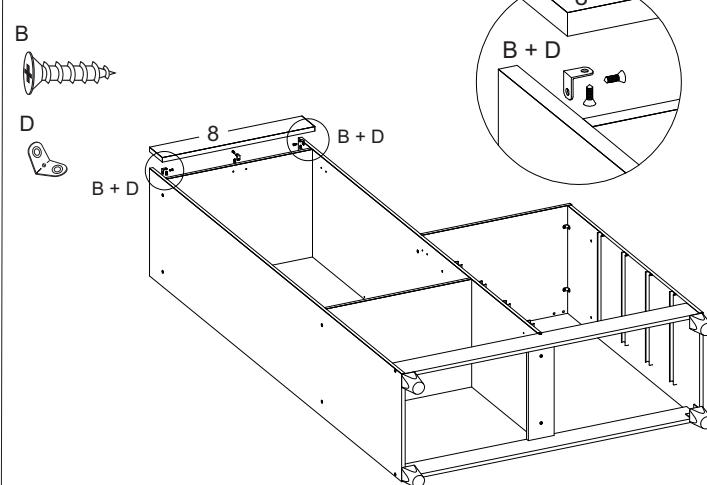

11º PASSO - Fixar os acessórios W + X na peça 7.

11º STEP - Fix accessories W + X to part 7.

11º PASO - Fije los accesorios W + X a la pieza 7.

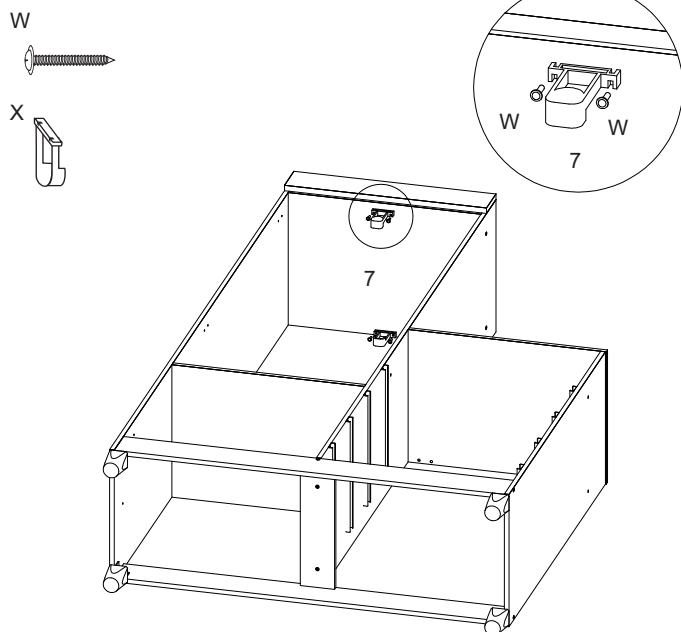

12º PASSO - Fixar a peça 13 na peça 10 e o descansar o acessório J no X .

12º STEP - Fix part 13 to part 10 and rest accessory J on X .

12º PASO - Fijar la pieza 13 a la pieza 10 y apoye el accesorio J sobre X .

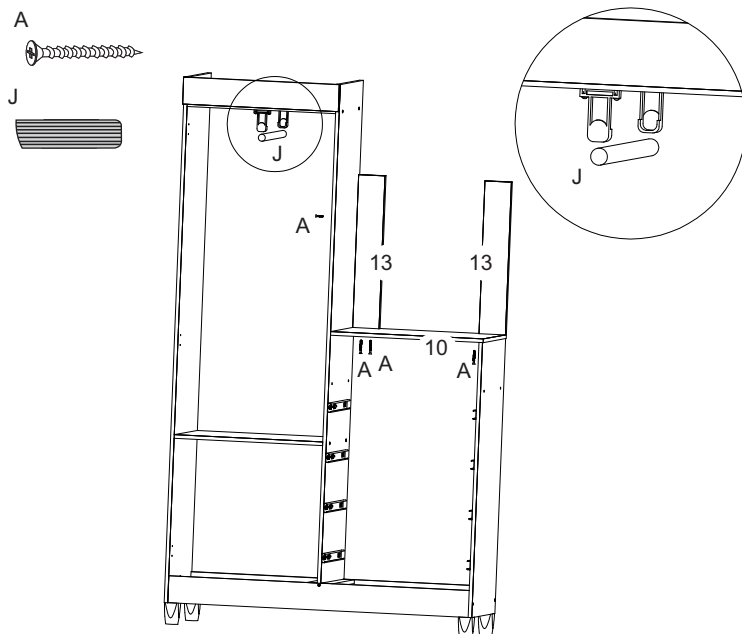

13º PASSO - Fixar a peça 19 e 20 com os acessórios K,S , N + H e B .

13º STEP - Fix parts 19 and 20 with fittings K,S , N + H and B .

13º PASO - Fijar las piezas 19 y 20 con los racores K,S , N + H y B .

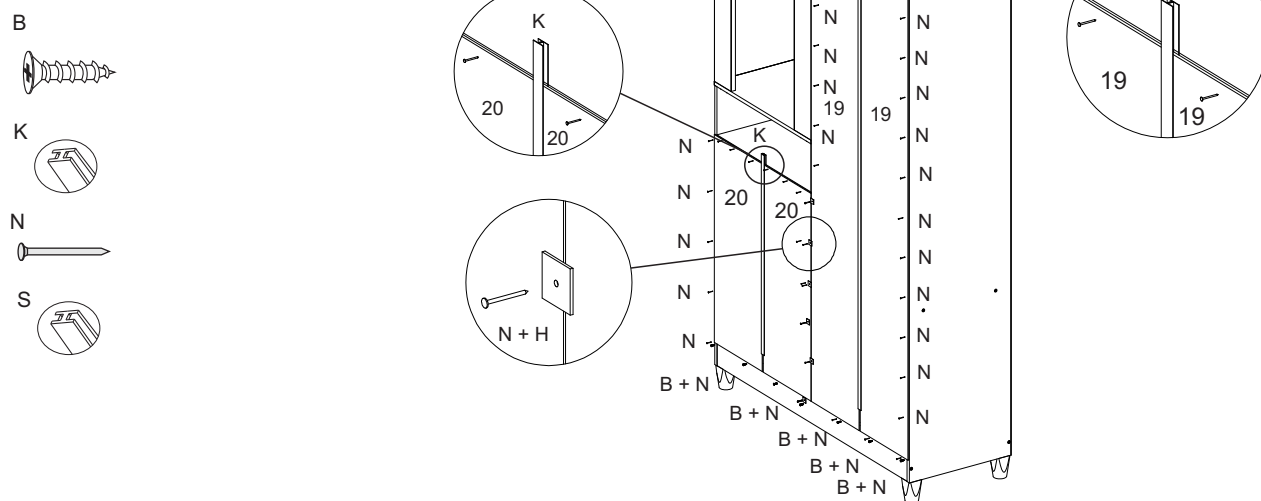

14º PASSO - Fixar a peça 11 nas peças 5 e 6.

14º STEP - Fix part 11 to parts 5 and 6.

14º PASO - Fijar la parte 11 a las partes 5 y 6.

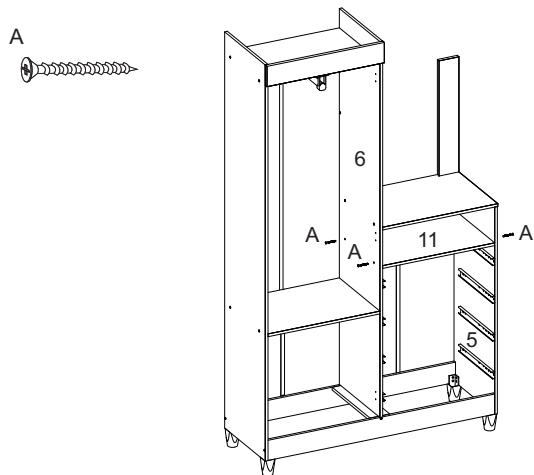

15º PASSO - Fixar o acessório U + T na peça 6 e descansar a peça 12.

15º STEP - Fix the U + T accessory to part 6 and rest part 12.

15º PASO - Fijar el accesorio U + T a la pieza 6 y descanse la pieza 12.

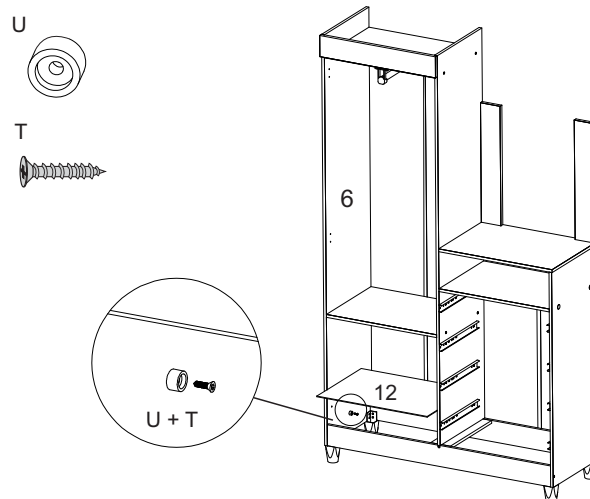

16º PASSO - Fixar a peça 18 nas peças 1 e 6 e fixar o acessório E + L nas peças 18.

16º STEP - Fix part 18 to parts 1 and 6 and attach accessory E + L to part 18.

16º PASO - Fijar la pieza 18 a las piezas 1 y 6 y fije el accesorio E + L a la pieza 18.

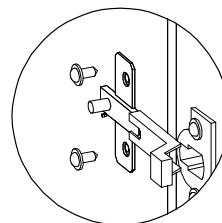
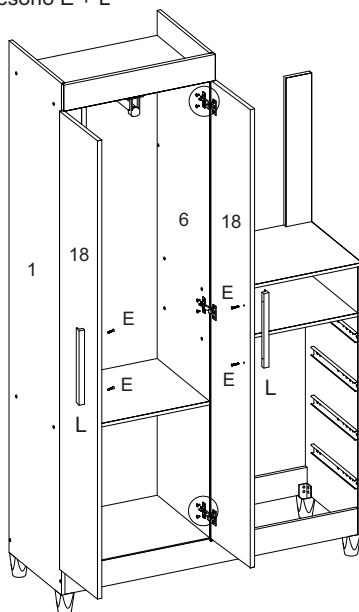
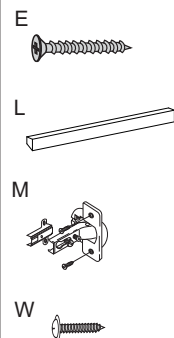

M + W

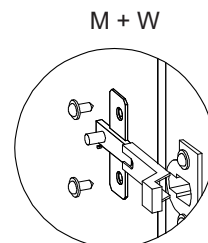

M + W

17º PASSO - Fixar as peças 15 na peça 14 e 16 peça.

17º STEP - Fix parts 15 to part 14 and part 16.

17º PASO - Fijar las partes 15 a la parte 14 y a la parte 16.

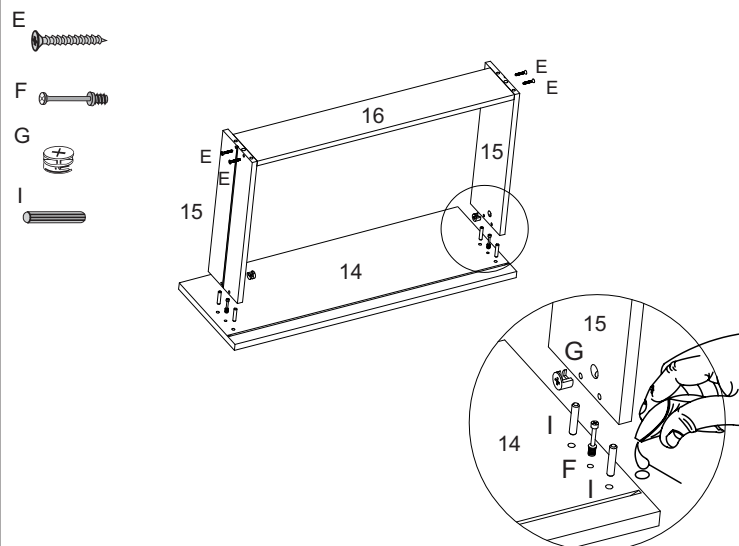

18º PASSO - Fixar a peça 17 nas peças 15 e 16.

18º STEP - Fix part 17 to parts 15 and 16.

18º PASO - Fijar la pieza 17 a las piezas 15 y 16.

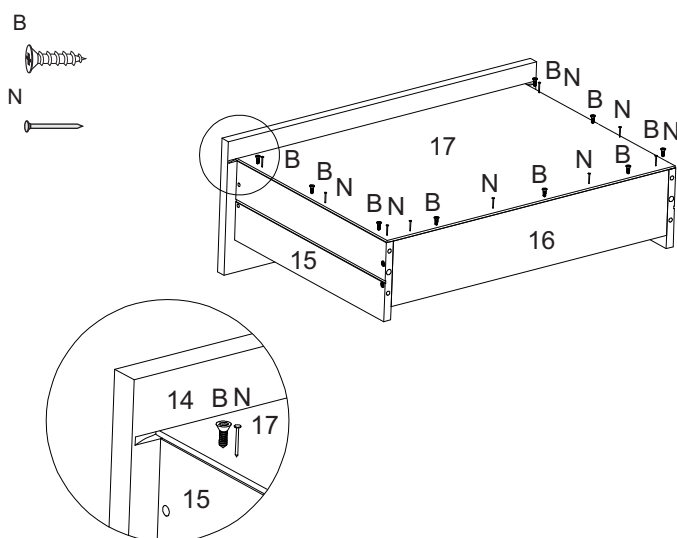

19º PASSO - Fixar o acessório B + C na peça 15.

19º STEP - Fix accessory B + C to part 15.

19º PASO - Fijar el accesorio B + C a la pieza 15.

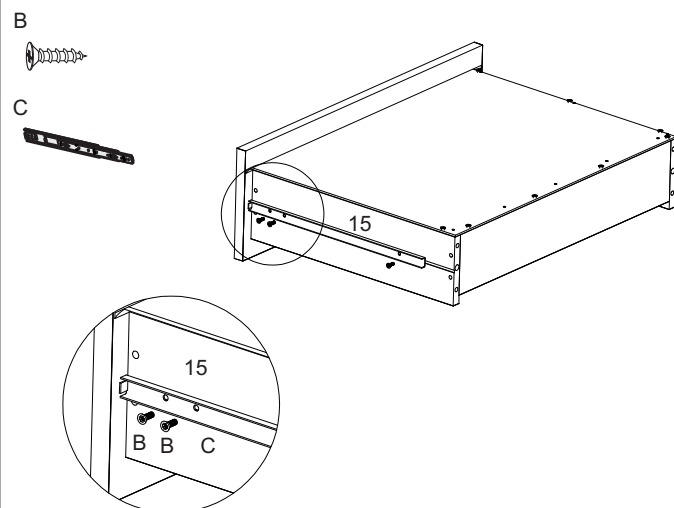

20º PASSO - Fixar o acessório E + L na peça 14.

20º STEP - Fix accessory E + L to part 14.

20º PASO - Fijar el accesorio E + L a la pieza 14.

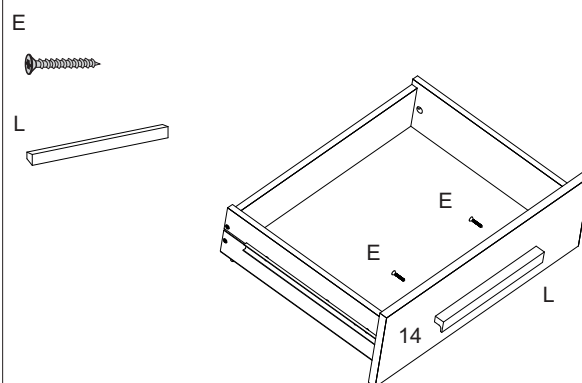

21° PASSO - Encaixar Gavetas no Produto.

21° STEP - Fitting drawers into the product.

21° PASO - Colocación de cajones en el producto.

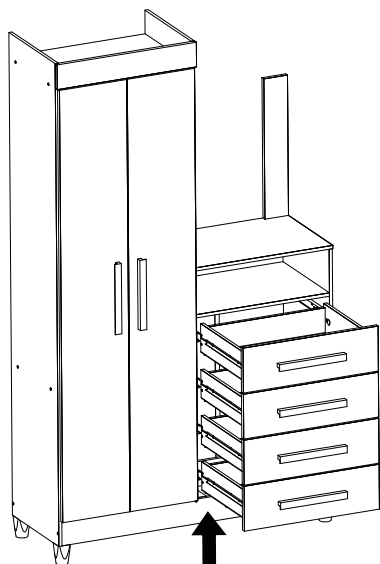

22° PASSO - Encaixar o acessório Q nas peças 13.

22° STEP - Fit the Q accessory to the parts 13.

22° PASO - Coloque el accesorio Q en las piezas 13.

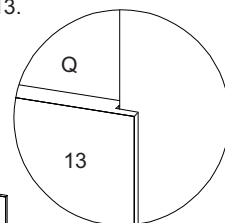
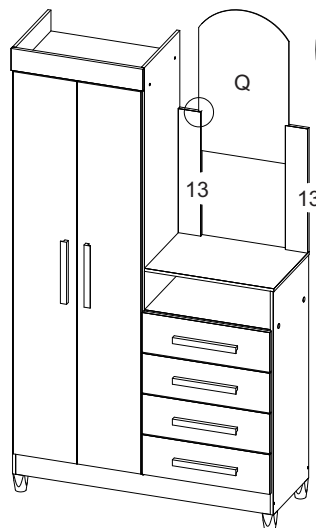
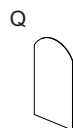

O produto contém um kit anti tombamento que deve ser fixado na parede e na parte traseira do produto

The product contains an anti-tip kit that must be fixed to the wall and back of the product

El producto contiene un kit antivuelco que debe fijarse a la pared y a la parte posterior del producto

Y

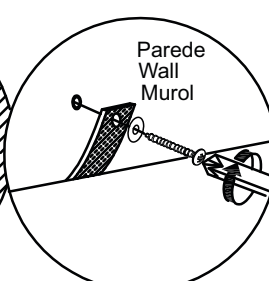
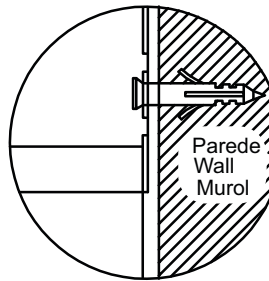
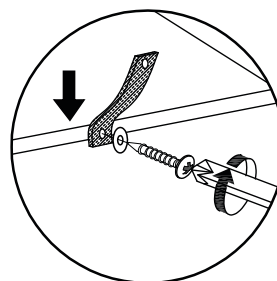
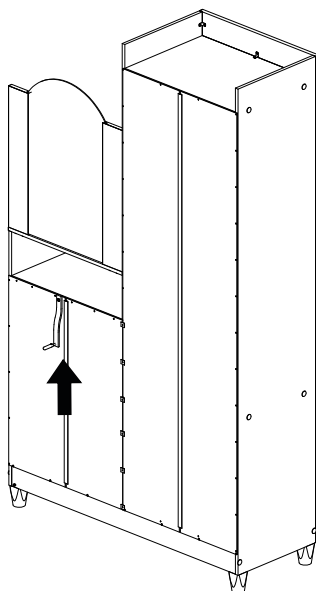
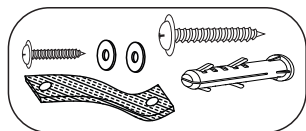

ASPECTO FINAL DO PRODUTO

FINAL ASPECT OF PRODUCT

ASPECTO FINAL DEL PRODUCTO

