

MANUAL COMPLETO
COMPLETE MANUAL

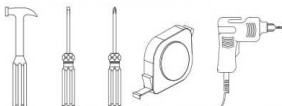

DEMÓBILE Indústria de Móveis Ltda.
Rua : Jurutau, 1350 - Pq. Industrial II.
Cep.: 86703-070
Arapongas - PR - Brasil
demobile@demobile.com.br



Avisos

1. Ler atentamente as instruções do manual antes de iniciar a montagem do móvel.
2. A montagem deverá ser feita em superfície limpa e plana, aconselhamos forrar o chão com a embalagem do produto, para não danificar.
3. Os parafusos devem ser apertados periodicamente.
4. Evitar batidas e contato com objetos cortantes.
5. O peso máximo de carga informado refere-se a objetos distribuídos de maneira uniforme sobre toda área de contato da peça.

Limpeza e Conservação
Efetuar a limpeza somente com pano macio limpo e seco.
Não Utilizar produtos abrasivos ou químicos.

Garantia
1.O fabricante responsabiliza-se apenas pelas peças do produto.
2.A montagem incorreta acarretará na perda da garantia e das assistências, desta forma o produto deverá ser montado por profissional qualificado.
3.Não estão cobertos pela garantia problemas que tenham origem na utilização inadequada do produto ou na exposição do mesmo a intempéries como: infiltrações, infestação de pragas em geral, aparecimento de mofo e outros, decorrentes do ambiente de instalação.

Assistência Técnica: Em caso de peças em assistência técnica é necessário que as mesmas sejam solicitadas junto a loja ou site no qual a compra do produto foi realizada

Warnings

1. Read the manual instructions carefully before starting to assemble the furniture.
2. The assembly must be done in clean and flat surface, we advise to put the product packaging on the floor, not to damage it during the assembling.
3. The screws must be tightened periodically.
4. Avoid hitting and contacting sharp objects.
5. The payload informed refers to the objects distributed all over the piece contact area.

Cleaning and conservation
Clean the product just with a soft, cleaned and dry cloth.
Do not use abrasive or chemicals products.

Warranty
1.The manufacturer is only responsible for product parts.
2. Incorrect assembling will make you lost the guarantee and assistance, in this way the product must be assembled by qualified professional.
3. It is Not covered by the warranty problems caused by an inappropriate use of the product or product exposure even in bad weather, such as: infiltrations, pest infestation in general, appearance of mold and others, caused by the installation environment.

Technical Assistance: Damaged pieces! Ask on the stores you bought it.

Advertencias

1. Lee atentamente las instrucciones del manual antes de empezar a armar los muebles.
2. El montaje debe hacerse en superficie limpia y plana, utilice el empaque del Producto para cubrir el piso
3. Los tornillos deben ser apretados periódicamente
4. Evite golpear y chocar objetos punzantes
5. El peso máximo de carga tiene relación a los objetos distribuydos sobre toda el área de contacto de la pieza.

Limpeza y conservación
Limpiar solo con un trapo suave, limpio y seco
No utilice productos abrasivos o productos químicos

Garantía
1.El fabricante solo es responsable a las partes del producto.
2. Armar incorrectamente supone la pérdida de garantía y repuestos, de esta manera el producto debe ser ensamblado por profesional calificado
3.No es garantizado problemas derivados del uso inapropiado del producto, o exposición del producto al mal tiempo, como: Infiltraciones, infestación de plagas en general, aparición de moho y otros.

Asistencia técnica: en caso de piezas rotas es necesario que sea solicitadas las mismas a la tienda o sitio web donde se compró el producto.

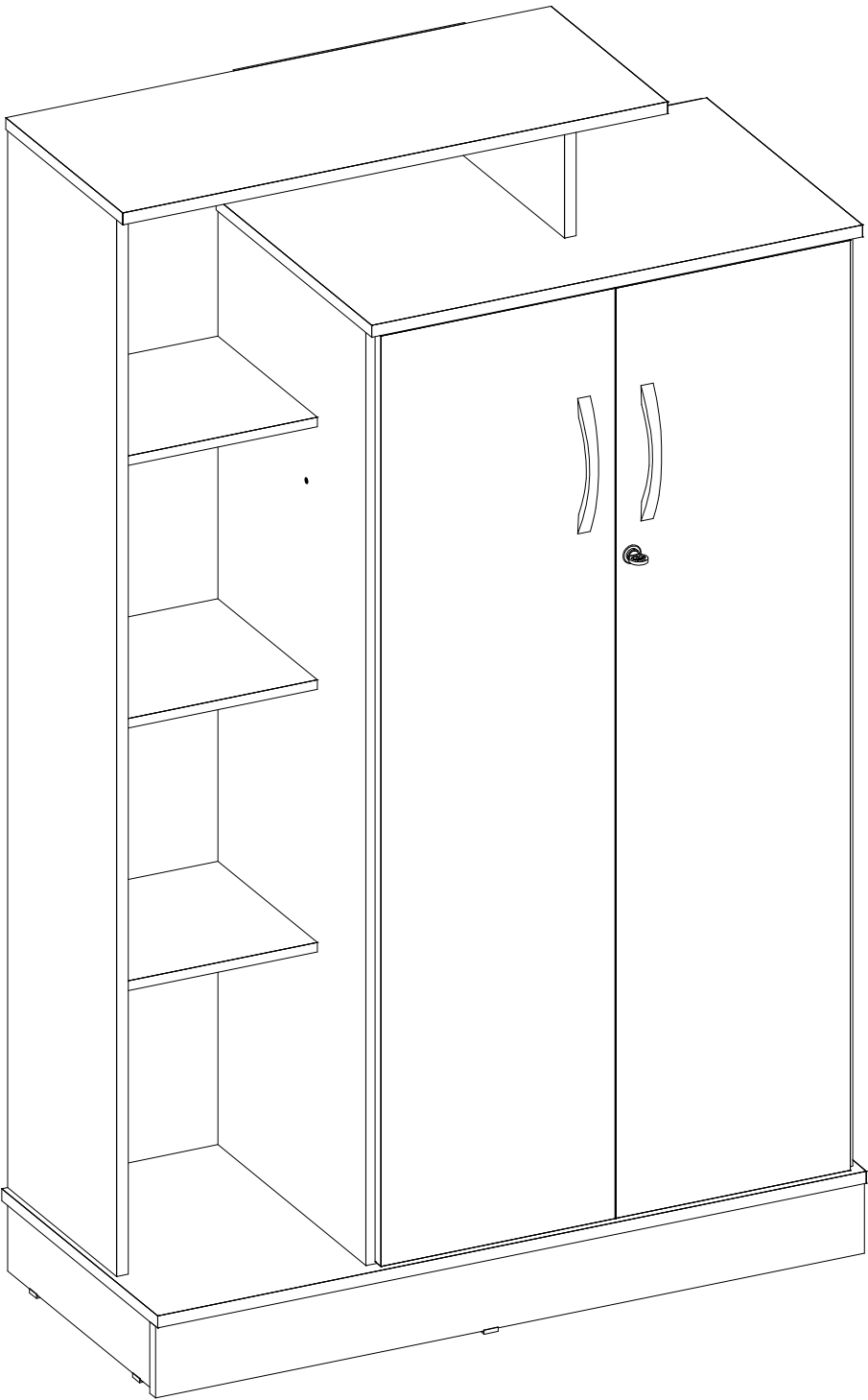

20220 ARMARIO MULTIUSO 2 PORTAS ELITE COM CHAVE

20220 MULTIPURPOSE 2 DOORS ELITE WITH KEY

20220 ARMARIO MULTIUSO 2 PUERTAS ELITE CON LLAVE

ARMARIO MULTIUSO 2 PORTAS ELITE COM CHAVE
MULTIPURPOSE 2 DOORS ELITE WITH KEY
ARMARIO MULTIUSO 2 PUERTAS ELITE CON LLAVE

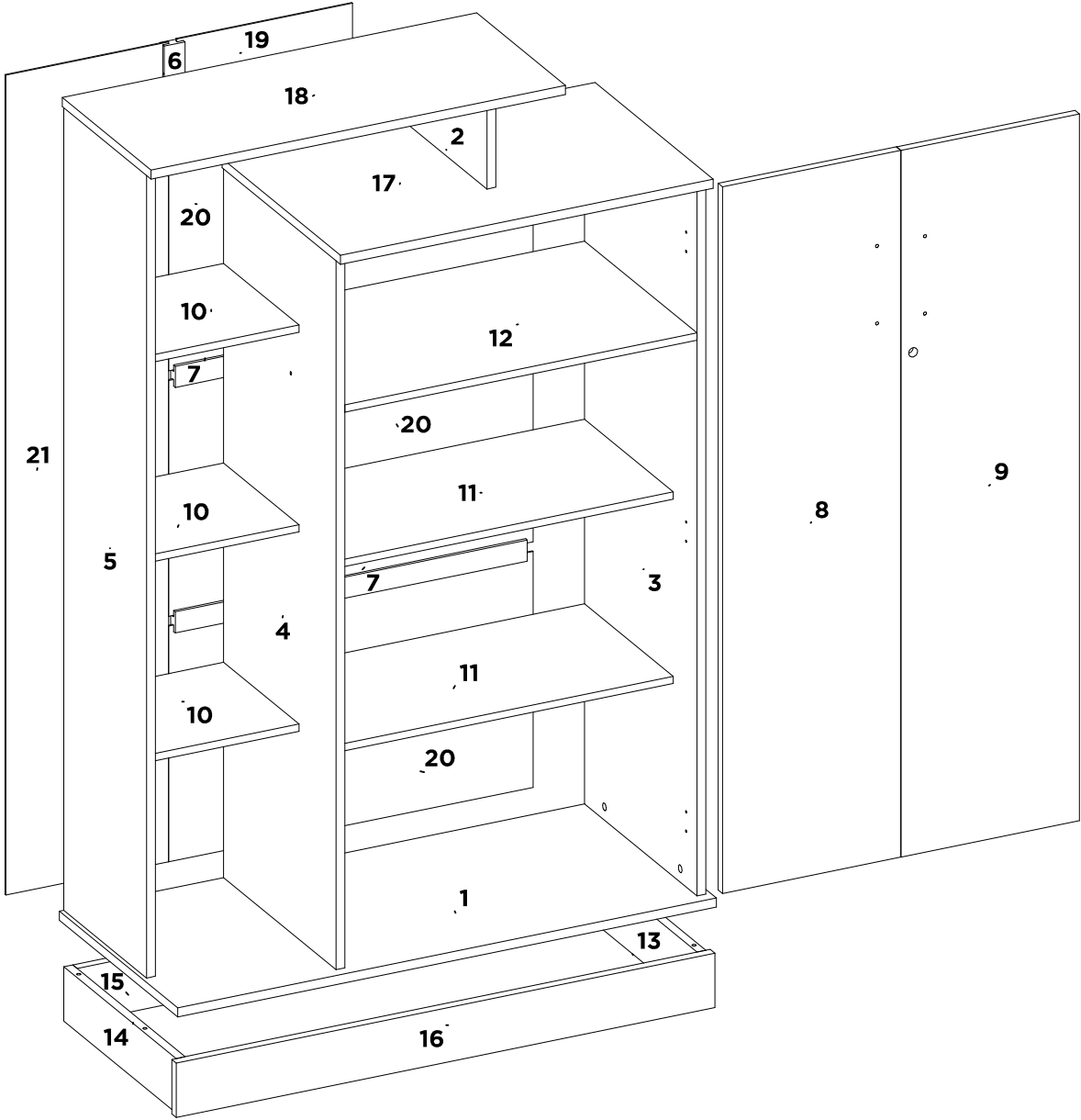

		BRANCO	EBANO	NOGAL					DESCRIÇÃO DE PECAS	DATA LANÇAMENTO: 06/07/2021		DIMENSÕES / QUANTIDADE	
		-	TOUCH	VANILLA					DESCRIPTION OF PARTS	DATA ATUALIZAÇÃO: 15/09/2022		DIMENSIONS / QUANTITY	
				TOUCH					DESCRIPCION DE LAS PIEZAS			DIMENSIONES / CANTIDAD	
SEQ.	CODIGO	REF_01	REF_02	REF_03	REF_04	REF_05	REF_06	REF_07	DESCRICAO	DESCRIPTION_EN	DESCRIPCION_ES	DIMENSOES_MM	QTD
1	03029	03	105	106	-	-	-	-	BASE	BASE	BASE	910 X 400 X 15	1
2	08004	03	105	106	-	-	-	-	DIVISAO	DIVISION	DIVISION	280 X 140 X 15	1
3	11031	03	105	106	-	-	-	-	LATERAL DIREITA	RIGHT SIDE PANEL	LATERAL DERECHA	1175 X 380 X 15	1
4	11032	03	105	106	-	-	-	-	LATERAL ESQ PORTA	LEFT SIDE PANEL	LATERAL IZQUIERDA	1175 X 380 X 15	1
5	11037	03	105	106	-	-	-	-	LATERAL ESQUERDA	LEFT SIDE PANEL	LATERAL IZQUIERDA	1330 X 280 X 15	1
6	13001	03	112	113	-	-	-	-	PERFIL H 35MM 140 MM	PROFILE H	PERFIL H	140 X 35 X 15	1
7	13004	03	112	113	-	-	-	-	PERFIL H 35MM 595 MM	PROFILE H	PERFIL H	595 X 35 X 15	2
8	14022	03	105	108	-	-	-	-	PORTA ESQUERDA	LEFT DOOR	PUERTA IZQUIERDA	1169 X 301 X 15	1
9	14337	03	105	108	-	-	-	-	PORTA DIREITA	RIGHT DOOR	PUERTA DERECHA	1169 X 301 X 15	1
10	15001	03	105	106	-	-	-	-	PRATELEIRA	SHELF	ESTANTERIA	255 X 255 X 12	3
11	15029	03	112	113	-	-	-	-	PRATELEIRA MOVEL	SHELF	ESTANTERIA	595 X 300 X 12	2
12	15031	03	112	113	-	-	-	-	PRATELEIRA FIXA	SHELF	ESTANTERIA	595 X 380 X 12	1
13	16002	03	105	106	-	-	-	-	RODAPE LATERAL DIREITO	RIGHT BOTTOM BOARD	ZÓCALO LATERAL DERECHO	380 X 90 X 15	1
14	16003	03	105	106	-	-	-	-	RODAPE LATERAL ESQUERDO	LEFT BOTTOM BOARD	ZÓCALO LATERAL IZQUIERDO	380 X 90 X 15	1
15	16037	20	20	20	-	-	-	-	RODAPE TRASEIRO	BOTTOM BOARD BACK	ZÓCALO TRASERO	865 X 90 X 15	1
16	16043	03	105	106	-	-	-	-	RODAPE FRONTAL	BOTTOM BOARD FRONT	ZÓCALO FRONTAL	910 X 90 X 15	1
17	19027	03	105	106	-	-	-	-	TAMPO	TOP	TAPA	630 X 400 X 15	1
18	19040	03	105	106	-	-	-	-	TAMPO SUPERIOR	TOP	TAPA	700 X 300 X 15	1
19	20001	03	112	113	-	-	-	-	TRASEIRO	BACK PANEL	TRASERO	297 X 155 X 3	1
20	20018	03	112	113	-	-	-	-	TRASEIRO	BACK PANEL	TRASERO	616 X 390 X 3	3
21	20055	03	112	113	-	-	-	-	TRASEIRO	BACK PANEL	TRASERO	1356 X 275 X 3	1

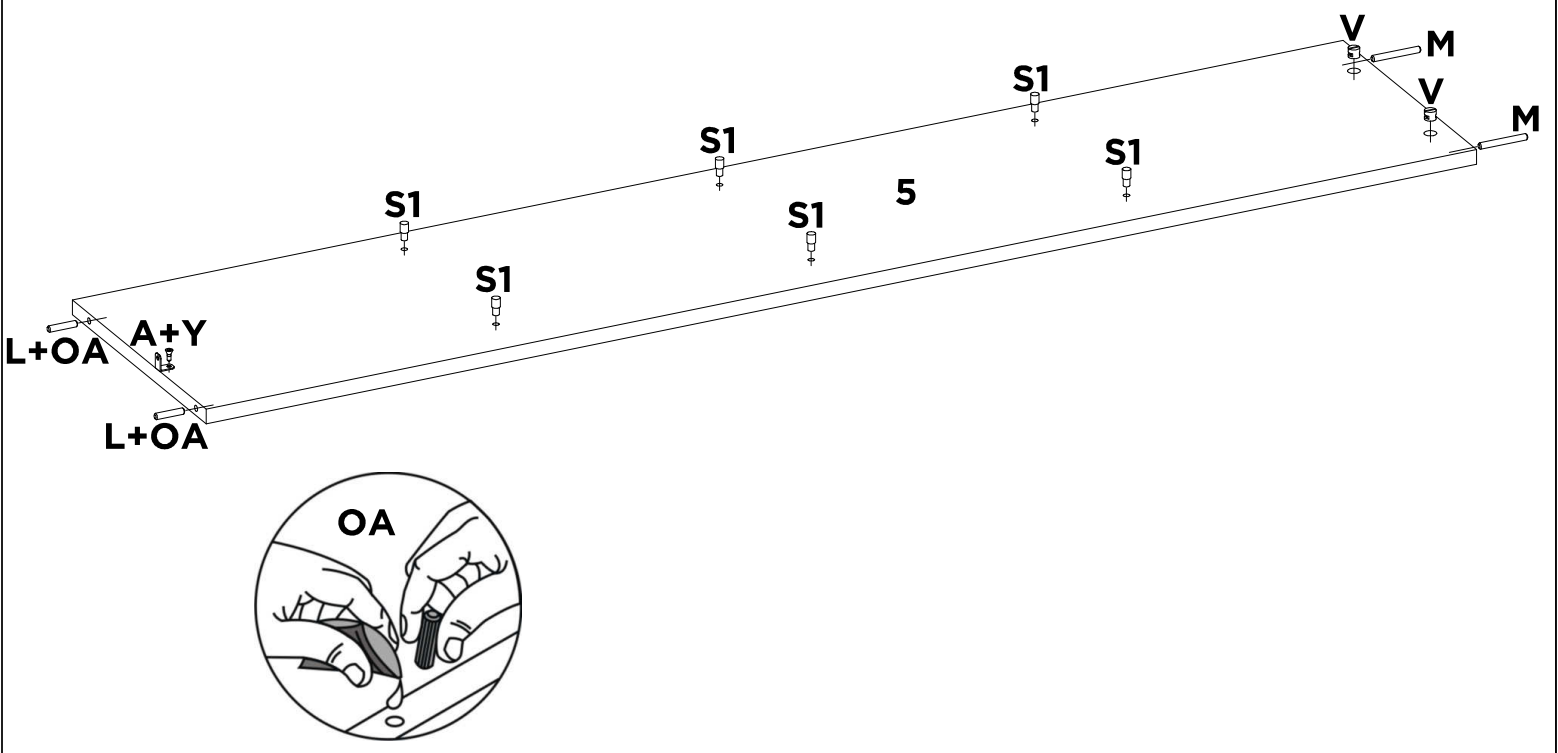

A	L	M	S1	V	Y	OA	-
X1	X2	X2	X6	X2	X1	-	-

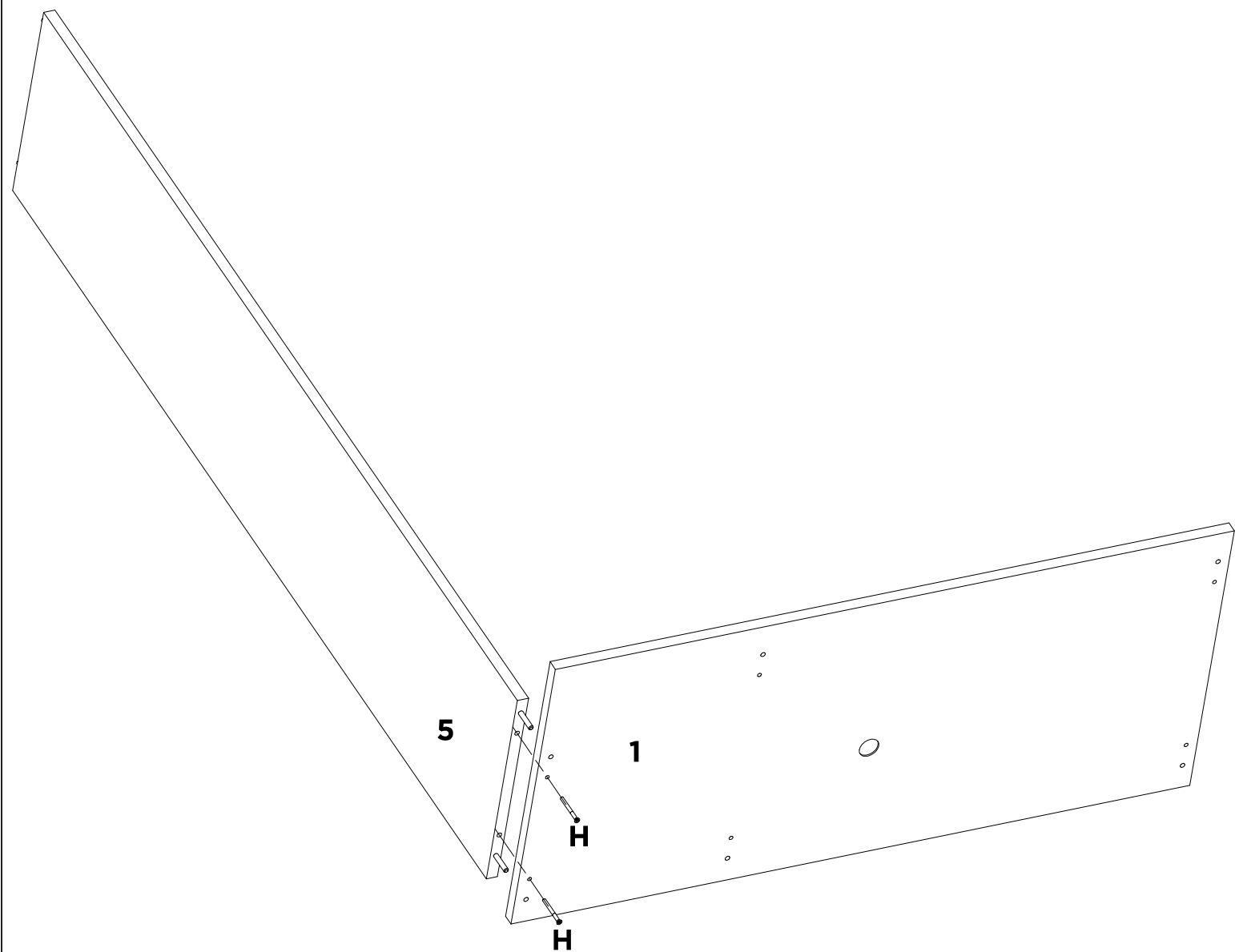

H	-	-	-	-	-	-	-
X2	-	-	-	-	-	-	-

03

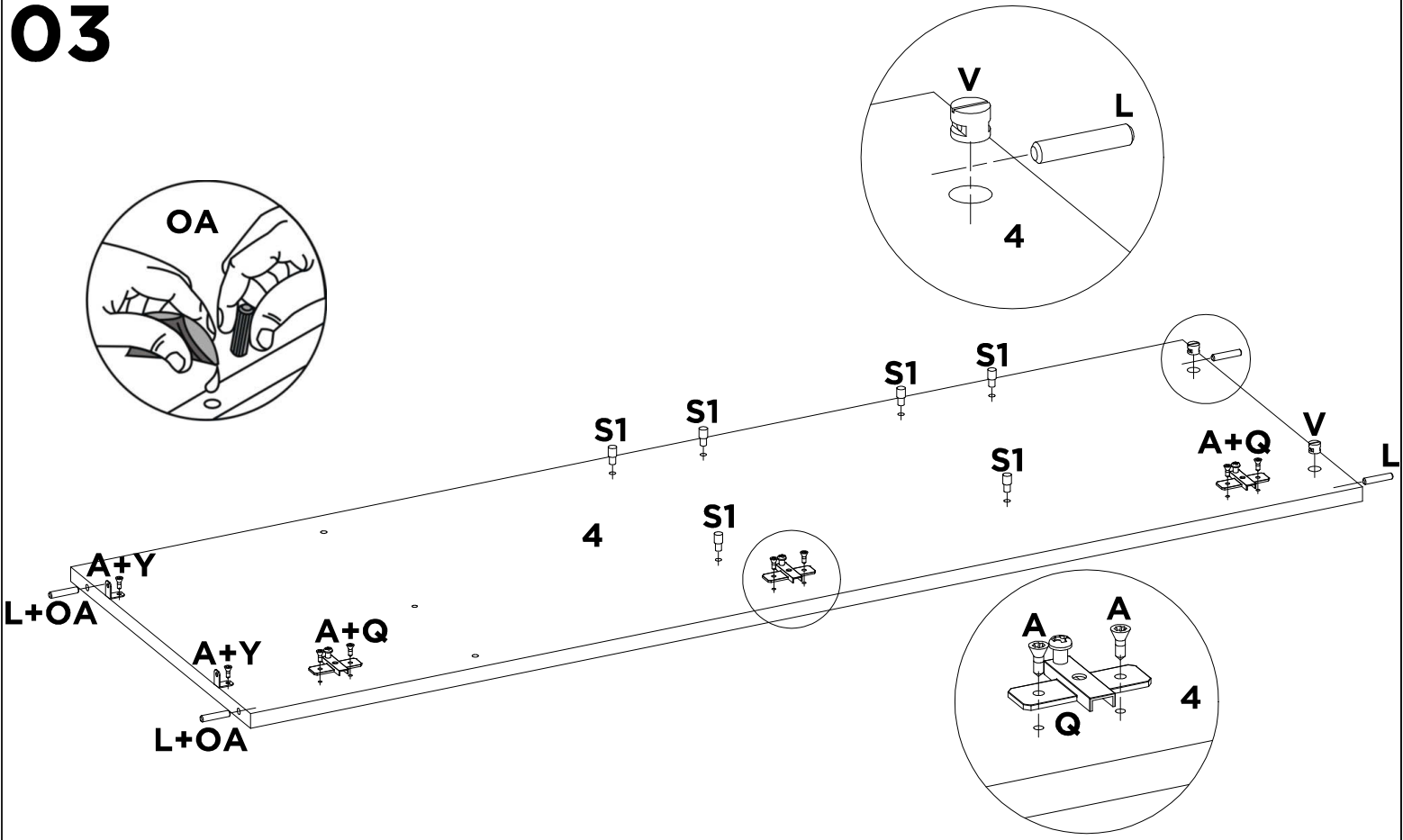

A	L	Q	S1	V	Y	OA	-
X8	X4	X3	X6	X2	X2	-	-

03A

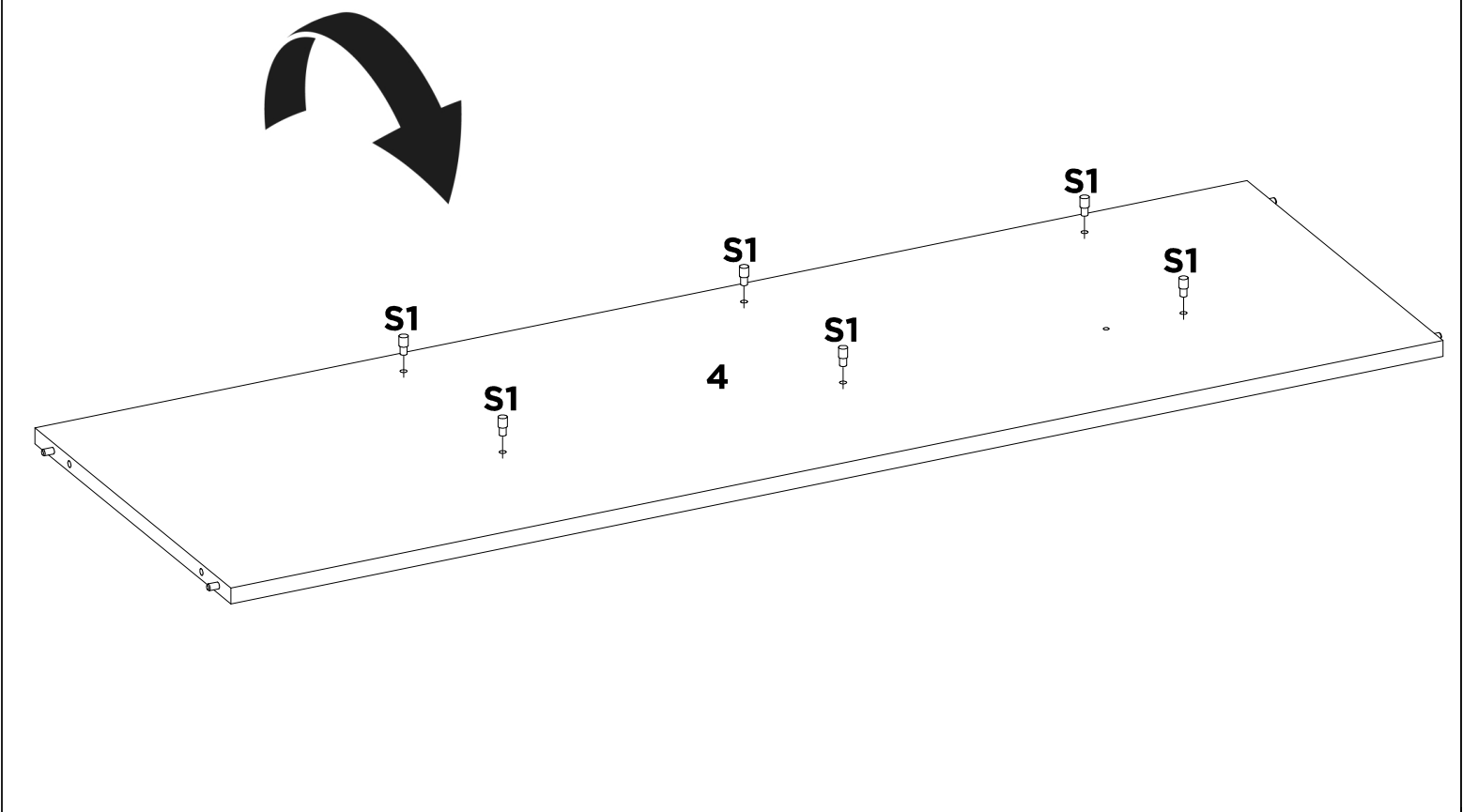
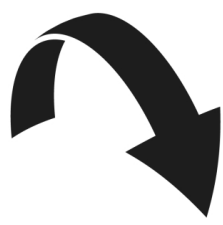

S1	-	-	-	-	-	-	-
X6	-	-	-	-	-	-	-

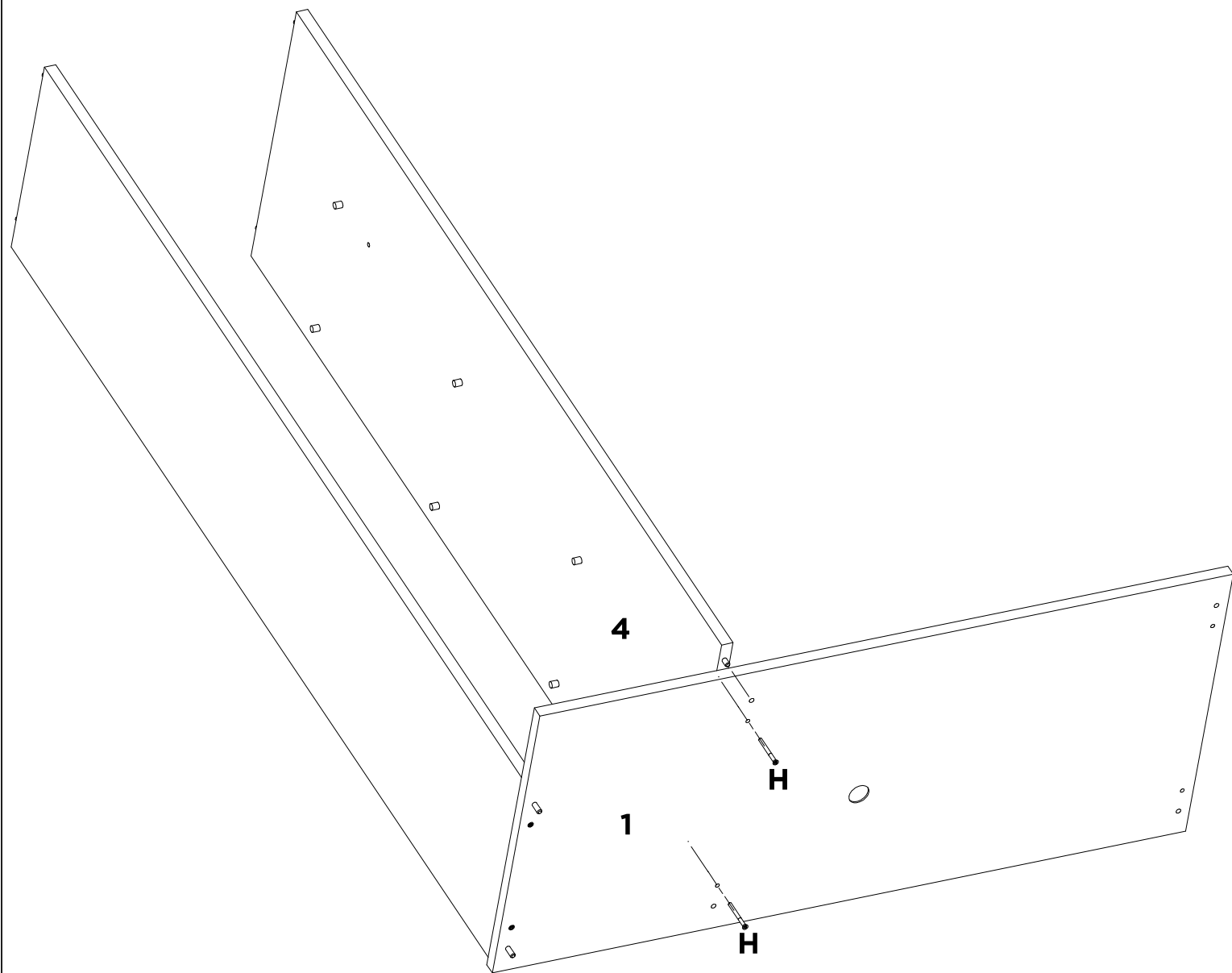

H

X2

-

-

-

-

-

-

-

-

-

-

-

-

-

-

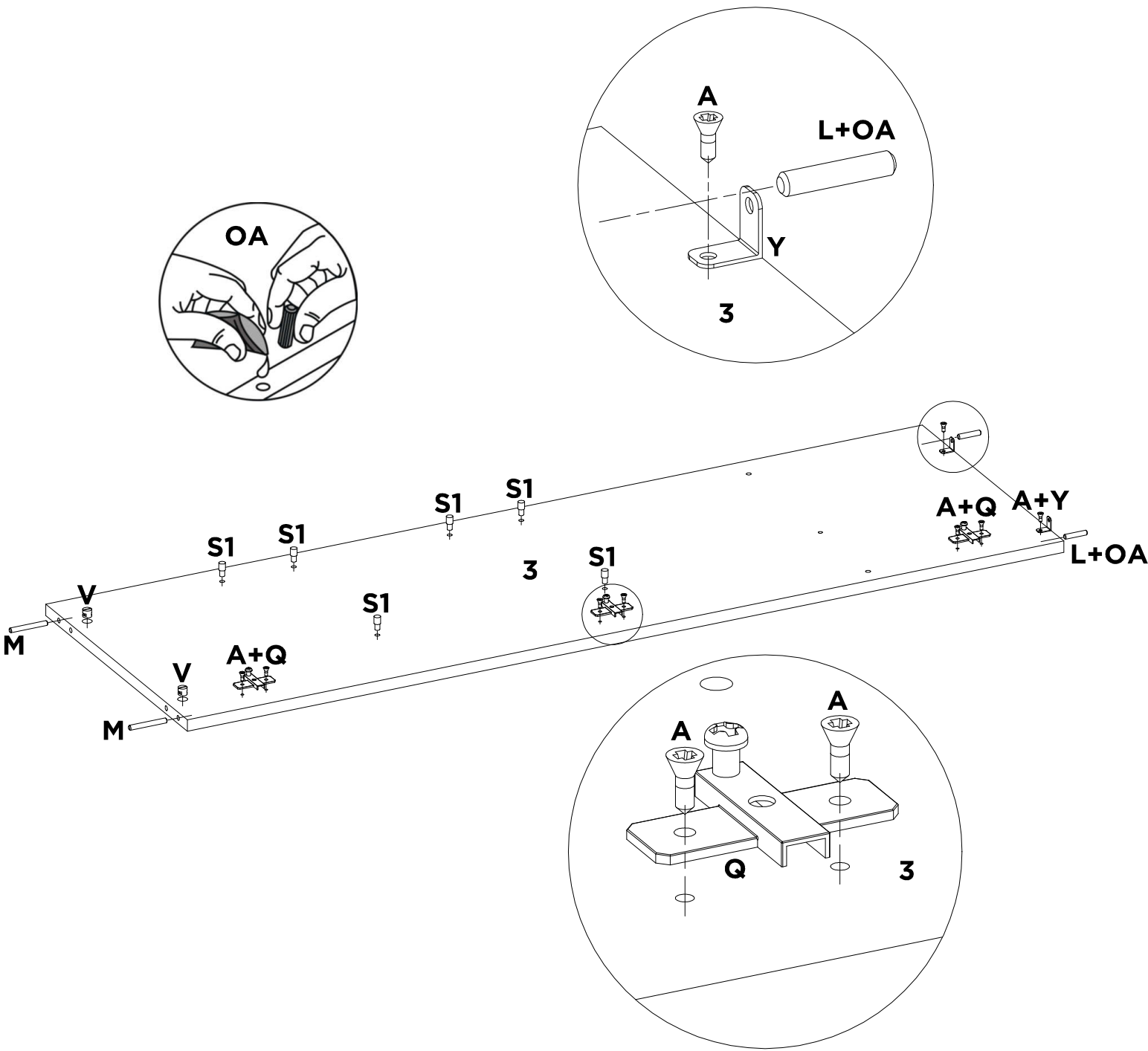

A	L	M	Q	S1	V	Y	OA
X8	X2	X2	X3	X6	X2	X2	-

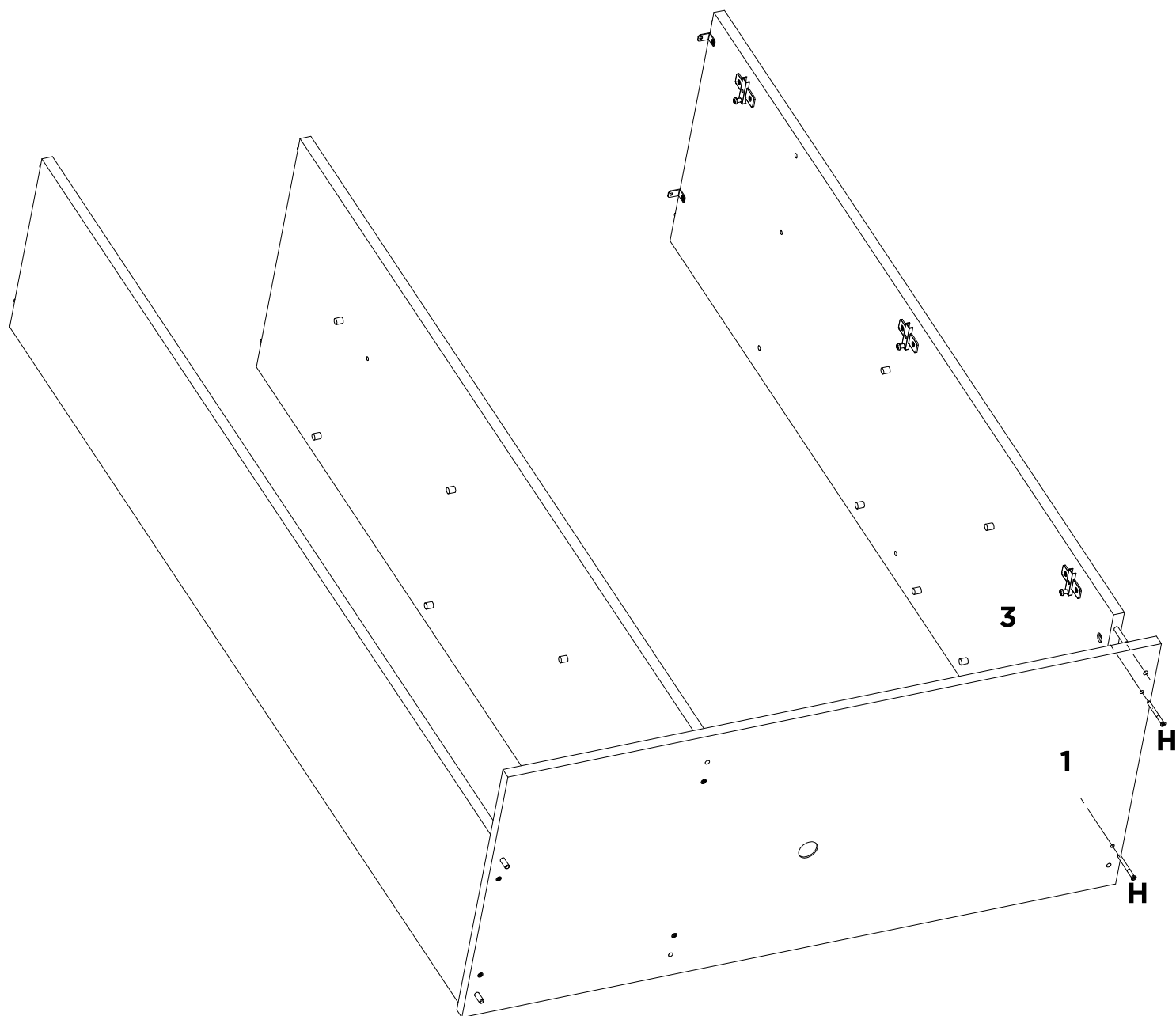

H

X2

-

-

-

-

-

-

-

-

-

-

-

-

-

-

07

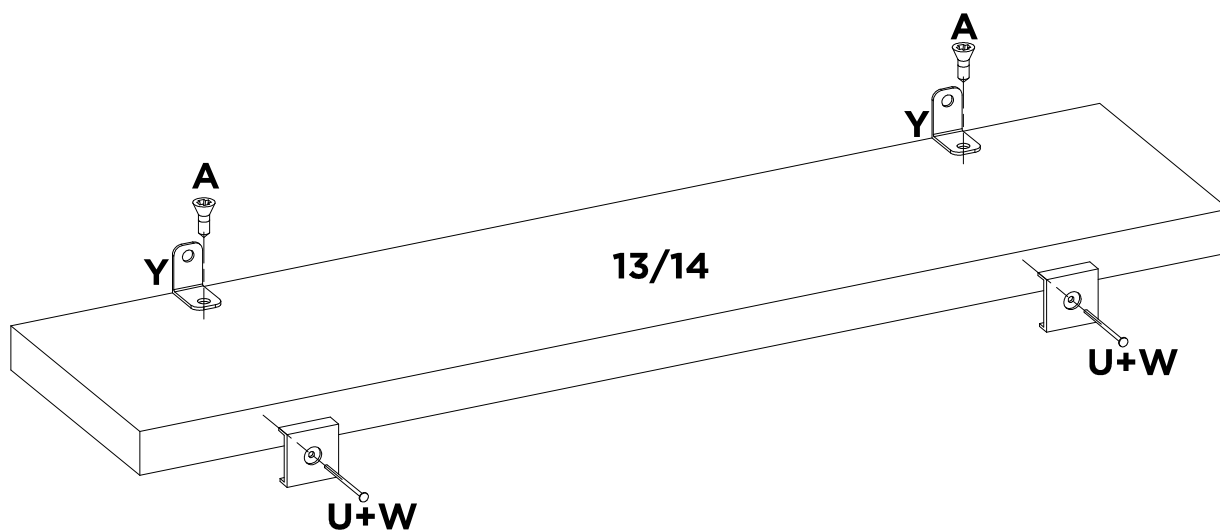

A	U	W	Y	-	-	-	-
X4	X4	X4	X4	-	-	-	-

07A

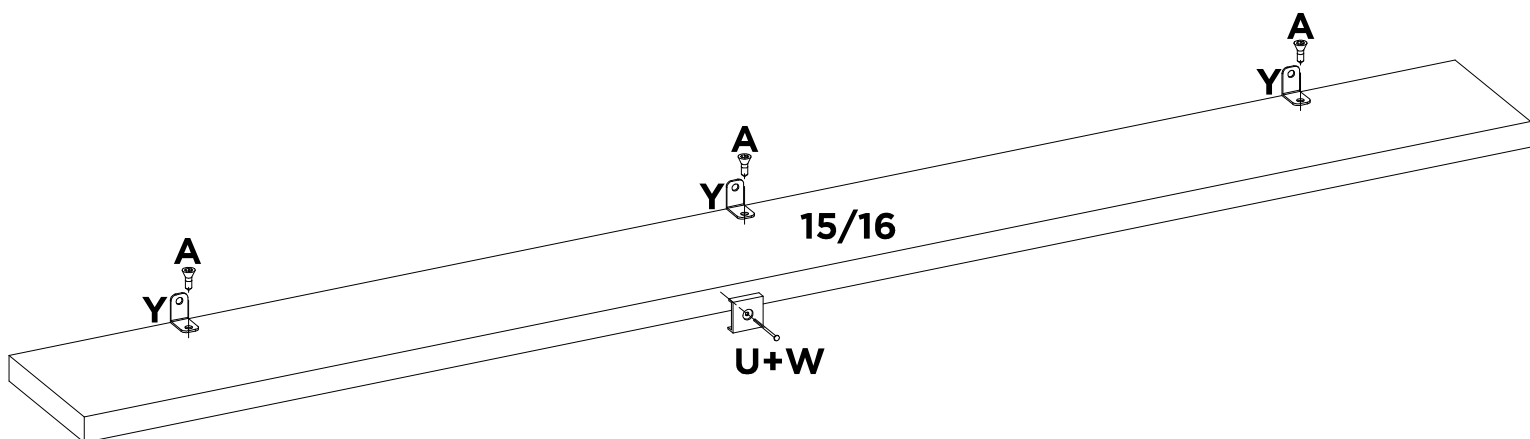

A	U	W	Y	-	-	-	-
X6	X2	X2	X6	-	-	-	-

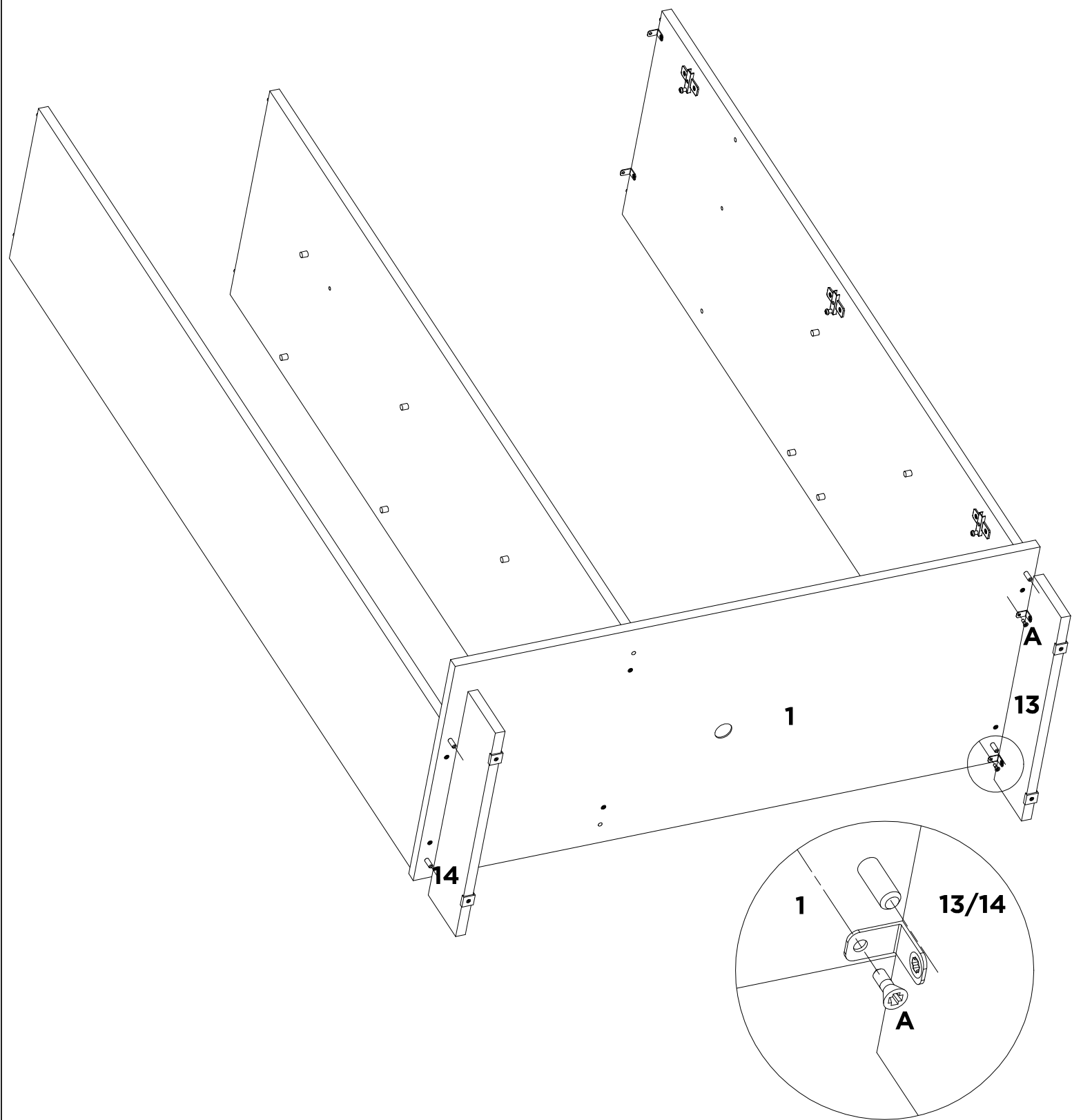

A	-	-	-	-	-	-	-
X4	-	-	-	-	-	-	-

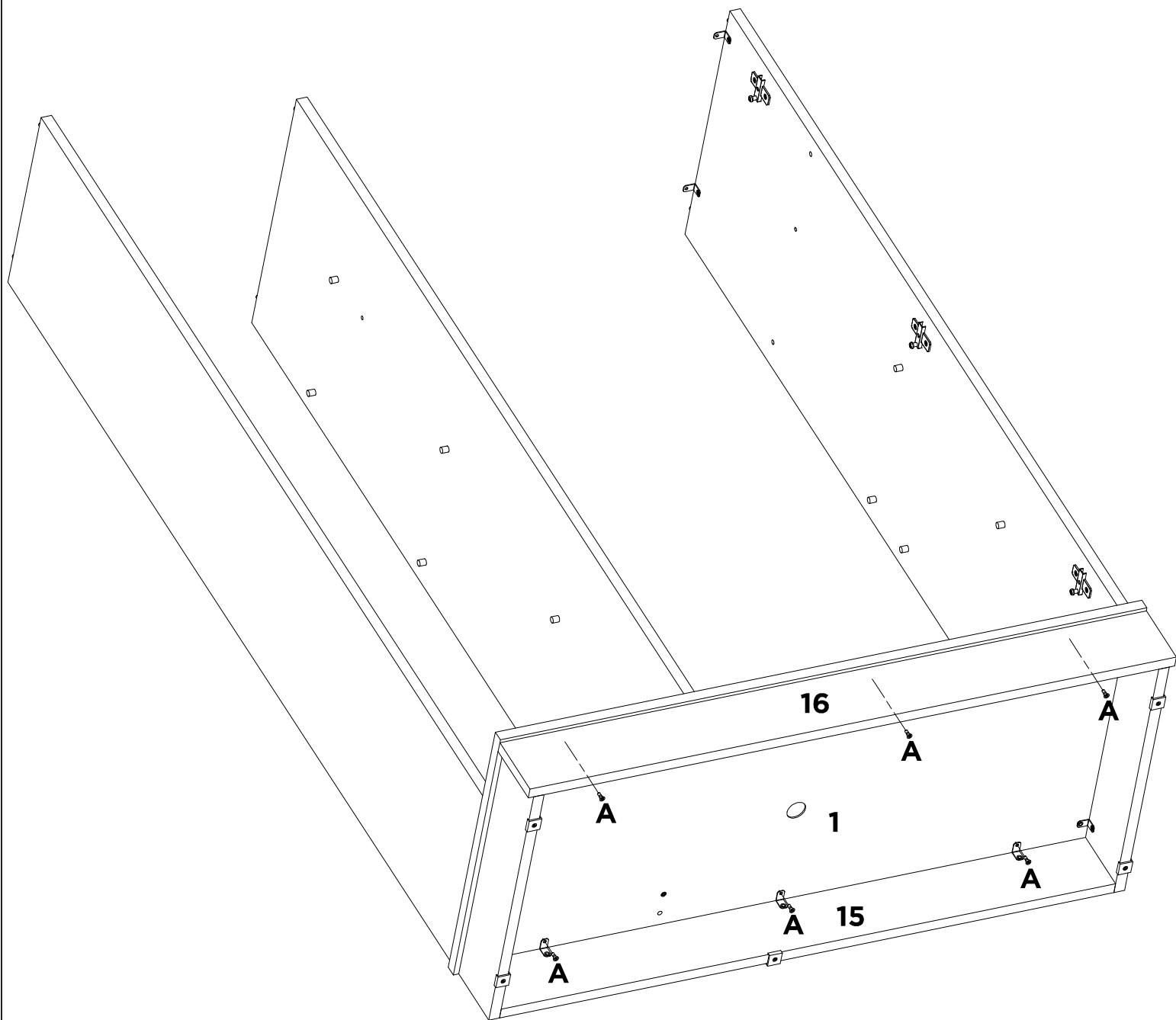

A	-	-	-	-	-	-	-
X6	-	-	-	-	-	-	-

10

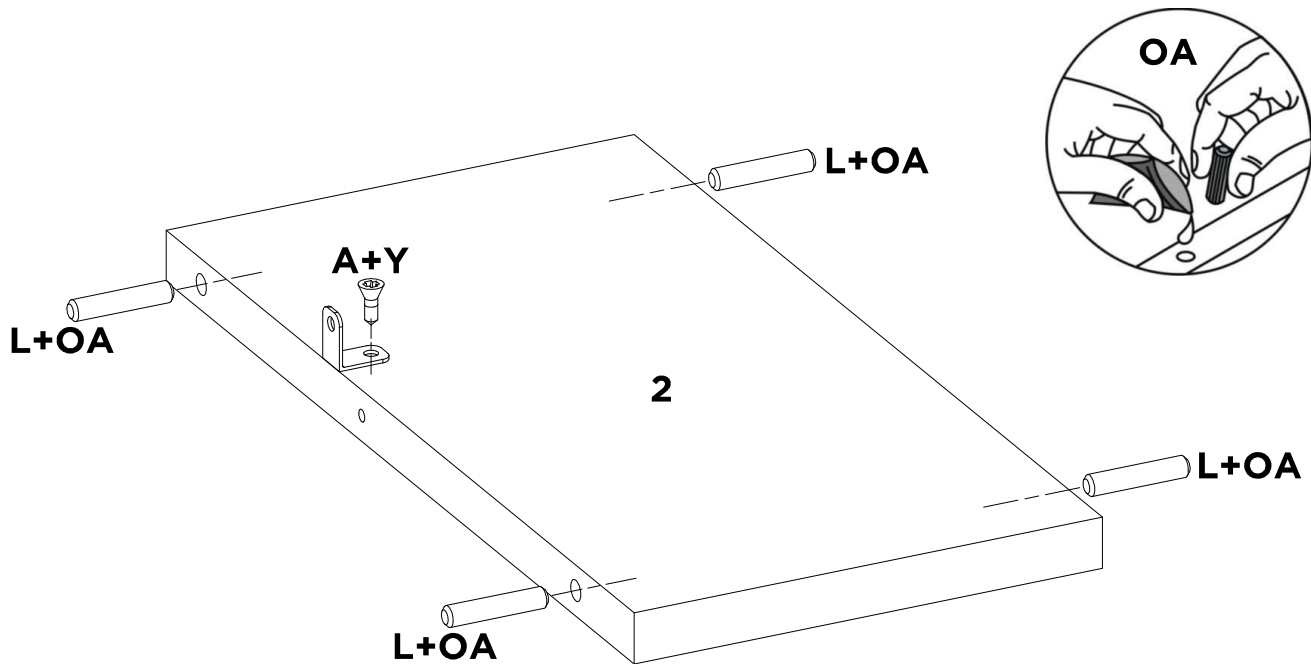

A	L	Y	OA	-	-	-	-
X1	X4	X1	-	-	-	-	-

10A

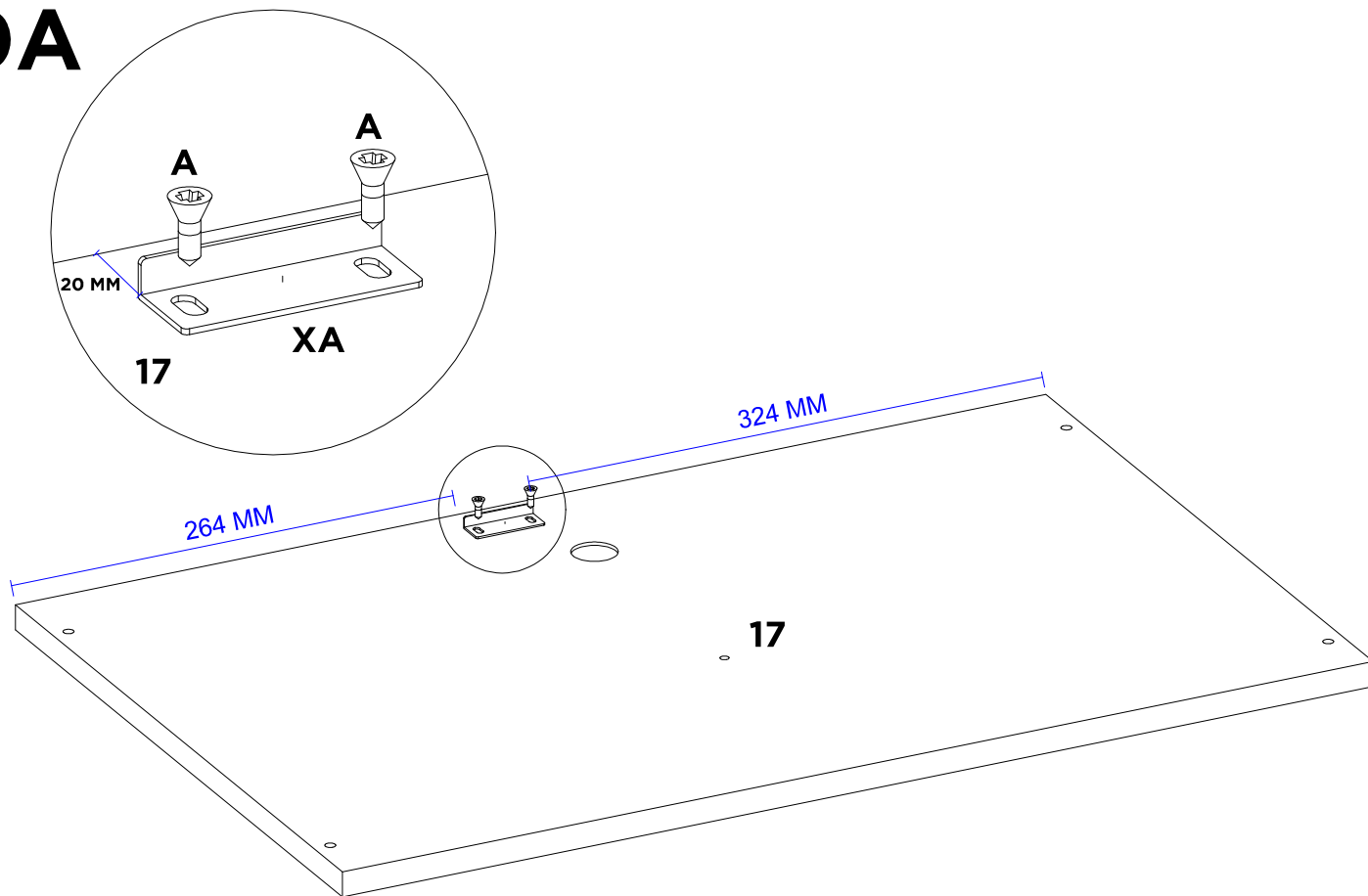

A	XA	-	-	-	-	-	-
X2	X1	-	-	-	-	-	-

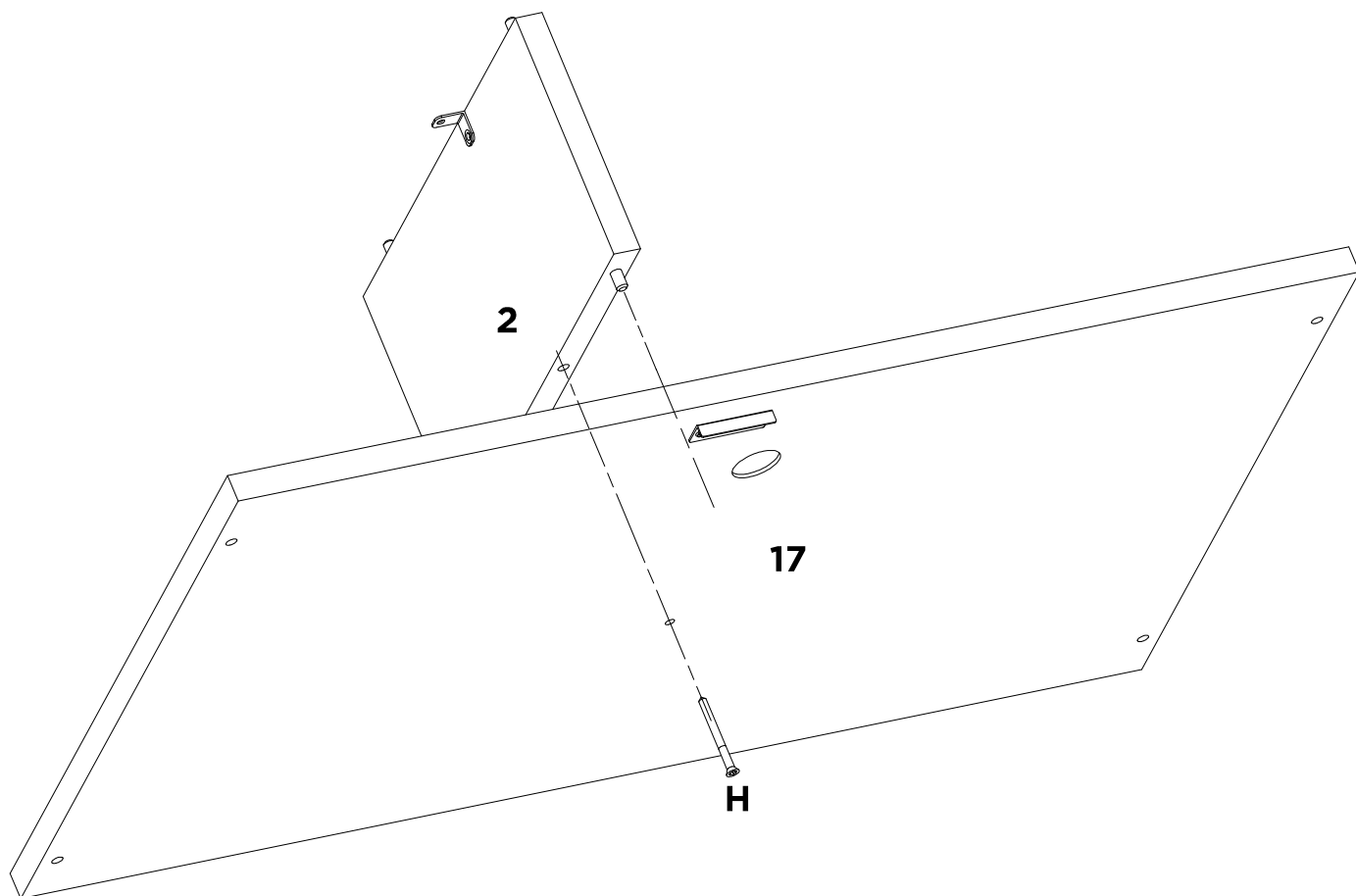

H	-	-	-	-	-	-	-
X1	-	-	-	-	-	-	-

12

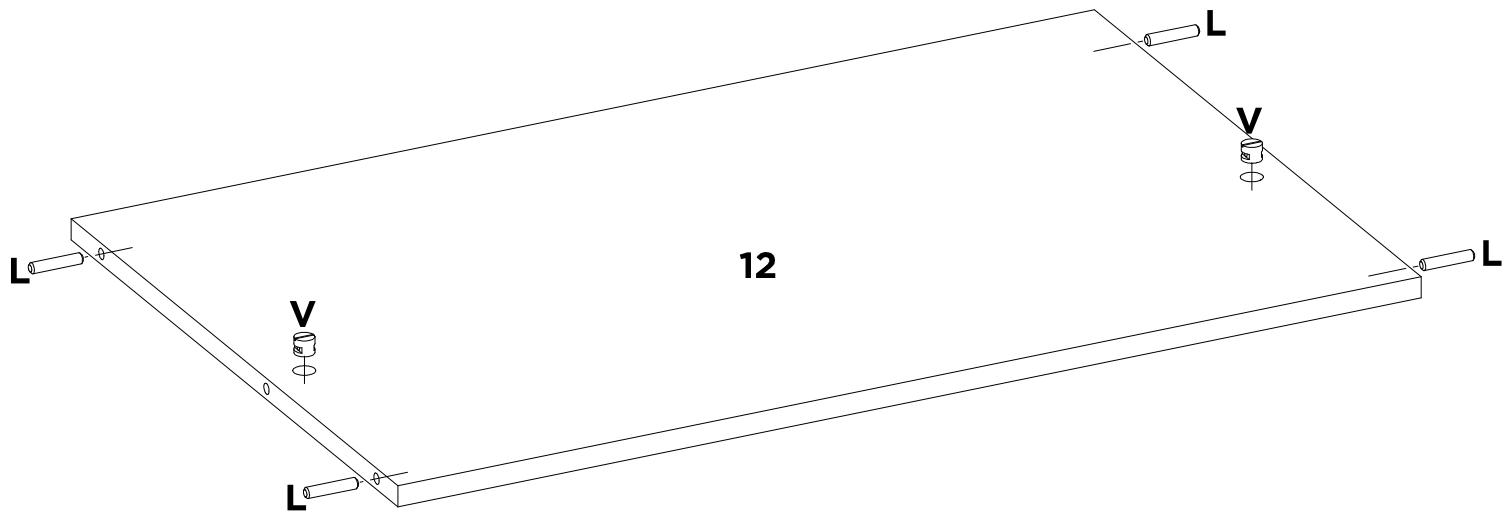

L	V	-	-	-	-	-	-
X4	X2	-	-	-	-	-	-

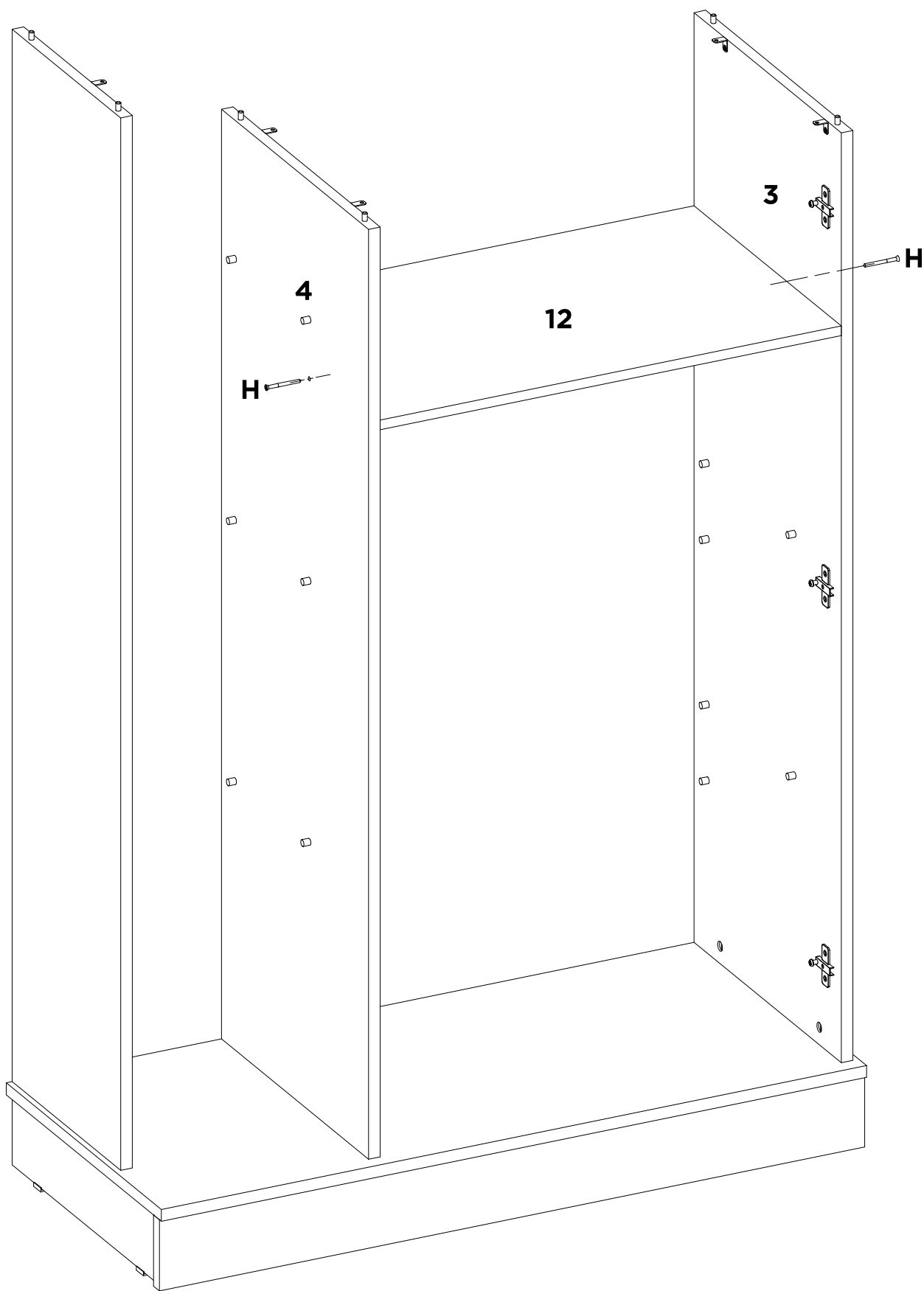

H	-	-	-	-	-	-	-
X2	-	-	-	-	-	-	-

14

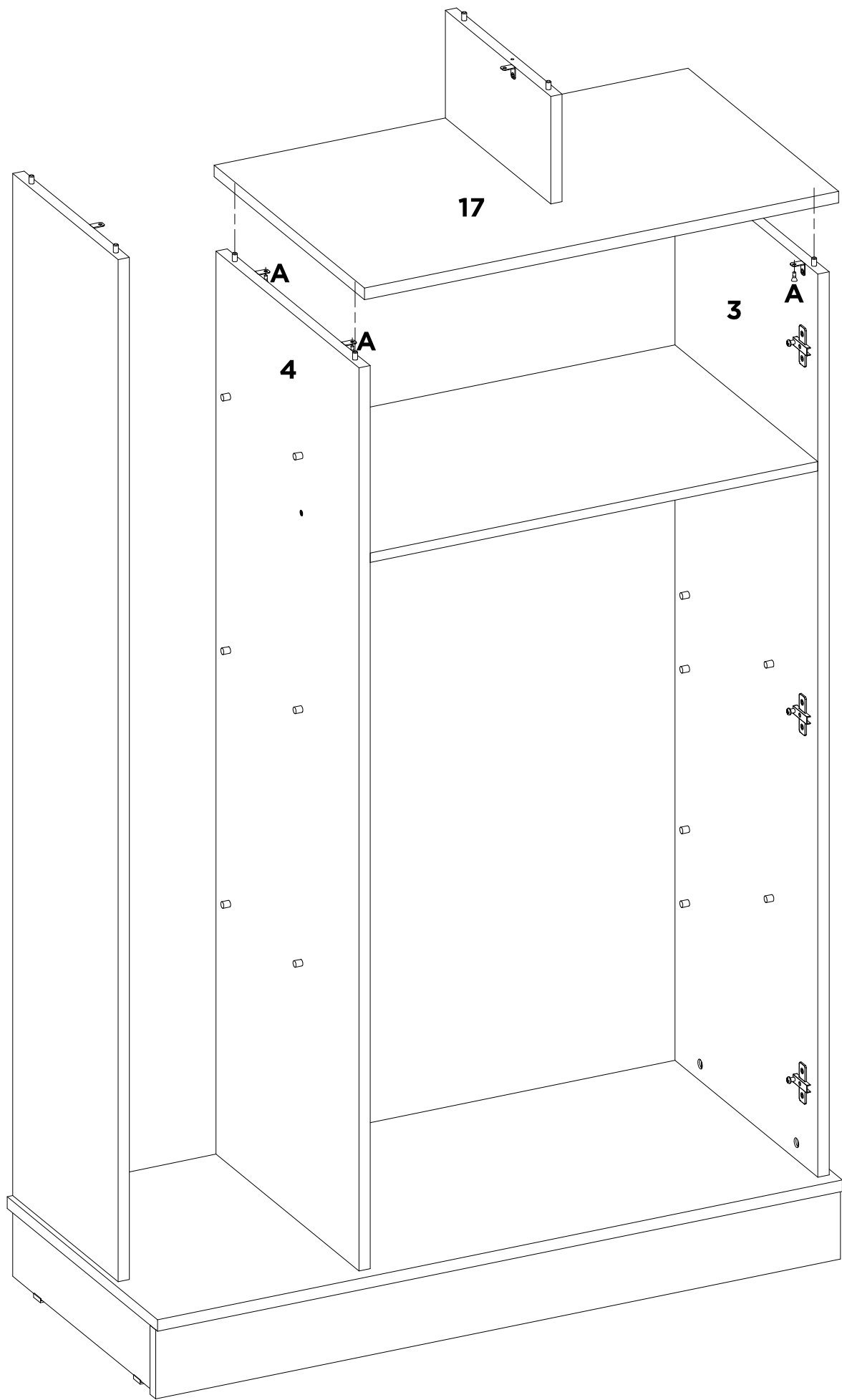

A	-	-	-	-	-	-	-
X4	-	-	-	-	-	-	-

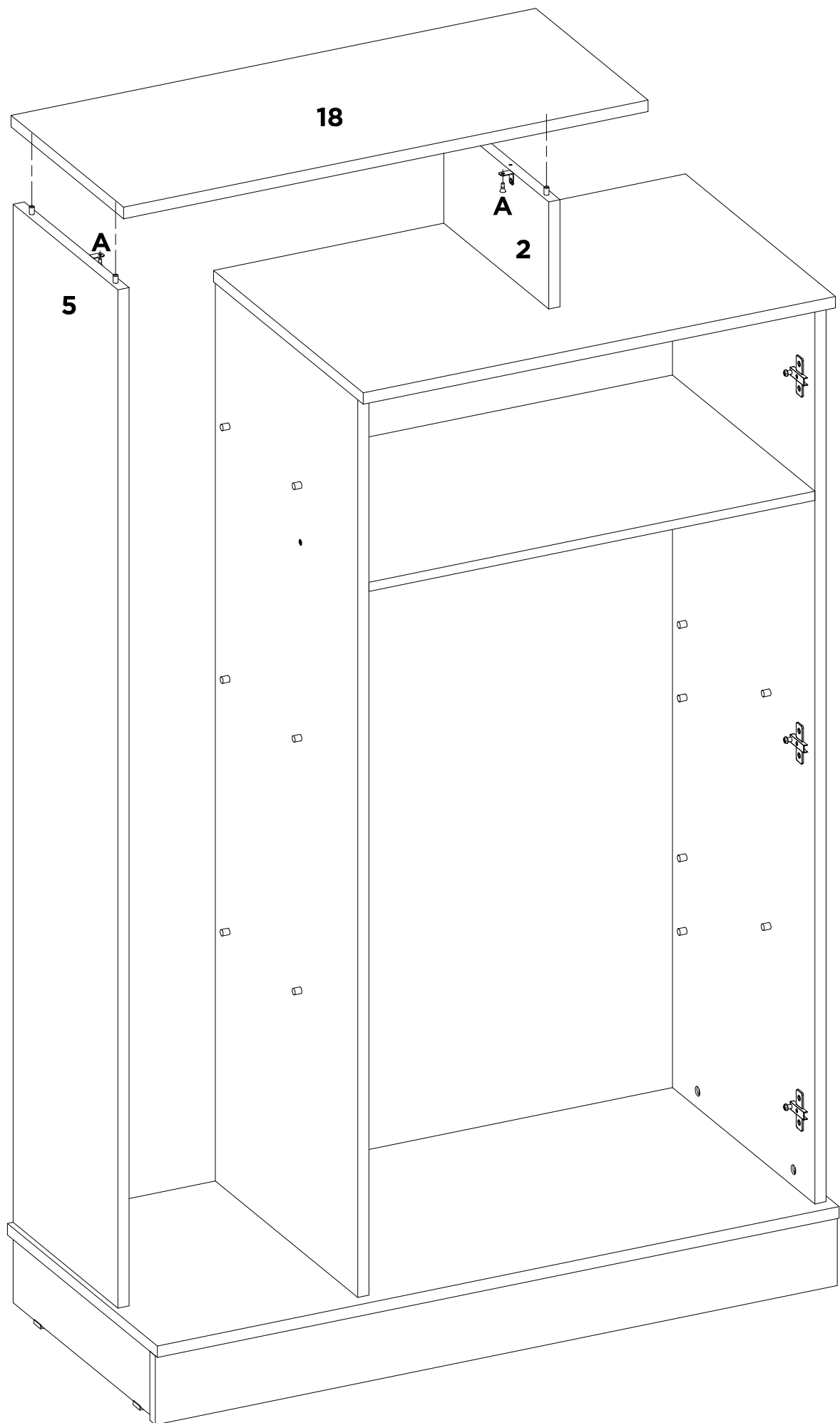

A	OA	-	-	-	-	-	-
X2	X1	-	-	-	-	-	-

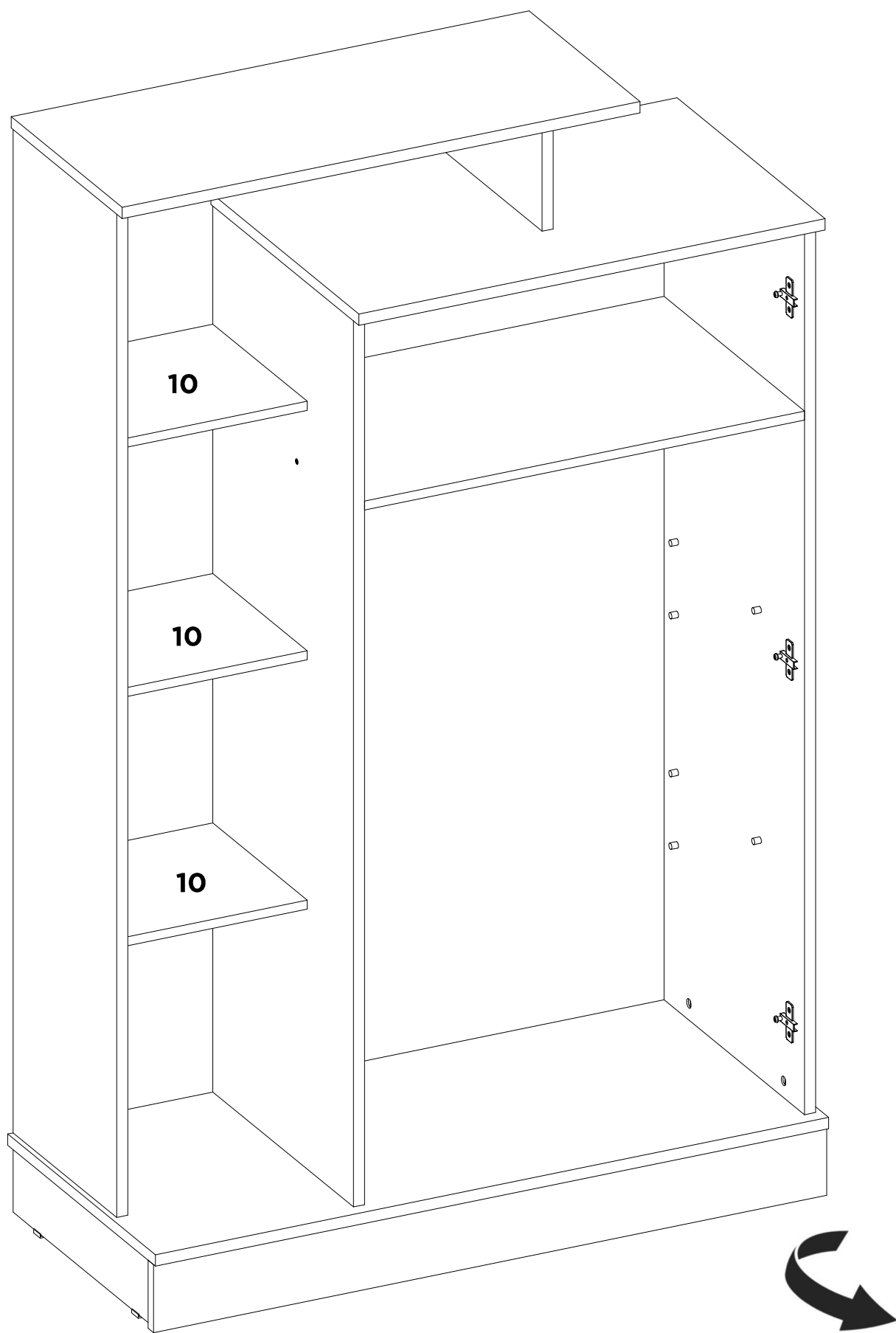

-	-	-	-	-	-	-	-
-	-	-	-	-	-	-	-

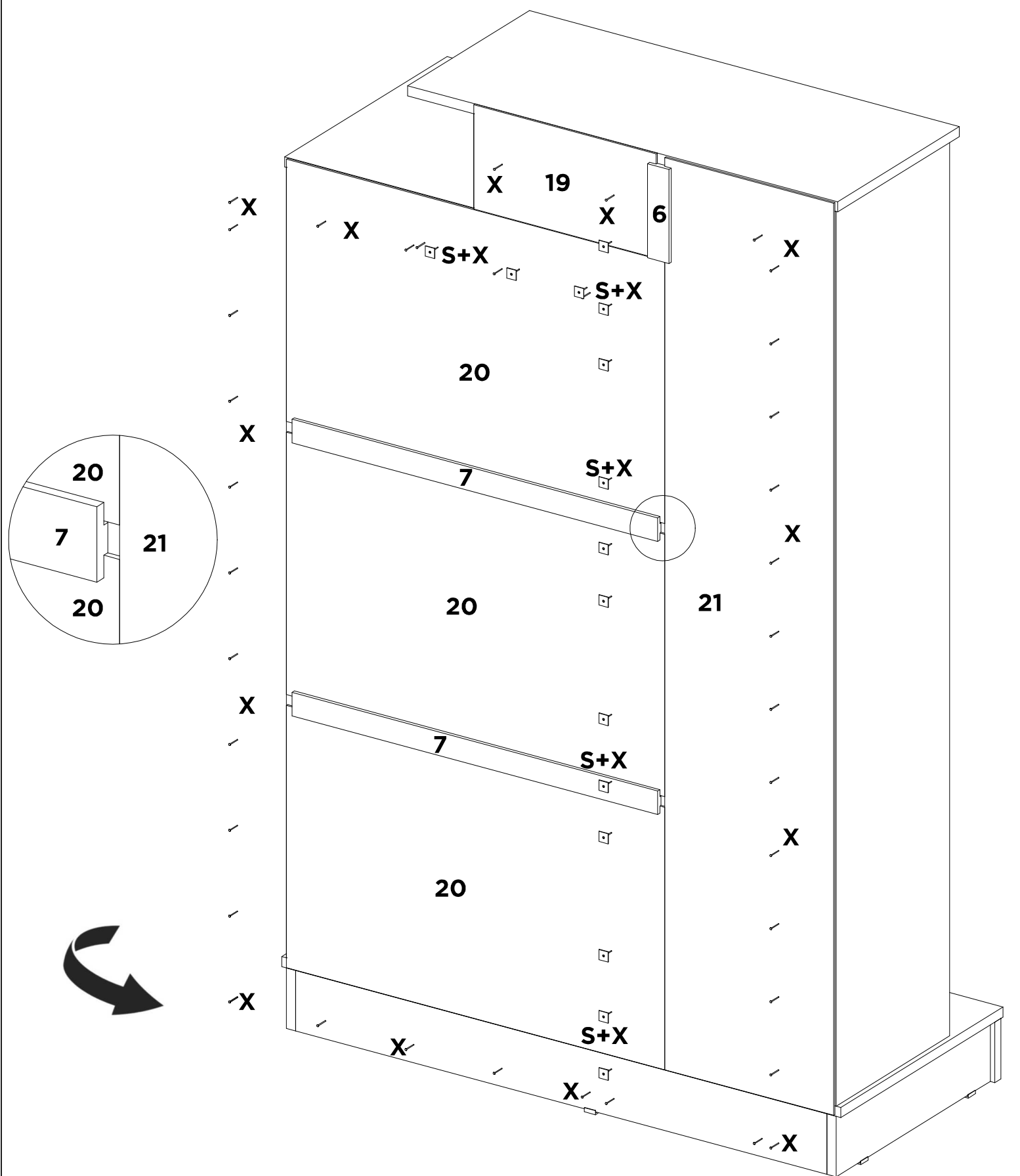

S	X	-	-	-	-	-	-
X15	X60	-	-	-	-	-	-

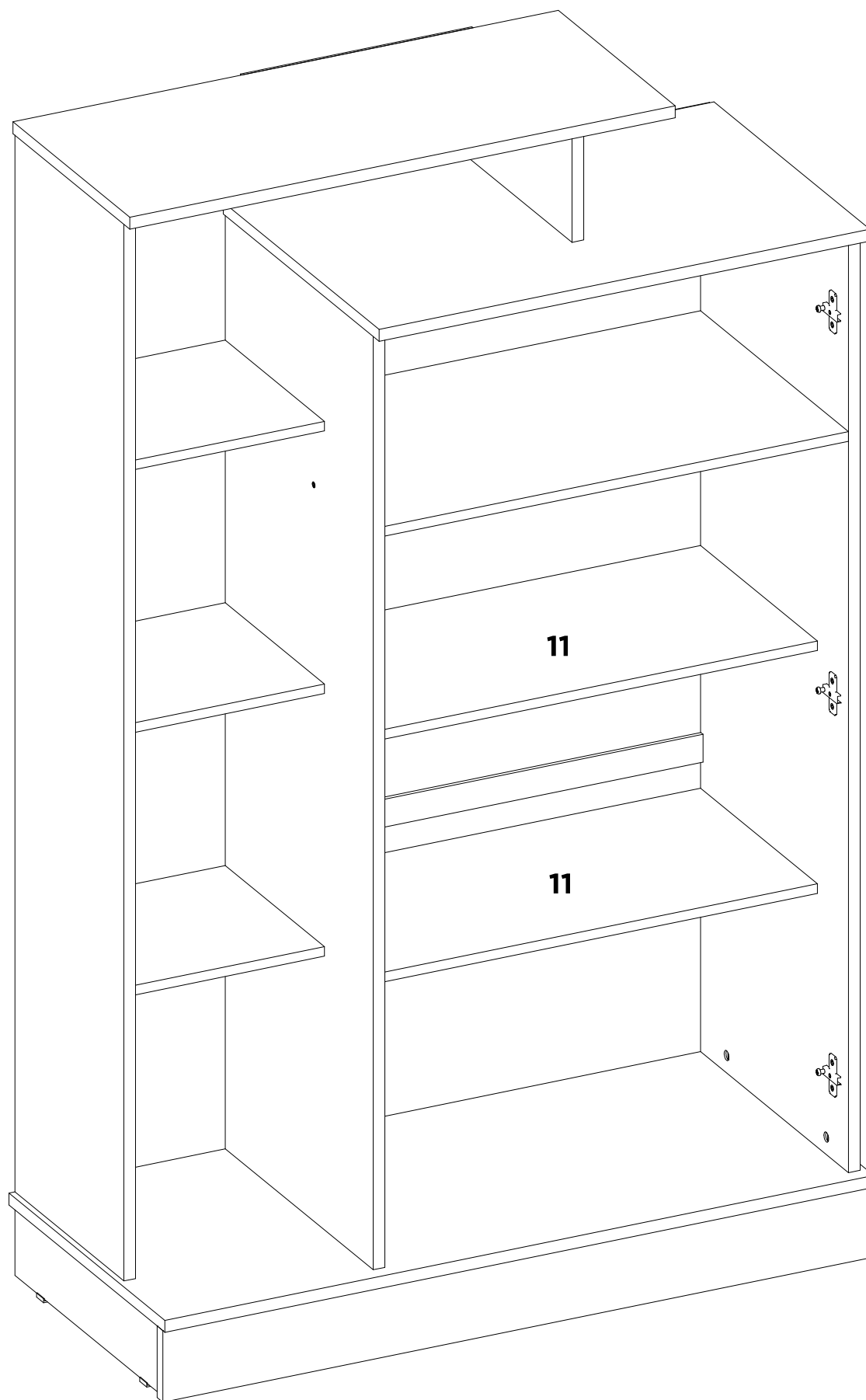

-	-	-	-	-	-	-	-
-	-	-	-	-	-	-	-

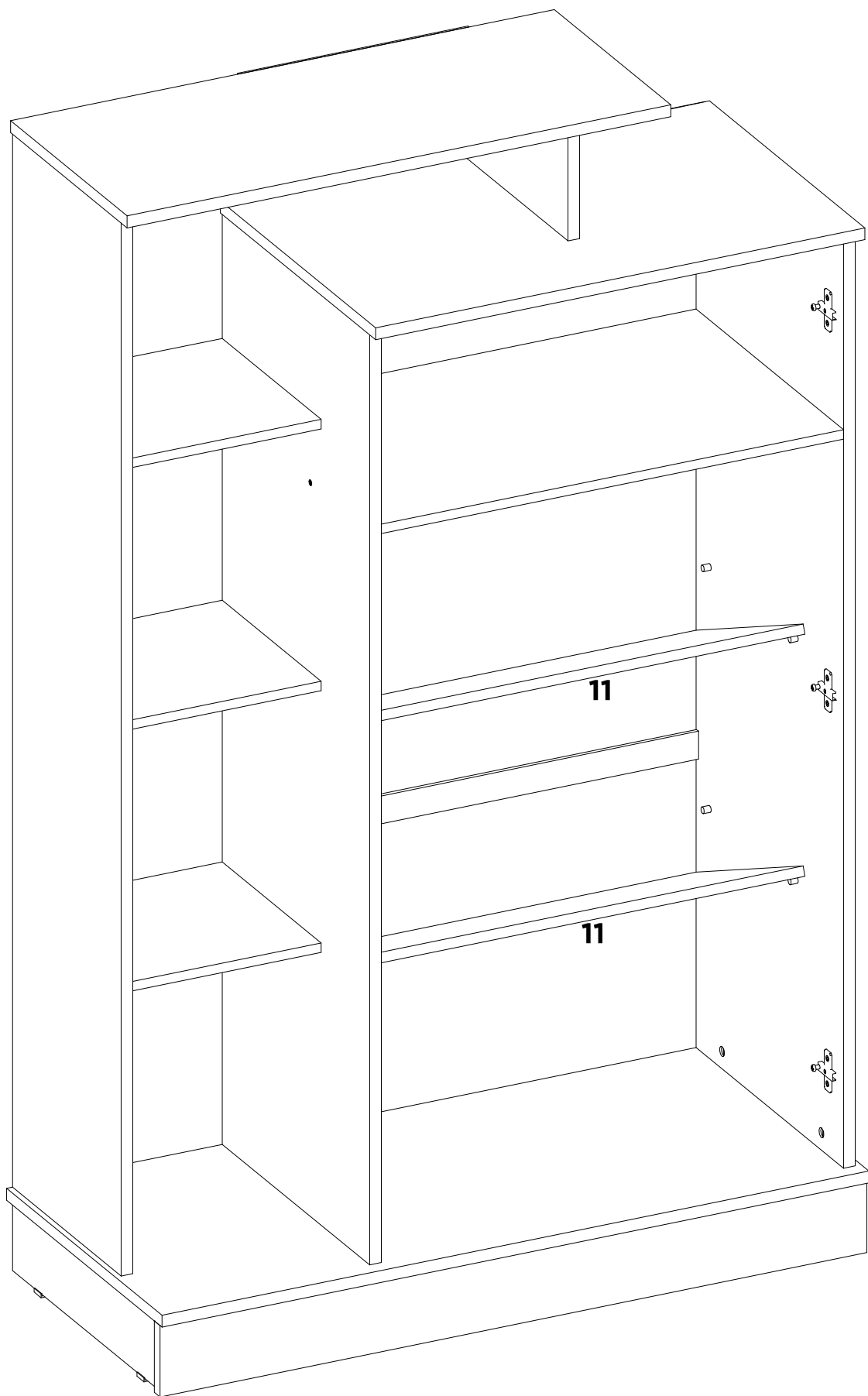

-	-	-	-	-	-	-	-
-	-	-	-	-	-	-	-

20

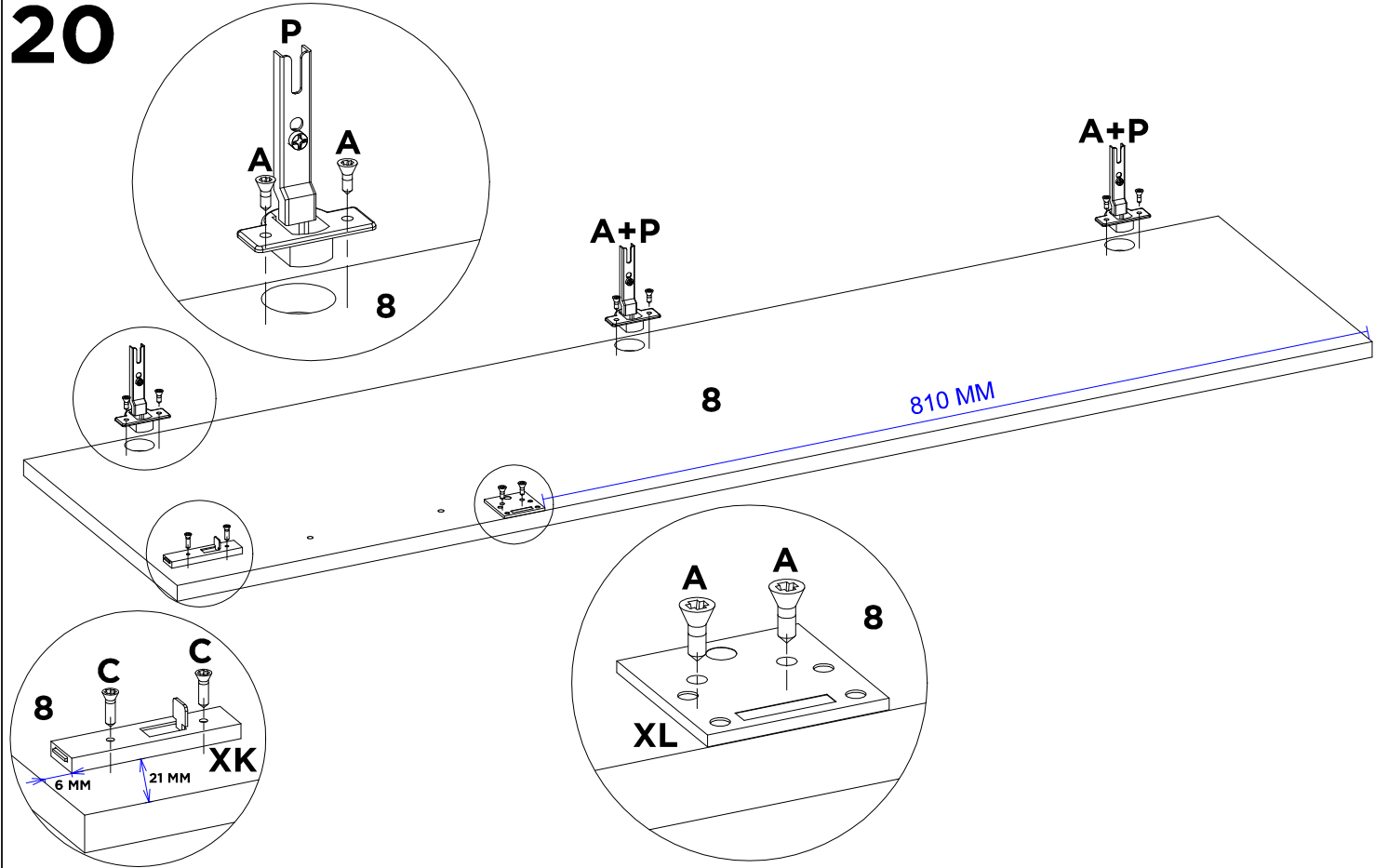

A	C	P	XK	XL	-	-	-
X8	X2	X3	X1	X1	-	-	-

20A

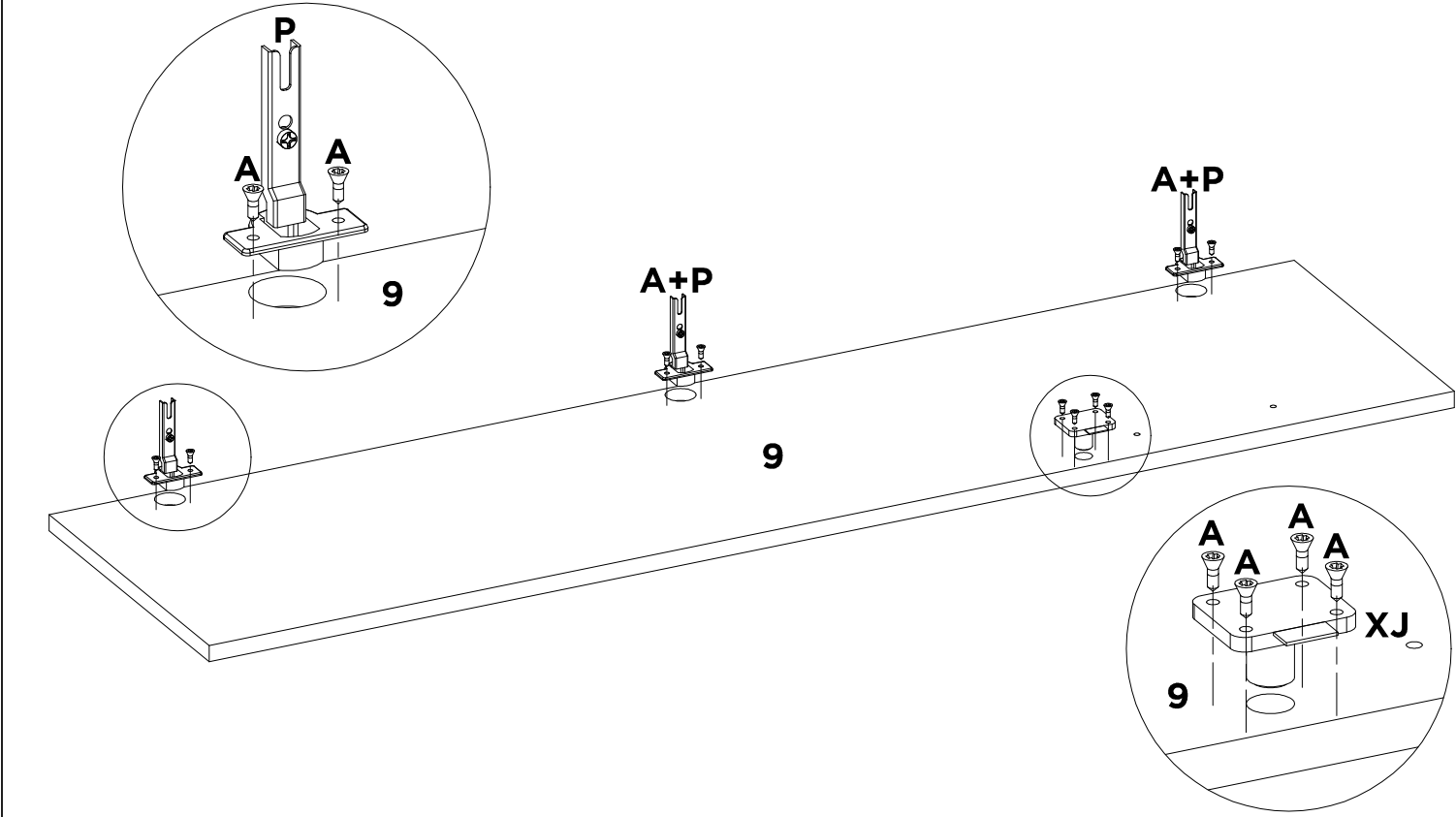

A	P	XJ	-	-	-	-	-
X10	X3	X1	-	-	-	-	-

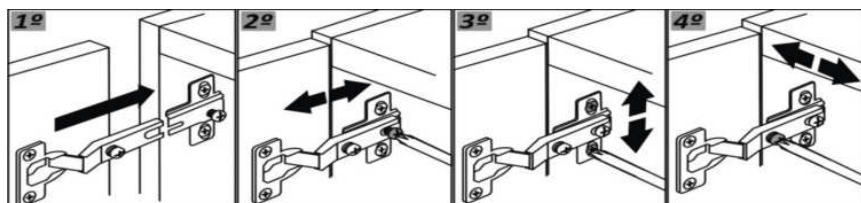
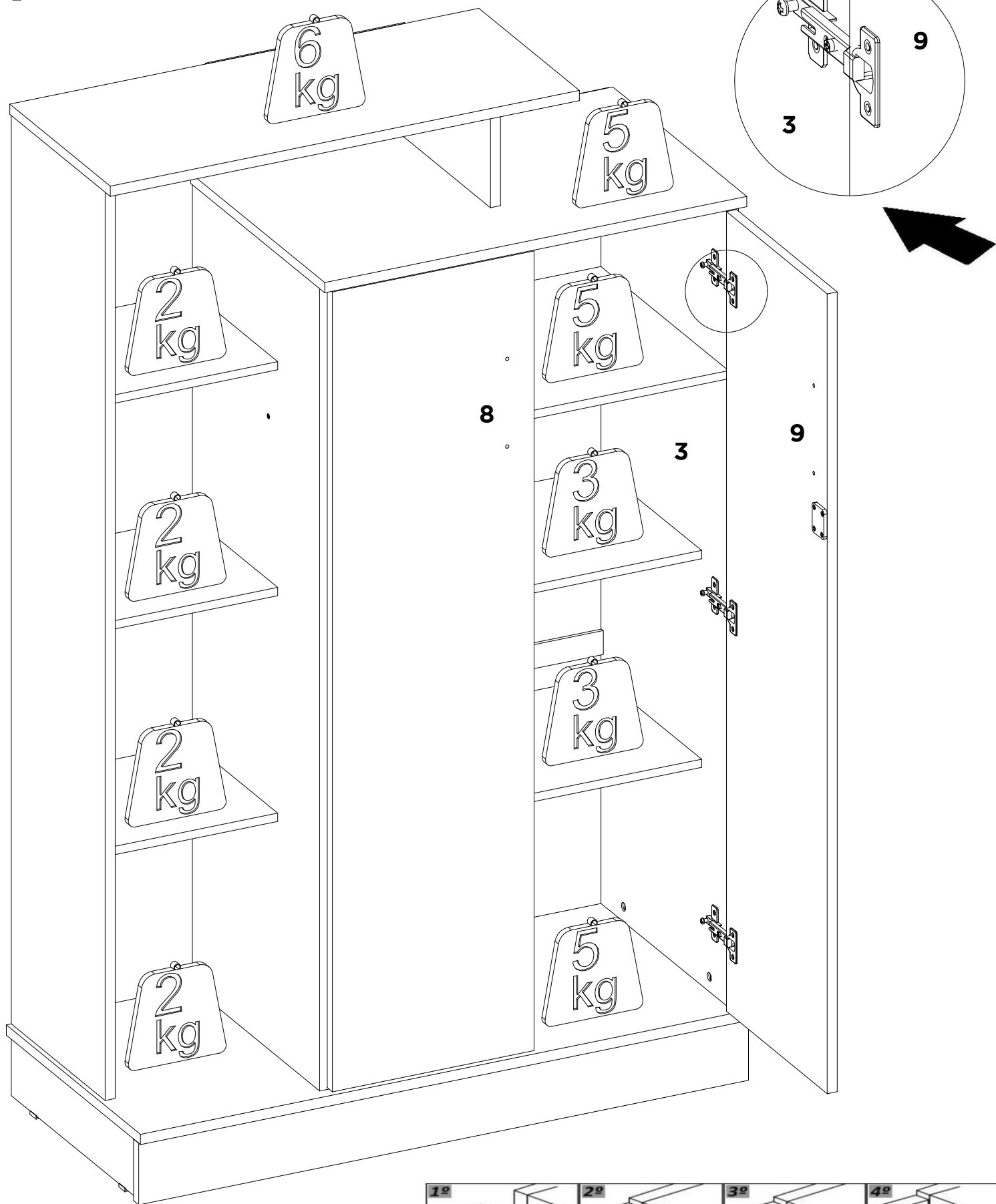

-	-	-	-	-	-	-	-
-	-	-	-	-	-	-	-

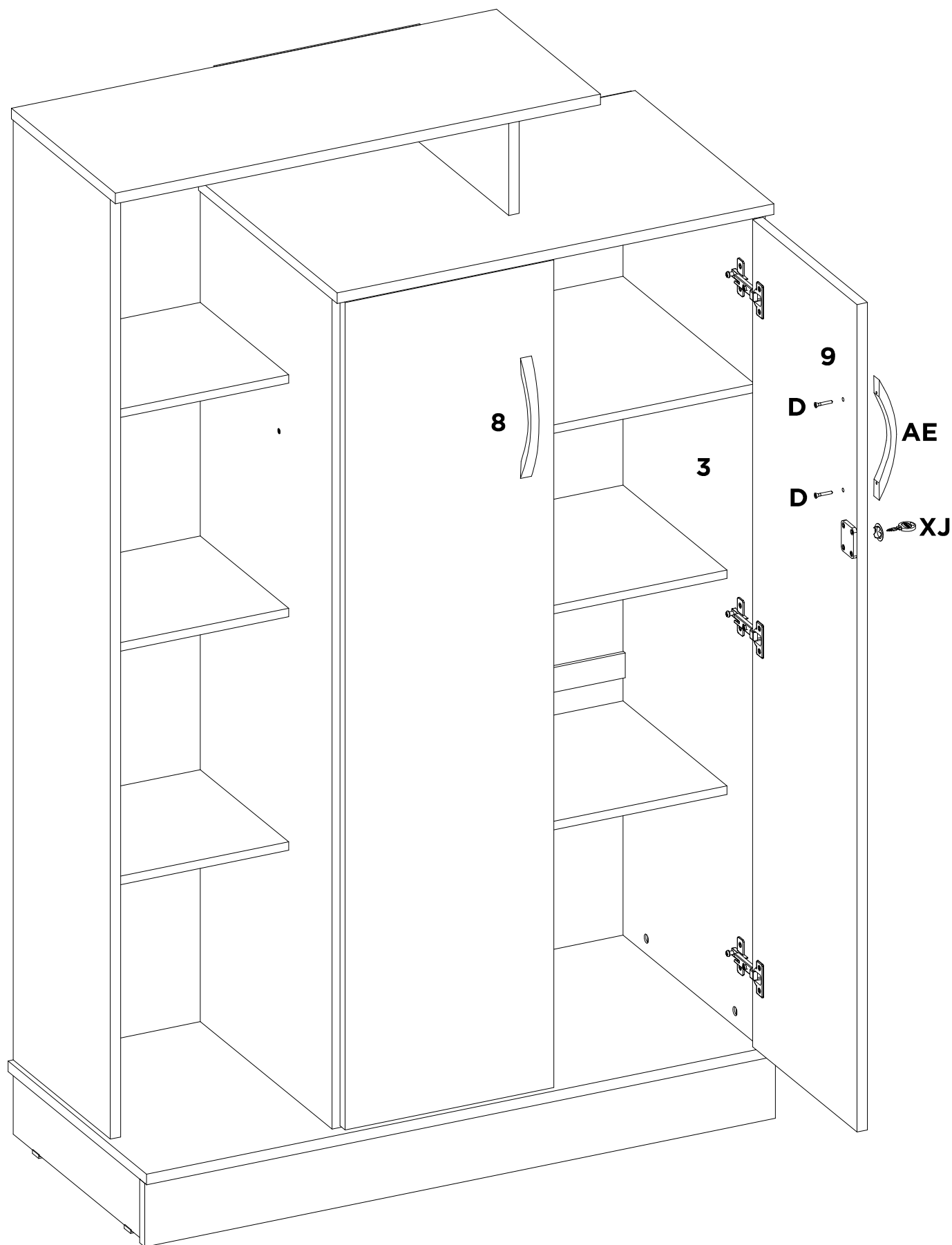

AE	A12	XJ	-	-	-	-	-
X2	X4	X1	-	-	-	-	-

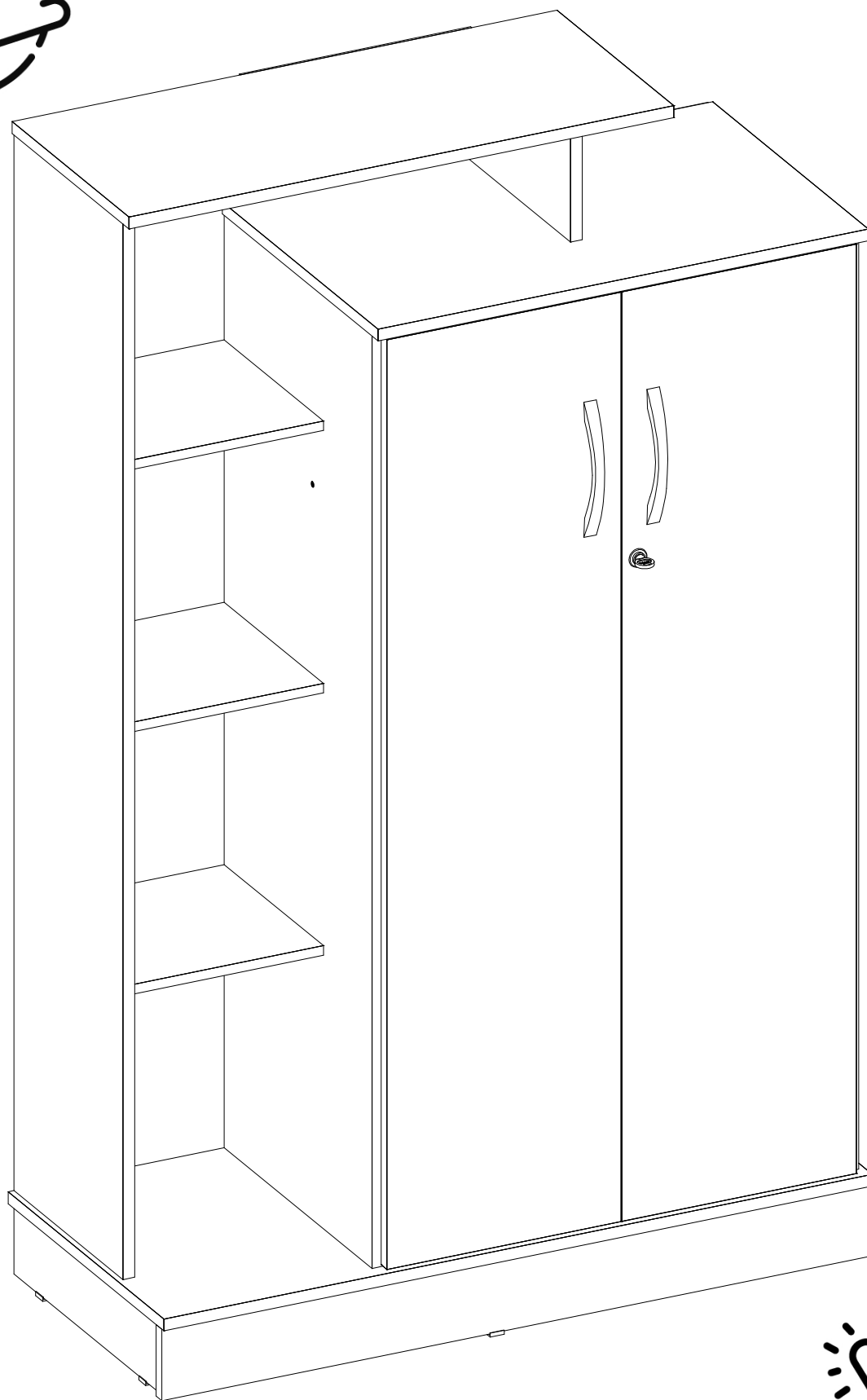

-	-	-	-	-	-	-	-
-	-	-	-	-	-	-	-



DemóBILE