

INSTRUÇÕES DE MONTAGEM INSTRUCCIONES DE MONTAJE

Nova Móvel Ind. e Comércio Ltda.
Estrada Pedro Salgado, nº 1620 - Fone: (54) 2105-8400 - Fax: (54) 2105-8401
CEP: 95706-500 - Bento Gonçalves - RS - Site: www.novamobile.com.br - E-mail: novamobile@novamobile.com.br

NOVA MÓVEL

B11

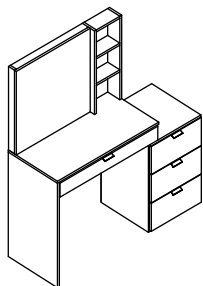

Ferragens/Herrajes

A		Tambor Minifix	07
B		Parafuso Minifix Tornillo Minifix	07
C		Prego Clavo	40
D		8,0x50	01
E		4,0x40	20
F		Sapata Zapata	06
G		8,0x30	76
H		Cantoneira metálica Pieza "L" metálica	08
I		Cantoneira metálica Pieza "L" metálica	07
J		4,0x25	08
K		Puxador met. cinza pint GS - PA00240 Tirador met. cinza pint GS - PA00240	04
L		3,5x14	54
M		3,5x12	32
N		350mm	04
O		Tapa furo adesivo Tapa agujero adhesivo	09
P		Bisnaga de cola Pegamento	01

Peças/Piezas

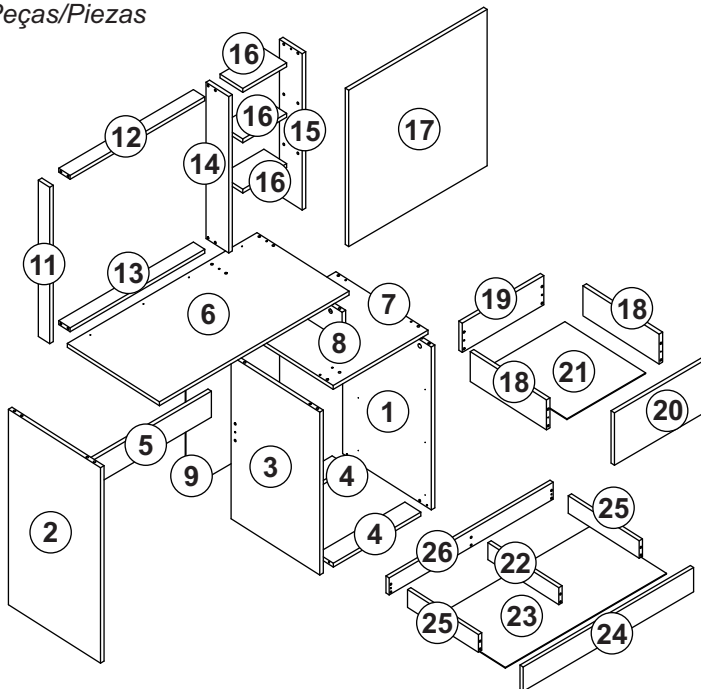

Loc.	Descrição/Descripción	Dimensão (mm) Dimensión (mm)	Qtde. Cantid.
1	Lateral dir. gav./Lateral derecha cajonero	625x390x15	01
2	Lateral inf. esquerda/Lateral inferior izquierda	750x405x15	01
3	Lateral esq. gav./Lateral izquierda cajonero	665x390x15	01
4	Rodapé/Zócalo	369x70x15	02
5	Travessa reforço/Travesaño refuerzo	716x100x15	01
6	Tampo/Tapa	800x405x15	01
7	Tampo gaveteiro/Tapa cajonero	400x405x15	01
8	Lateral inf. direita/Lateral inferior derecha	110x390x15	01
9	Costa gaveteiro/Revés cajonero	630x395x3	01
11	Travessa lateral espelho/Travesaño lateral espejo	599x50x15	01
12	Travessa superior espelho/Travesaño superior espejo	568x50x15	01
12	Travessa inferior espelho/Travesaño inferior espejo	568x50x15	01
14	Lateral superior esquerda/Lateral superior izquierda	600x100x15	01
15	Lateral superior direita/Lateral superior derecha	600x100x15	01
16	Prateleira/Repisa	185x100x15	03
17	Painel espelho/Panel espejo	585x600x15	01
18	Lateral gaveta/Lateral cajón	335x127x15	02
19	Traseiro gaveta/Revés cajón	344x127x15	03
20	Frente gaveta menor/Frente cajón menor	200x395x15	03
21	Fundo gaveta menor/Fondo cajón menor	358x344x3	03
22	Divisão interna gaveta/Divisoria interna cajón	335x60x15	01
23	Fundo gaveta maior/Fondo cajón mayor	358x743x3	01
24	Frente gaveta maior/Frente cajón mayor	100x772x15	01
25	Lateral gaveta/Lateral cajón	335x77x15	02
26	Traseiro gaveta/Revés cajón	743x77x15	01

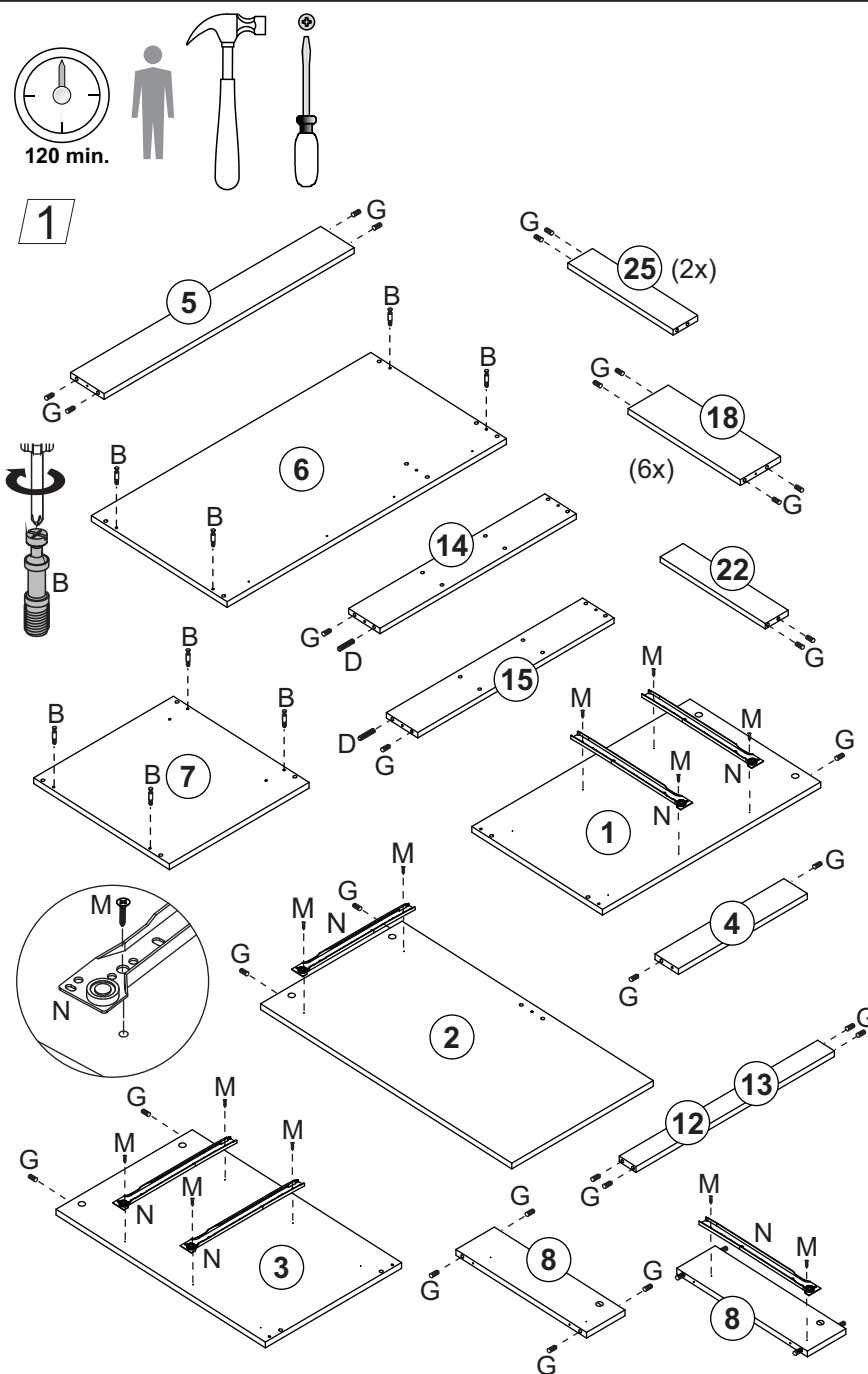



ATENÇÃO!!!

Em caso de uso de parafusadeira comece com um torque bem leve e vá aumentando até achar o ideal. Aperte somente até travar. Torque excessivo pode espanar o parafuso e danificar a peça comprometendo sua correta fixação.

ATENCIÓN!!!

En caso de utilizar un destornillador, comience con un torque muy ligero y vaya aumentando hasta encontrar el ideal. Presione solo hasta que se detener. Torsión excesivo puede desempolvar el tornillo y dañar la pieza, comprometiendo su correcta fijación.

2

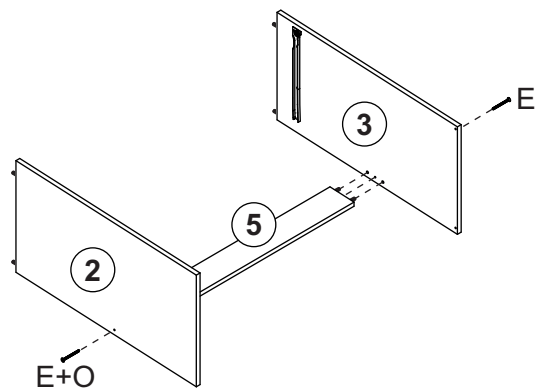

3

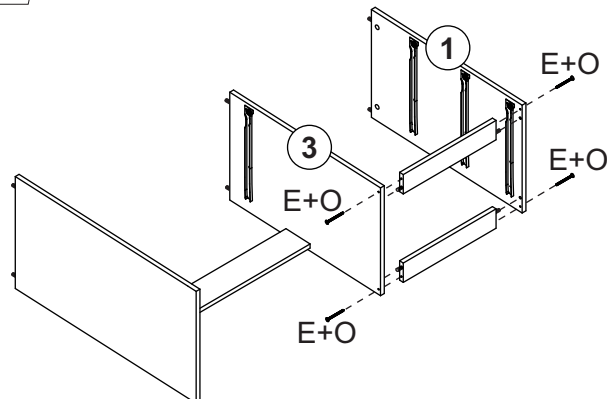

4

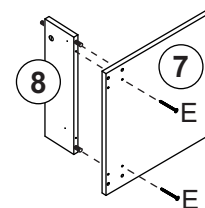

5

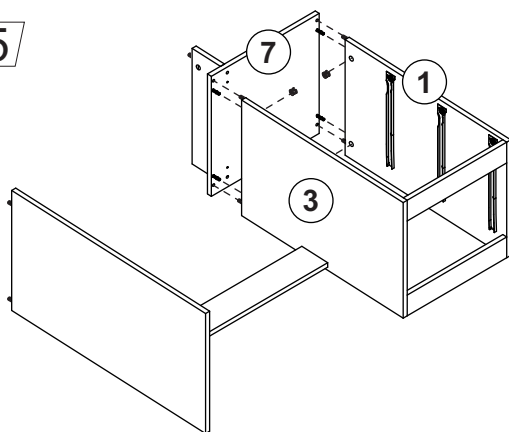

6

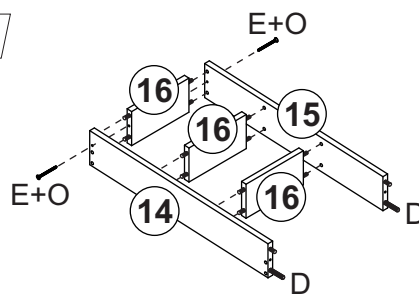

7

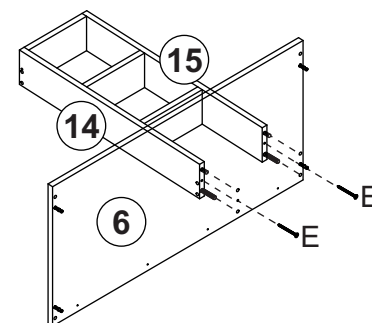

8

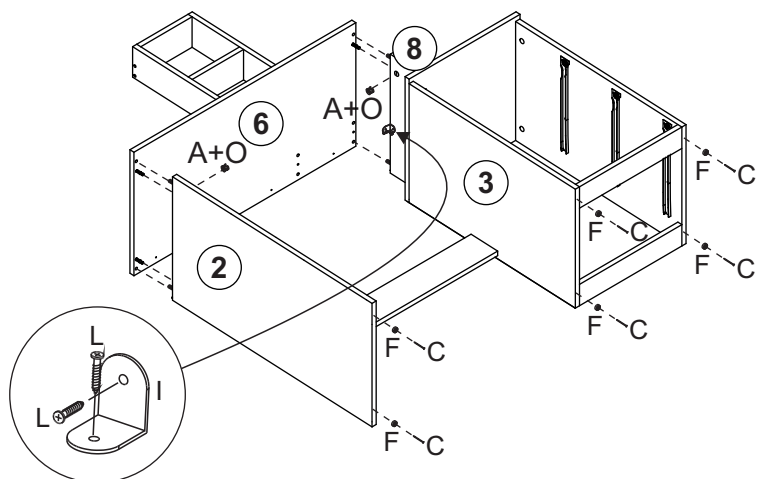

9

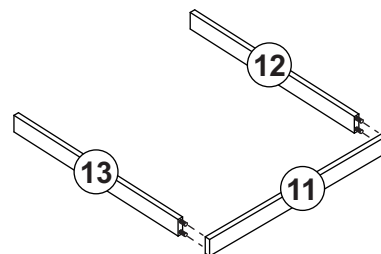

10

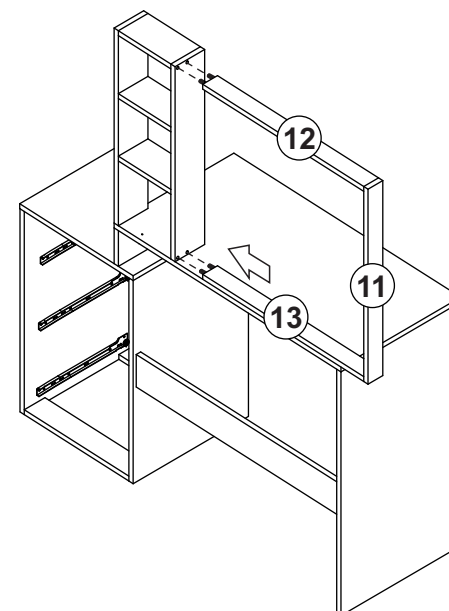

11

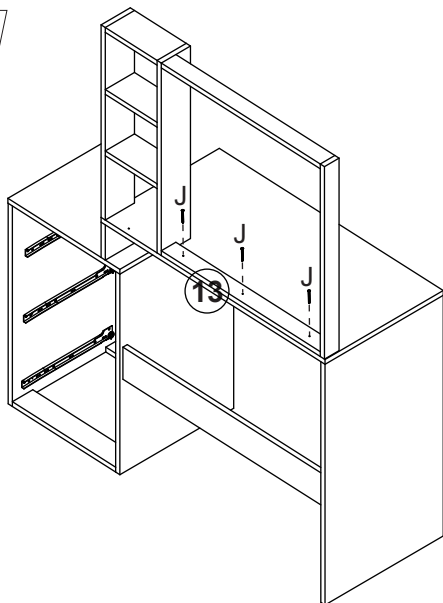

12

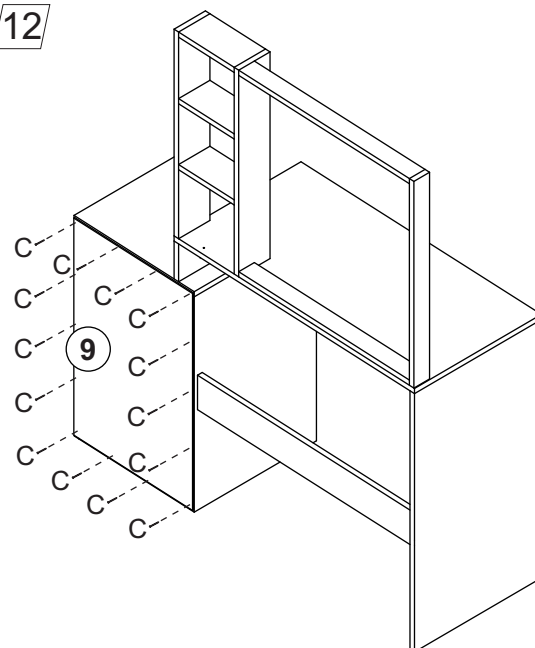

13

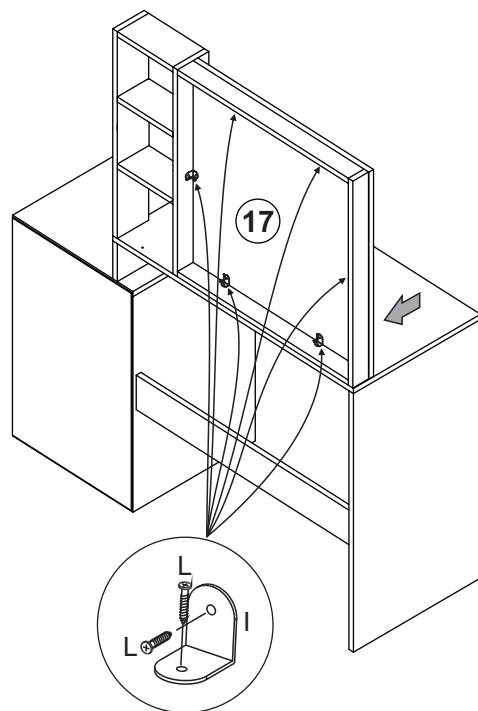

Peso suportado
Peso suportado

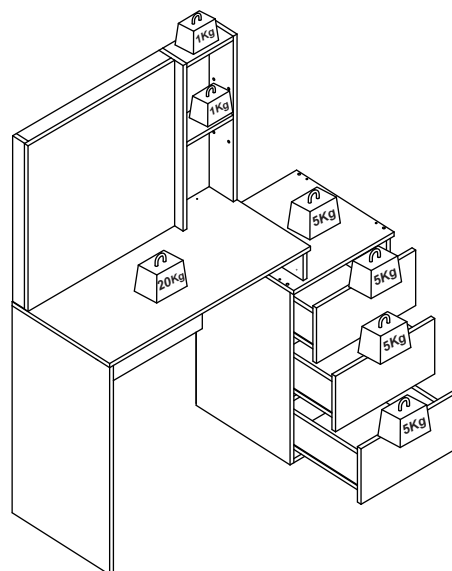

14 (3x)

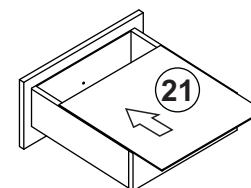
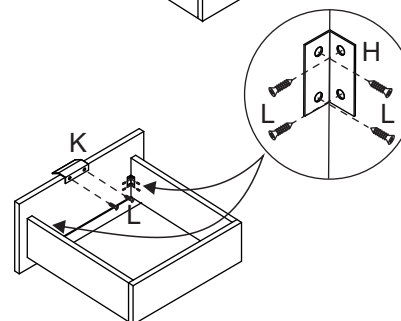
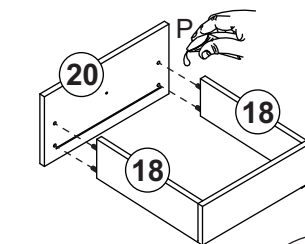
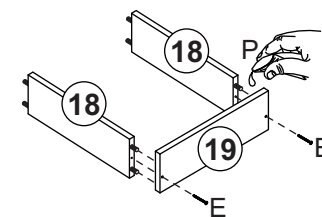

Alinhar a correção na base
da lateral da gaveta
Alinear la corredera en la
base del lateral del cajón

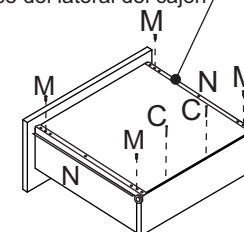

15

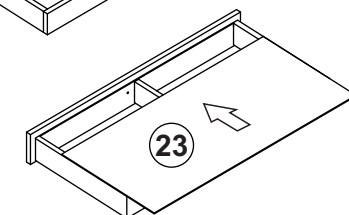
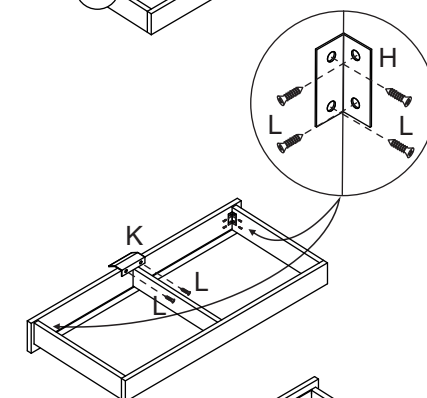
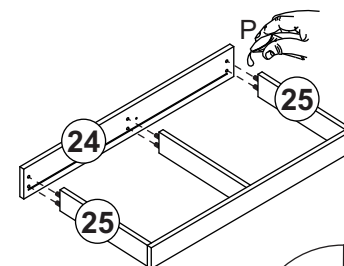
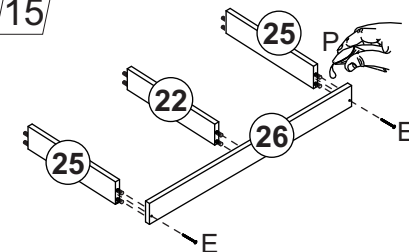

Alinhar a correção na base
da lateral da gaveta
Alinear la corredera en la
base del lateral del cajón

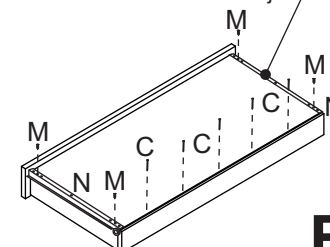

B11