

Nº	CÓDIGO	DESCRIÇÃO / DIMENSÃO (mm)	MATERIAL / ACABAMENTO	QUANTIDADE
CODE	CÓDIGO	DESCRIPTION / DIMENSION (mm)	Raw Material / FINISH	QUANTITY
CÓDIGO	CÓDIGO	DESCRIPCIÓN / DIMENSIÓN (mm)	MATERIA PRIMA / TERMINACIÓN	CANTIDAD
CORPO / CARCASS / CAJA				
01-	3000001081	LATERAL DIR SUP I3-105 2011 BRA / 965 X 257 X 15 MM	AÇO/STEEL/ACERO - BRANCO/WHITE/BLANCO	1
02-	3000001082	LATERAL ESQ SUP I3-105 2011 BRA / 965 X 257 X 15 MM	AÇO/STEEL/ACERO - BRANCO/WHITE/BLANCO	1
03-	3000000981	COSTA IP3-105 BRA / 1047 X 402 X 15 MM	AÇO/STEEL/ACERO - BRANCO/WHITE/BLANCO	1
04-	3000001073	COSTA CENTRAL I3-105 BRA / 1047 X 563 X 15 MM	AÇO/STEEL/ACERO - BRANCO/WHITE/BLANCO	1
05-	3000000365	COSTA IG3GD-105TL BRA / 1047 X 687 X 15 MM	AÇO/STEEL/ACERO - BRANCO/WHITE/BLANCO	1
06-	3000000987	TETO IP3-105 BRA / 1048 X 255 X 20 MM	AÇO/STEEL/ACERO - BRANCO/WHITE/BLANCO	1
07-	3000000989	FUNDO IP3-105 BRA / 1048 X 255 X 20 MM	AÇO/STEEL/ACERO - BRANCO/WHITE/BLANCO	1
08-	3000004339	PRATELEIRA I3-105 ESC BRA / 1048 X 255 X 20 MM	AÇO/STEEL/ACERO - BRANCO/WHITE/BLANCO	1
09-	3000000984	COLUNA PEQUENA BRA / 372 X 30 X 11 MM	AÇO/STEEL/ACERO - BRANCO/WHITE/BLANCO	1
10-	3000000386	LATERAL DIR IG3GD-105TL BRA / 690 X 400 X 15 MM	AÇO/STEEL/ACERO - BRANCO/WHITE/BLANCO	1
11-	3000001061	LATERAL ESQ IG3GI-105 BRA / 690 X 400 X 15 MM	AÇO/STEEL/ACERO - BRANCO/WHITE/BLANCO	1
12-	3000010730	FUNDO F/PE IG3G3-105 BRA / 1050 X 400 X 20 MM	AÇO/STEEL/ACERO - BRANCO/WHITE/BLANCO	1
13-	3000001056	FUNDO IG2-70 BRA / 700 X 400 X 20 MM	AÇO/STEEL/ACERO - BRANCO/WHITE/BLANCO	1
14-	3000001336	FUNDO GAV IG-35TL ANITA BRA / 417 X 292 X 15 MM	AÇO/STEEL/ACERO - BRANCO/WHITE/BLANCO	1
15-	3000001044	CALHA SUPERIOR IG3GI-105 BRA / 1042 X 23 X 20 MM	AÇO/STEEL/ACERO - BRANCO/WHITE/BLANCO	1
16-	30000005963	CALHA INFERIOR IG1-35 BRA / 342 X 24 X 23 MM	AÇO/STEEL/ACERO - BRANCO/WHITE/BLANCO	1
17-	30000005739	COLUNA IG3G1-105 BRA / 660 X 30 X 11 MM	AÇO/STEEL/ACERO - BRANCO/WHITE/BLANCO	1
18-	1000001321	KIT GD PLASTICA TL BR 335 x 90 / 335 X 90 MM	PLÁSTICO/PLASTIC/PLÁSTICO - BRANCO/WHITE/BLANCO	1
PORTAS / DOORS / PUERTAS				
19-	3000002621	PORTA SS ALTA-35 ANITA BRA / 685 X 347 X 20 MM	AÇO/STEEL/ACERO - BRANCO/WHITE/BLANCO	1
20-	3000002623	PORTA SS ALTA-35 ANITA BRA / 685 X 347 X 20 MM	AÇO/STEEL/ACERO - BRANCO/WHITE/BLANCO	1
21-	3000002634	PORTA SS MED-35 ANITA BRA / 547 X 347 X 20 MM	AÇO/STEEL/ACERO - BRANCO/WHITE/BLANCO	1
22-	3000002593	PORTA SS PEQ-35 ANITA BRA / 397 X 347 X 20 MM	AÇO/STEEL/ACERO - BRANCO/WHITE/BLANCO	2
	3000002599	PORTA SS PEQ-35 ANITA PTO / 397 X 347 X 20 MM	AÇO/STEEL/ACERO - PRETO/BLACK/NEGRO	2
23-	3000002601	PORTA SS PEQ-35 ANITA BRA / 397 X 347 X 20 MM	AÇO/STEEL/ACERO - BRANCO/WHITE/BLANCO	1
	3000002607	PORTA SS PEQ-35 ANITA PTO / 397 X 347 X 20 MM	AÇO/STEEL/ACERO - PRETO/BLACK/NEGRO	1
FRENTE GAVETA / DRAWER FRONT / FRENTE DE CAJÓN				
24-	3000002591	FRENTE GAV-35 IG3GDTL ANITA BRA / 348 X 130 X 20 MM	AÇO/STEEL/ACERO - BRANCO/WHITE/BLANCO	1
	3000004370	FRENTE GAV-35 IG3GDTL ANITA PTO / 348 X 130 X 20 MM	AÇO/STEEL/ACERO - PRETO/BLACK/NEGRO	1
TAMPO - PIA / COUNTERTOP - SINK / CUBIERTA - LAVAPLATS				
25-	3100013095	TAMPO I3G1-105 ROSE PP-389 / 1051 X 450 X 15 MM	MADEIRA/WOOD/MADEIRA - GRANITO PRETO/BLACK GRANITE/GRANITO NEGRO	1

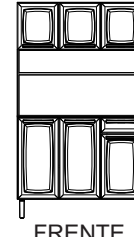

Montagem
Mounting
Montaje

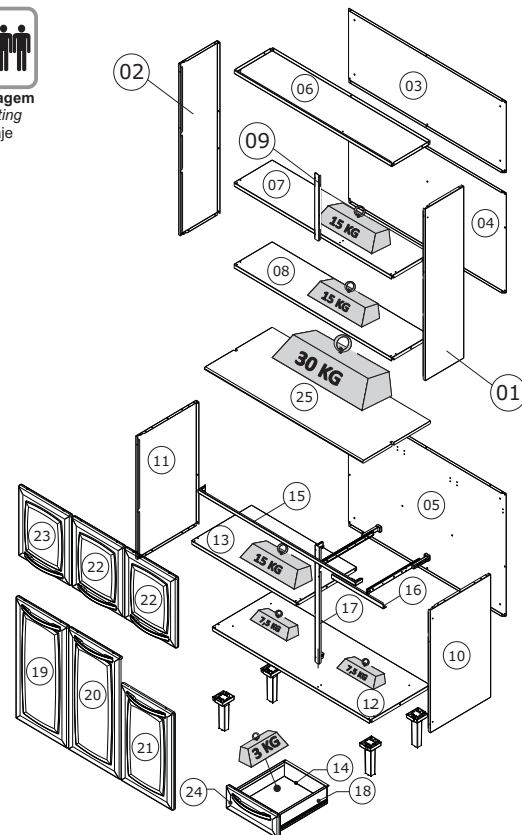

FRENTE

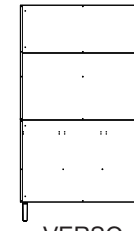

VERSO

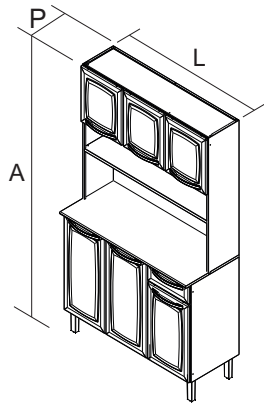

KIT ROSE 6 PTS 1 GV
PRODUTO MONTADO:
A: 1820 L: 1050 P: 455 MM

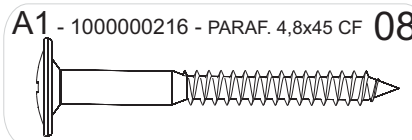

A1 - 1000000216 - PARAF. 4,8x45 CF 08

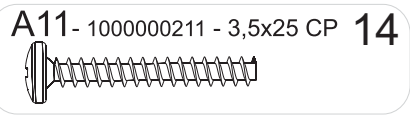

A11 - 1000000211 - 3,5x25 CP 14

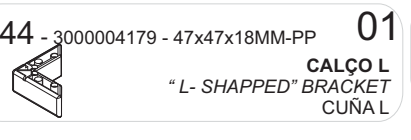

F44 - 3000004179 - 47x47x18MM-PP 01
CALÇO L
"L- SHAPPED" BRACKET
CUÑA L

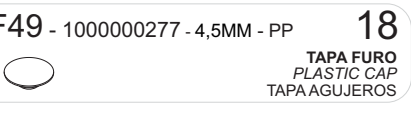

F49 - 1000000277 - 4,5MM - PP 18
TAPA FURO
PLASTIC CAP
TAPA AGUJEROS



F144 - 1000000179 - 255x25x20 MM 07
PUXADOR - ABS
ABS HANDLE
TIRADOR - ABS



A3 - 1000000202 - PARAF. 3/16x1/4 FL 26

*FERRAMENTAS NÃO FORNECIDAS
*Tools Needed (not supplied)
*Herramientas no suministradas

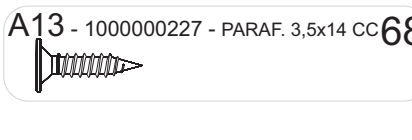

A13 - 1000000227 - PARAF. 3,5x14 CC 68

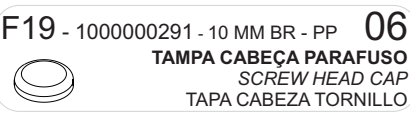

F19 - 1000000291 - 10 MM BR - PP 06
TAMPA CABEÇA PARAFUSO
SCREW HEAD CAP
TAPA CABEZA TORNILLO

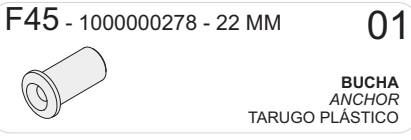

F45 - 1000000278 - 22 MM 01
BUCHA
ANCHOR
TARUGO PLÁSTICO



F51 - 1000000266 - 6,5MM BR - PP 02
TAPA FURO - PLÁSTICA
PLASTIC CAP
TAPA AGUJEROS - PLÁSTICA

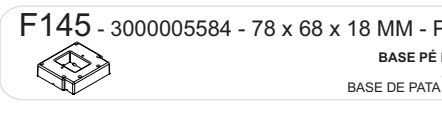

F145 - 3000005584 - 78 x 68 x 18 MM - PP 04
BASE PÉ PLÁSTICA
LEG BASE
BASE DE PATA PLÁSTICA

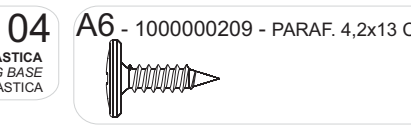

A6 - 1000000209 - PARAF. 4,2x13 CF 05

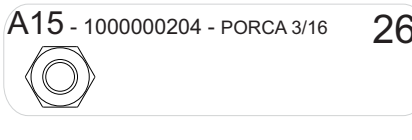

A15 - 1000000204 - PORCA 3/16 26

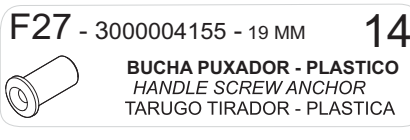

F27 - 3000004155 - 19 MM 14
BUCHA PUXADOR - PLÁSTICO
HANDLE SCREW ANCHOR
TARUGO TIRADOR - PLÁSTICA



F46 - 3000004178 - 45x28x18MM - NYLON 13
APOIO DOBRADIÇA LATERAL
SIDE PANEL HINGE PLASTIC SUPPORT
APOYO BISAGRA LATERAL



F47 - 3000004163 - 6 MM 16
BATOQUE PORTA - PVC
PVC STOPPER
TOPE PARA PUERTA - PVC



F53 - 1000000329 - 26 MM 12
DOBRADIÇA
FRAME WING
BISAGRA



F152 - 1000003508 - 350 x 26 x 10MM 01
PAR CORREDIÇA TELESCÓPICA
PAIR TELESCOPIC RUNNER
RIEL TELESCÓPICA DE PAR



A8 - 1000000233 - PARAF. 4,2x9,5 CP 45



A19 - 1000000203 - PARAF. 4,0x20 MM MF 01

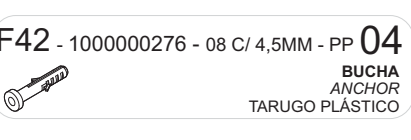

F42 - 1000000276 - 08 C/ 4,5MM - PP 04
BUCHA
ANCHOR
TARUGO PLÁSTICO

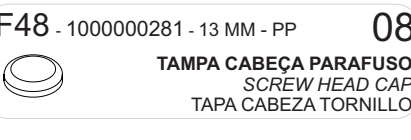

F48 - 1000000281 - 13 MM - PP 08
TAMPA CABEÇA PARAFUSO
SCREW HEAD CAP
TAPA CABEZA TORNILLO

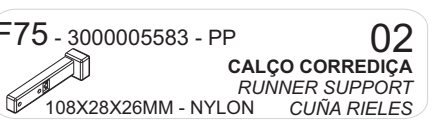

F75 - 3000005583 - PP 02
CALÇO CORREDIÇA
RUNNER SUPPORT
CUÑA RIELES

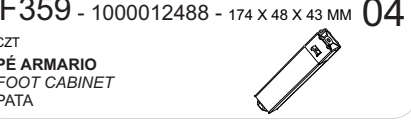

F359 - 1000012488 - 174 X 48 X 43 MM 04
CZT
PÉ ARMARIO
FOOT CABINET
PATA

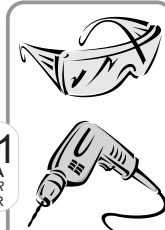

0800 032 6111
www.minhatatiaia.com.br

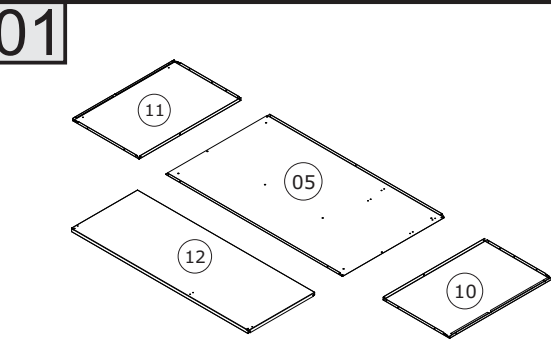
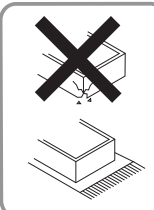

01

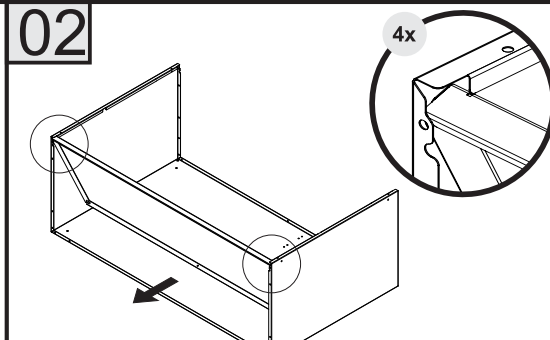

02

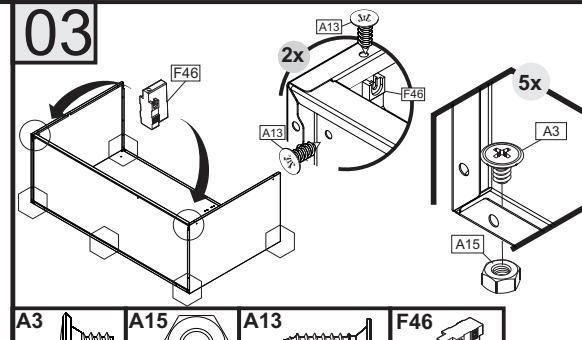

03

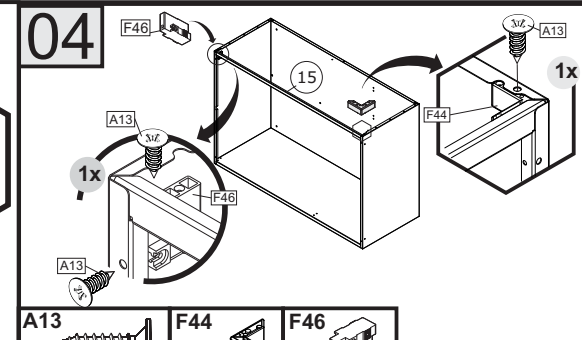

04

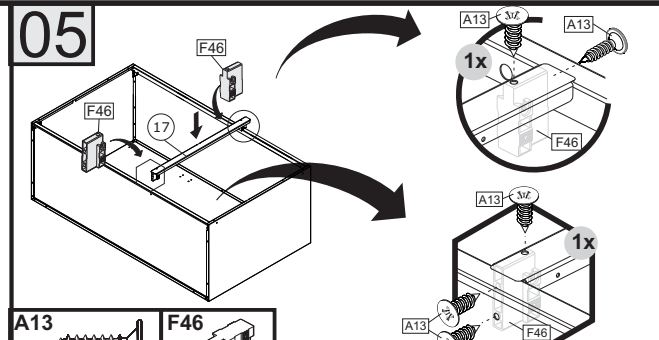

05

* Utilize a caixa de papelão para forrar o chão

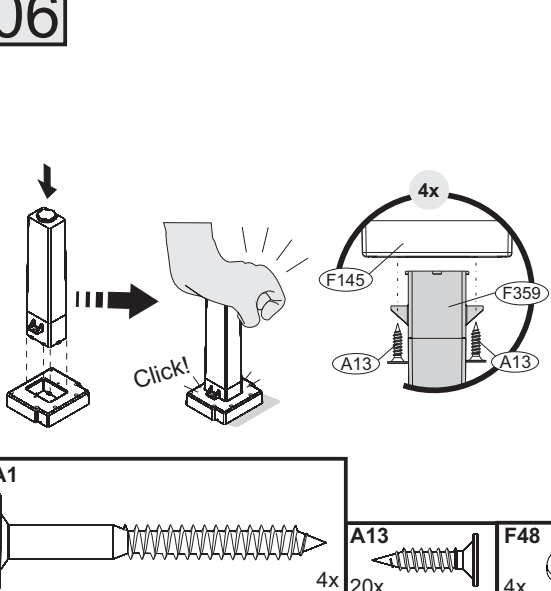

06

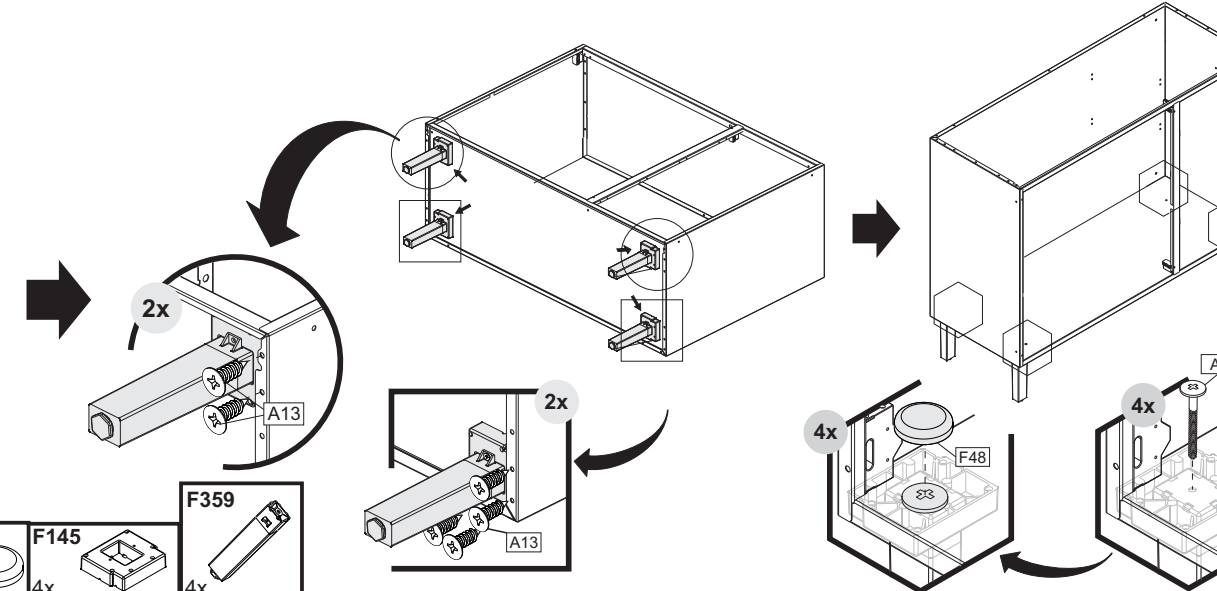

07

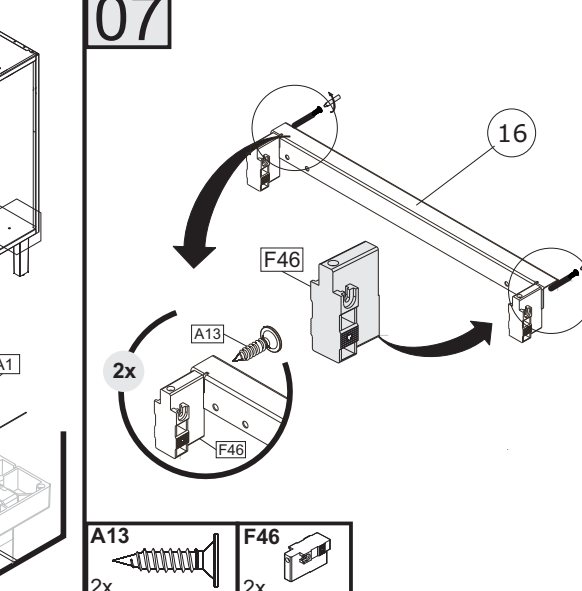

08

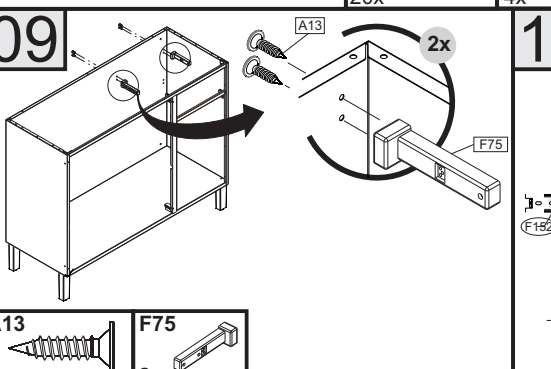

09

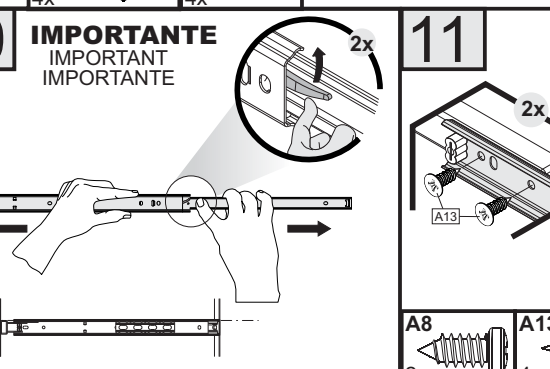

10

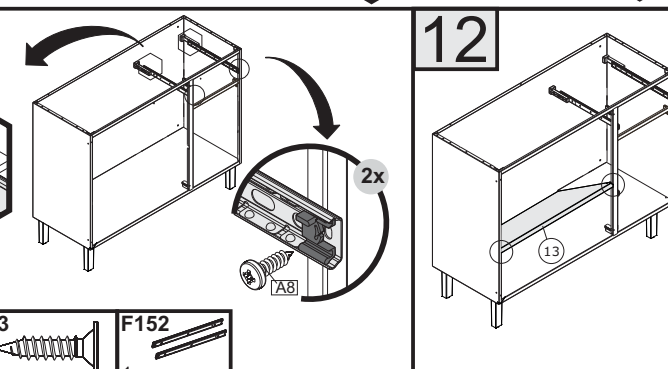

11

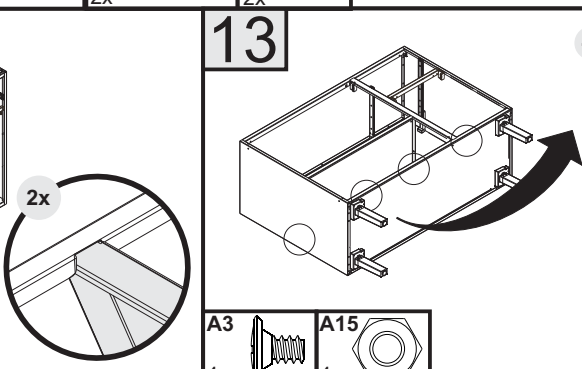

12

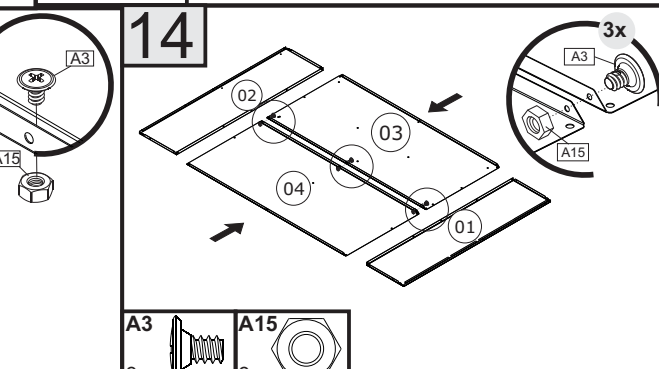

13

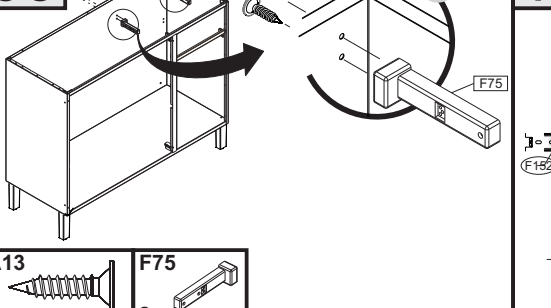

14

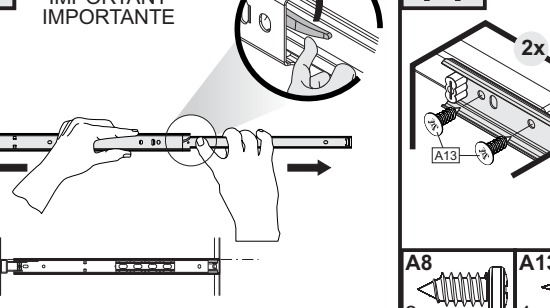

15

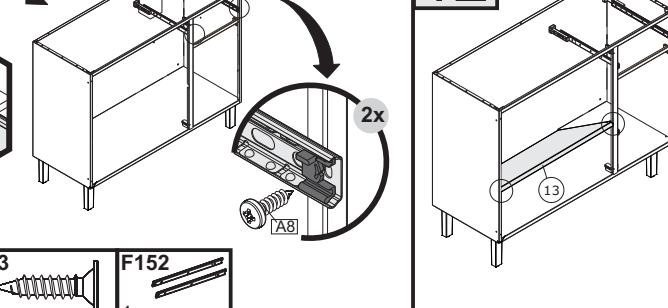

16

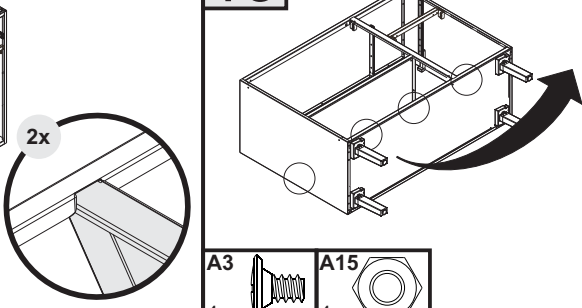

17

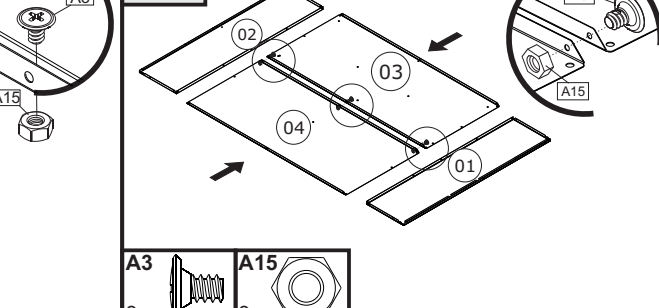

18

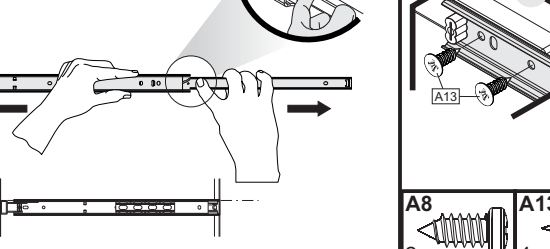

19

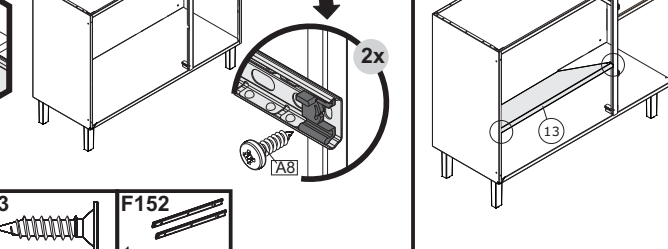

20

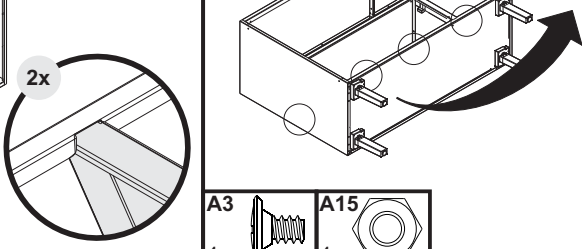

21

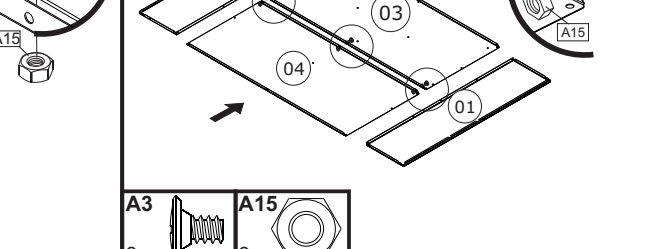

22

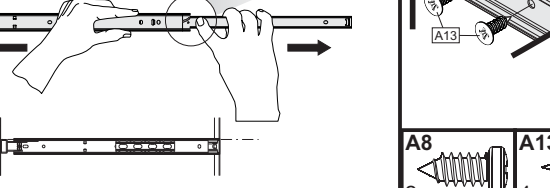

23

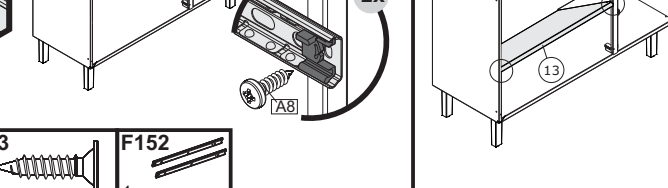

24

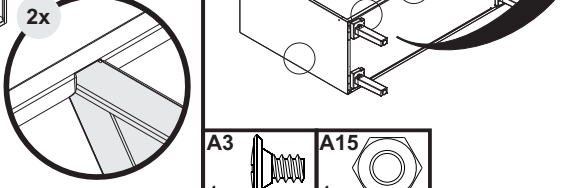

25

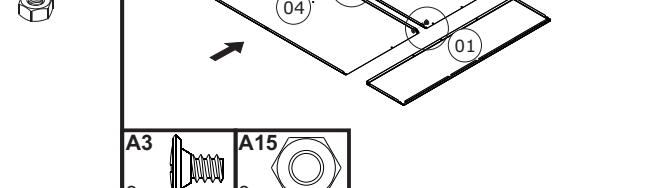

26

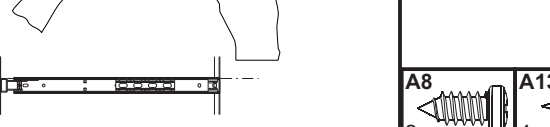

27



28

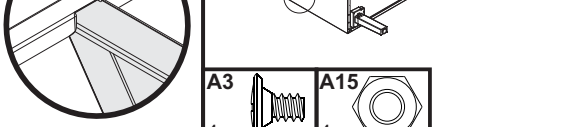

29

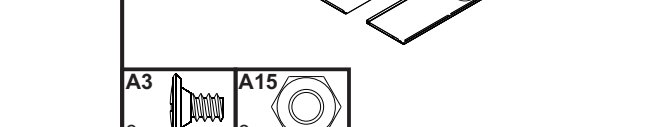

30

