

## IG3G4GD-120 PREMIUM - Spare Parts Summary

## MANUAL DE ASISTENCIA TÉCNICA IG3G4GD-120 PREMIUM

## Gabinete 2 Portas e 4 Gavetas

- Este manual deve ser guardado para futura consulta, caso necessário.
- This manual should be retained for future reference, if necessary
- Este manual debe guardarse para futuras referencias, si es necesario.



+55 0800 032 6111  
www.cozinhasitaitaia.com.br

Nº	CÓDIGO CODE CÓDIGO	DESCRIÇÃO / DIMENSÃO (mm) DESCRIPTION / DIMENSION (mm) DESCRIPCIÓN / DIMENSIÓN (mm)	MATERIAL / ACABAMENTO Raw Material / FINISH MATERIA PRIMA / TERMINACIÓN	QUANTIDADE QUANTITY CANTIDAD
<b>CORPO / CARCASS / CAJA</b>				
01-	3000005307	LATERAL DIR IG3G4GD-120 BRA / 690 x 450 x 15 MM	AÇO/STEEL/ACERO - BRANCO/WHITE/BLANCO	1
02-	3000000891	LATERAL ESQ IG3A-120 BRA / 690 x 450 x 15 MM	AÇO/STEEL/ACERO - BRANCO/WHITE/BLANCO	1
03-	3000005322	COSTA IG3G4GD-120 BRA / 1197 X 690 X 15 MM	AÇO/STEEL/ACERO - BRANCO/WHITE/BLANCO	1
	3000005316	COSTA IG3G4GD-120 PIA BRA / 1197 X 690 X 15 MM	AÇO/STEEL/ACERO - BRANCO/WHITE/BLANCO	1
04-	3000000383	FUNDO IG3-120 C/CALHA REF BRA /1198 X 448 X 20 MM	AÇO/STEEL/ACERO - BRANCO/WHITE/BLANCO	1
05-	3000000435	FUNDO IG2-80 BRA / 798 X 448 X 20 MM	AÇO/STEEL/ACERO - BRANCO/WHITE/BLANCO	1
06-	3000000883	CALHA SUPERIOR IG3A-120 BRA / 1192 X 23,5 X 23 MM	AÇO/STEEL/ACERO - BRANCO/WHITE/BLANCO	1
07-	3000000562	COLUNA IG3G4-120TL BRA / 660 X 30 X 30 MM	AÇO/STEEL/ACERO - BRANCO/WHITE/BLANCO	1
08-	1000005748	KIT GD PLASTICA TL BR 390 X 90 ACO / 390 X 90 X 19 MM	PLÁSTICO/PLASTIC/PLÁSTICO - BRANCO/WHITE/BLANCO	4
09-	1000006001	DIVISOR GAV. 40 385 X 320 X 60MM ACO/MAD / 385 X 320 X 6 MM	PLÁSTICO/PLASTIC/PLÁSTICO - BRANCO/WHITE/BLANCO	1
10-	3000005263	FUNDO GAV IG-40TL ITANEW BRA / 467 X 342 X 15 MM	AÇO/STEEL/ACERO - BRANCO/WHITE/BLANCO	4
11-	3000000711	MAO-FRANCESA BRA / 442 X 40 X 55 MM	AÇO/STEEL/ACERO - BRANCO/WHITE/BLANCO	2
12-	3000004161	TAMPA PLAST FURO SAIDA DE AGUA	PLÁSTICO/PLASTIC/PLÁSTICO - BRANCO/WHITE/BLANCO	1
<b>PORTAS / DOORS / PUERTAS</b>				
13-	3000002909	PORTA SS ALTA-40 PREMIUM BRA / 685 X 397 X 20 MM	AÇO/STEEL/ACERO - BRANCO/WHITE/BLANCO	1
14-	3000002911	PORTA SS ALTA-40 PREMIUM BRA / 685 X 397 X 20 MM	AÇO/STEEL/ACERO - BRANCO/WHITE/BLANCO	1
<b>FRENTE GAVETA / DRAWER FRONT / FRENTE DE CAJÓN</b>				
15-	3000000499	FRENTE GAV-40 IGG4 TL PREMIUM BRA / 397 X 168 X 20 MM	AÇO/STEEL/ACERO - BRANCO/WHITE/BLANCO	4
	3000000500	FRENTE GAV-40 IGG4 TL PREMIUM LRJ / 397 X 168 X 20 MM	AÇO/STEEL/ACERO - LARANJA/ORANGE/NARANJA	4
	3000000502	FRENTE GAV-40 IGG4 TL PREMIUM PTO / 397 X 168 X 20 MM	AÇO/STEEL/ACERO - PRETO/BLACK/NEGRO	4
	3000000501	FRENTE GAV-40 IGG4 TL PREMIUM VRD / 397 X 168 X 20 MM	AÇO/STEEL/ACERO - VERDE/GREEN/VERDE	4
<b>TAMPO / COUNTERTOP / CUBIERTA</b>				
16-	3100000139	TAMPO IG3-120 ACO F-248 / 1200X491X25 MM	MADEIRA/WOOD/MADEIRA - MARMORE BRANCO/WHITE MARBLE/MARMOL BLANCO	1
	1000000261	PIA INOX 1202X500MM FRT ARR 10.01.03370	INOX/STAINLESS STEEL/INOX	1
17-	3100000141	REGUA GAB IG3-120 ACO F-248 / 1200X70X15 MM	MADEIRA/WOOD/MADEIRA - MARMORE BRANCO/WHITE MARBLE/MARMOL BLANCO	1

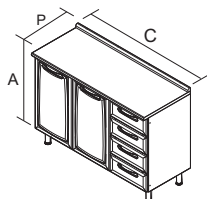

IG3G4GD-120

Produto Montado

C: 1,20 A: 0,88 P: 0,50 M

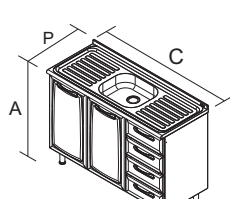

IG3G4GD-120 PIA

Produto Montado

C: 1,20 A: 0,88 P: 0,50 M

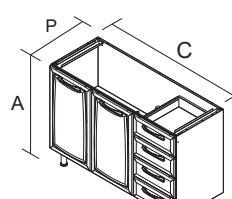

IG3G4GDST-120

Produto Montado

C: 1,20 A: 0,88 P: 0,50 M

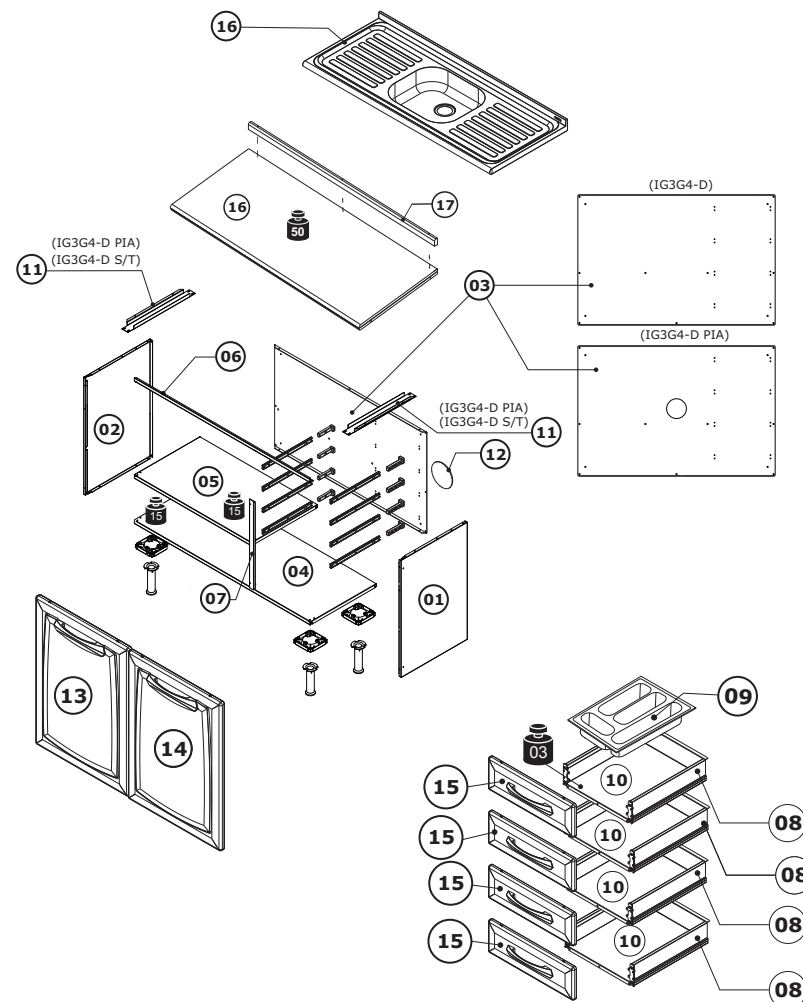

**FERRAGEM PUXADORES**  
HANDLE HARDWARE  
HERRAJE TIRADORES

**A11** - 1000000211 - 3,5x25 CP

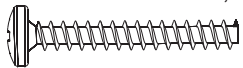

**12**

**F27** - 3000004155 - 19 MM



**12**  
**BUCHA PUXADOR**  
HANDLE SCREW ANCHOR  
TARUGO TIRADOR

**F47** - 3000004163 - 6mm



**20**  
**BATOQUE PORTA - PVC**  
PVC STOPPER  
TOPE PARA PUERTA - PVC

**F148** - 1000000168 - 160 MM



**02**  
**PUXADOR**  
HANDLE  
TIRADOR

**F170** - 1000000170 - 160 MM



**04**  
**PUXADOR**  
HANDLE  
TIRADOR

## MONTAGEM DE FREITE

### ASSEMBLING INSTRUCTIONS-CABINETS FRONT PORTION ARMADO FRONTAL

PORTA 09 e 10 / Door 09,10/ Puerta 09,10

**PUXADOR / MONTAGEM / DIMENSÃO**  
HANDLE / ASSEMBLING / DIMENSION  
TIRADOR / ARMADO / DIMENSIÓN

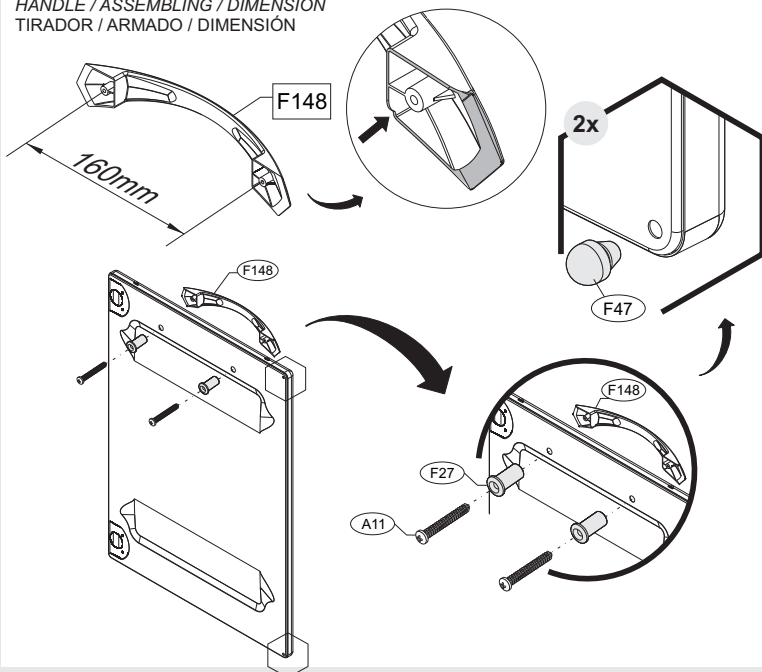

FRENTE GAVETA 11/ Draver Front 11/ Frente cajon 11

**PUXADOR / MONTAGEM / DIMENSÃO**  
HANDLE / ASSEMBLING / DIMENSION  
TIRADOR / ARMADO / DIMENSIÓN

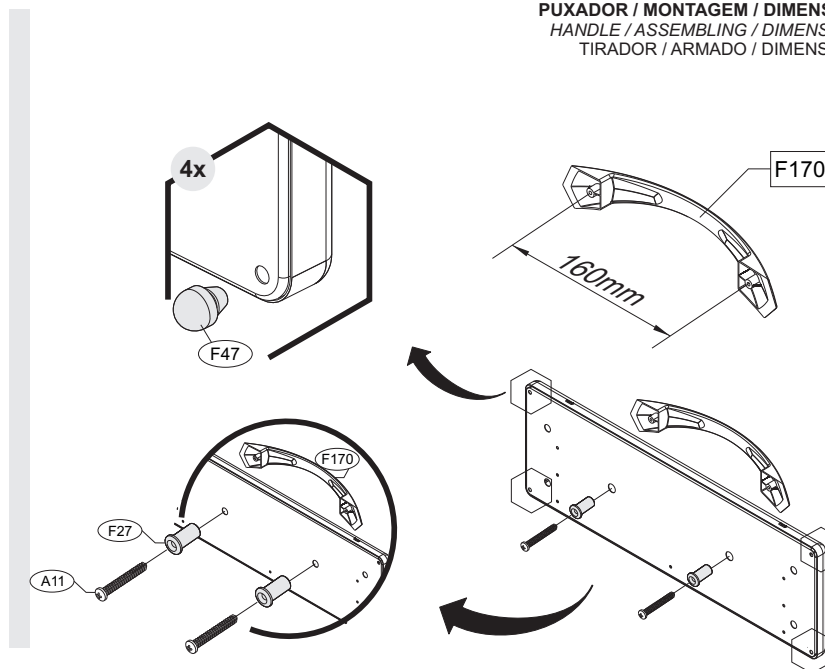

## MONTAGEM DOS PÉS

### LEGS ASSEMBLY

### ARMADO DE LAS PATAS

**A13** - 1000000227 - 3,5x14 CC

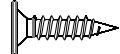

**12**

**F102** - 3000000061



**04**  
**BASE PE PLASTICA**  
LEG BASE  
BASE DE PATA PLASTICA

**F104** - 3000004172



**04**  
**PÉ ARMARIO**  
FOOT CABINET  
PATA

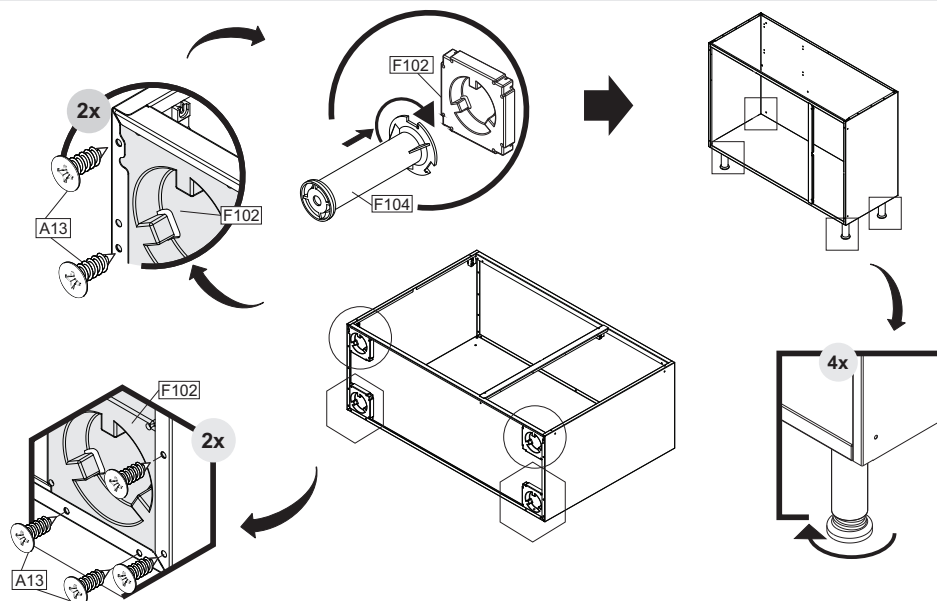

## MONTAGEM DO TAMPO

### COUNTERTOP ASSEMBLING

### ARMADO DE LA CUBIERTA

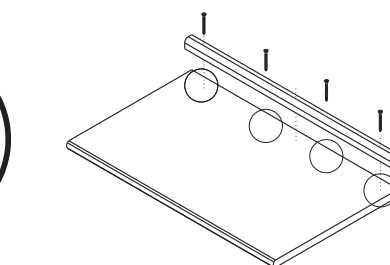
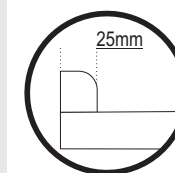
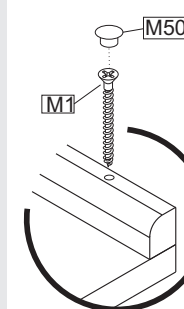

**F50** - 1000000268 - 10 MM BR



**04**

**M1** - 1000001179 - 3,5x40 CC

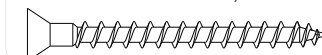

**04**